

CLR PROJECT 03-18-RS-56

"F" STREET (SPRUCE TO PALM)

RECONSTRUCTION

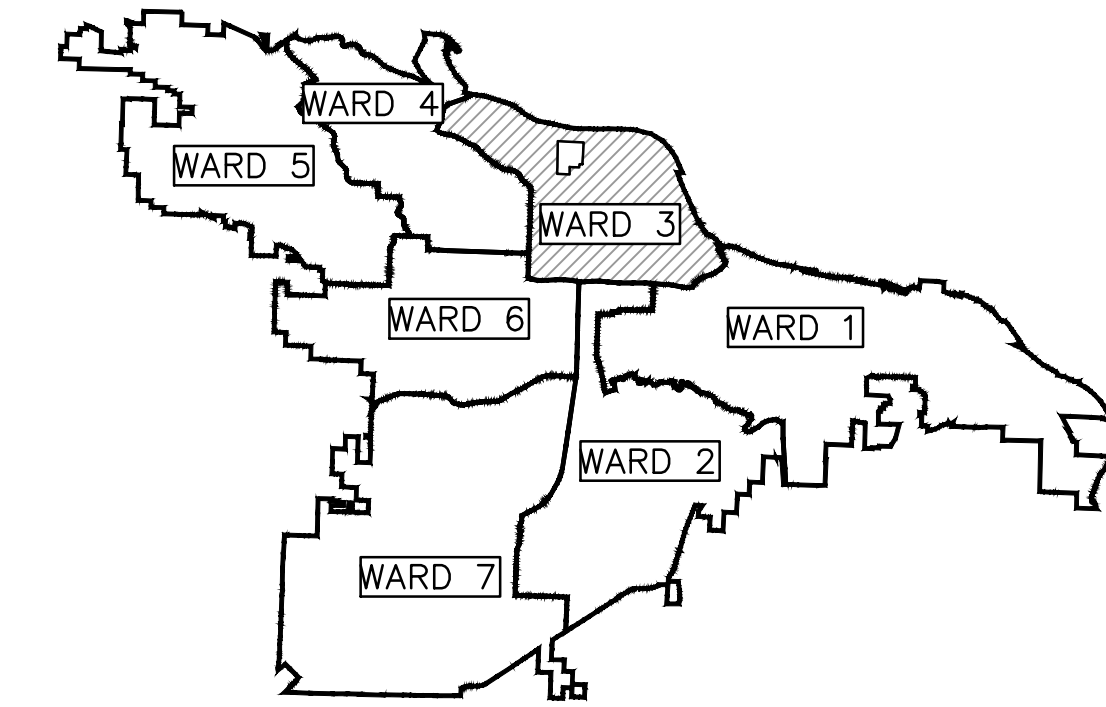

PROJECT LOCATION – WARD 3

REVISIONS	DATE

CITY OF LITTLE ROCK, ARKANSAS

"F" STREET (SPRUCE TO PALM) RECONSTRUCTION

COVER SHEET

60% PRELIMINARY DESIGN

FOR REVIEW ONLY

These documents are for Design Review and not intended for Construction, Bidding or Permit Purposes. They were prepared by, or under the supervision of:

CHRISTIAN VILLARREAL P.E.# 21648 4/8/2024

Date

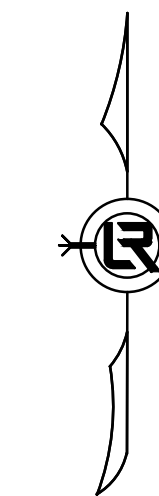
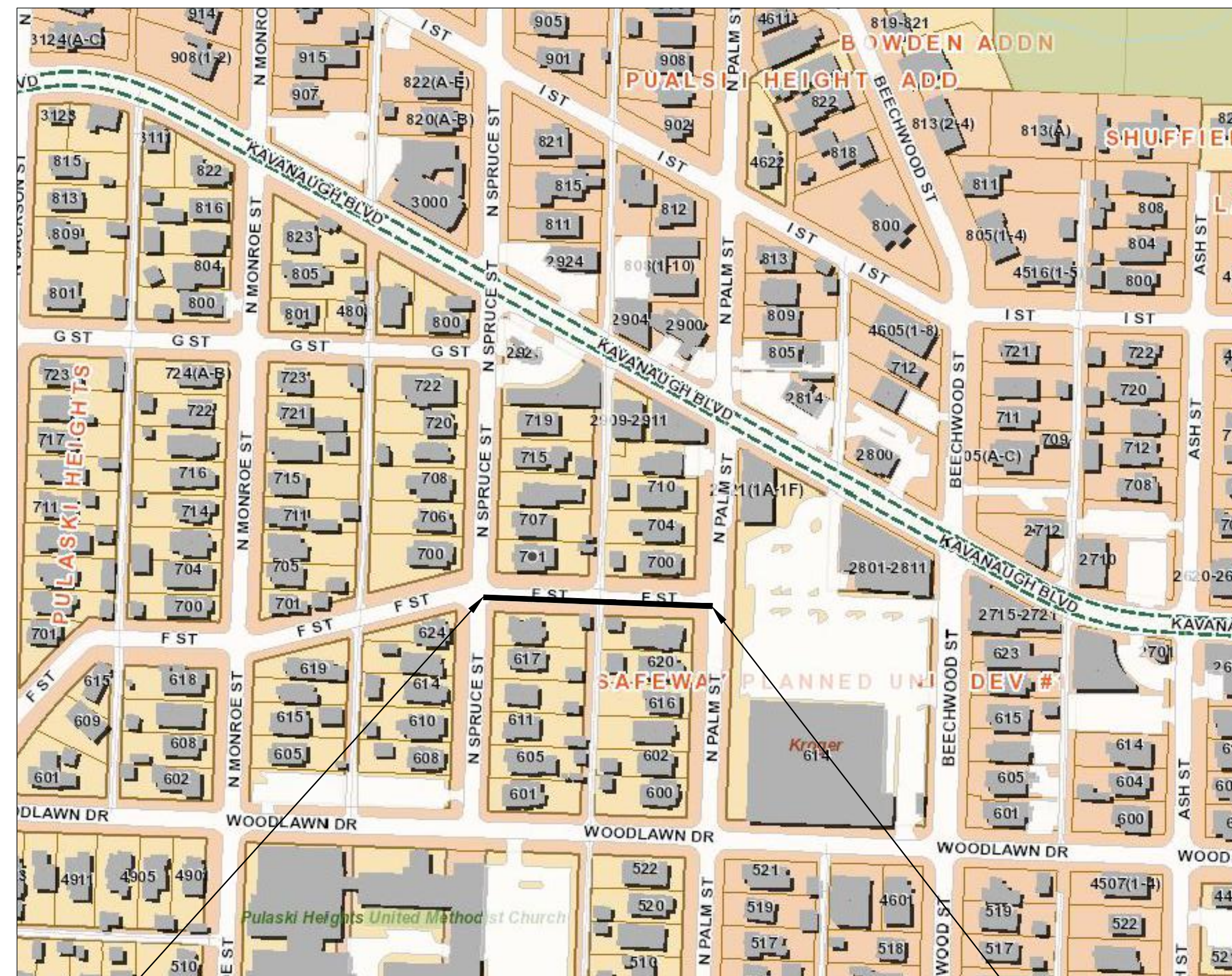

INDEX OF SHEETS:

- C1 COVER SHEET
- C2 GENERAL NOTES, LEGEND AND QUANTITIES
- C3 TYPICAL SECTIONS
- C4 PLAN & PROFILE SHEET
- C5 DRIVEWAY DETAILS
- C6 - C7 CROSS SECTIONS
- C8 PROJECT LAYOUT
- C9 EROSION CONTROL



SURVEYOR:



4701 NORTSHORE DRIVE
NORTH LITTLE ROCK, AR 72118
PHONE: 501-376-3633
WWW.GARVERUSA.COM

ENGINEER OF RECORD:



2020 WEST 3RD STREET, SUITE 504
LITTLE ROCK, AR 72205
PHONE: 501-215-5807 FAX: 501-227-8302
WWW.ICONICCG.COM

BEGIN PROJECT
"F" STREET STREET
CL STA 10+10.37
NORTHING = 154536.1861
EASTING= 1214247.3423

PROJECT
LOCATION

END PROJECT
"F" STREET
CL STA 13+49.10
NORTHING = 154524.3085
EASTING = 1214585.8645

DEPARTMENT OF PUBLIC WORKS
CIVIL ENGINEERING
701 WEST MARKHAM STREET
LITTLE ROCK, ARKANSAS 72201

2023-2025
BOND PROGRAM

DEPARTMENT OF PUBLIC WORKS

CIVIL ENGINEERING

701 W. MARKHAM

LITTLE ROCK, ARKANSAS 72201

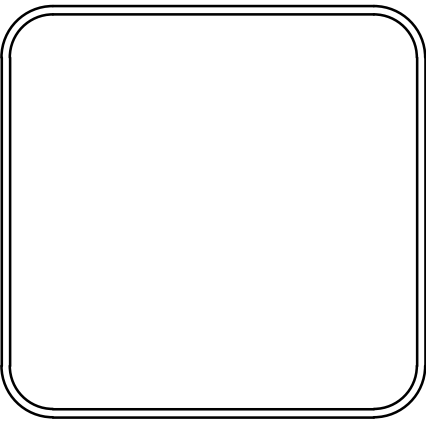

DRAWN BY	CV
DESIGNED	CV
CHECKED	JB
DATE	4/8/2024
SCALE	1" = 20'
PROJECT NO.	CLR # 03-18-ST-56
SHEET NO.	C1

REVISIONS	DATE

DEMO

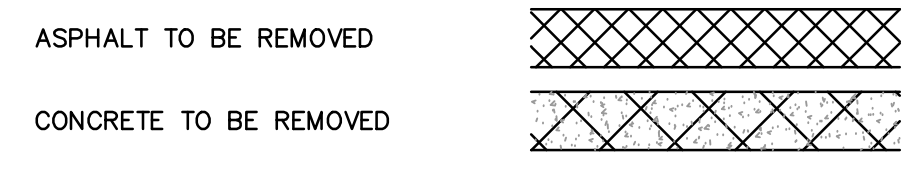

EXISTING

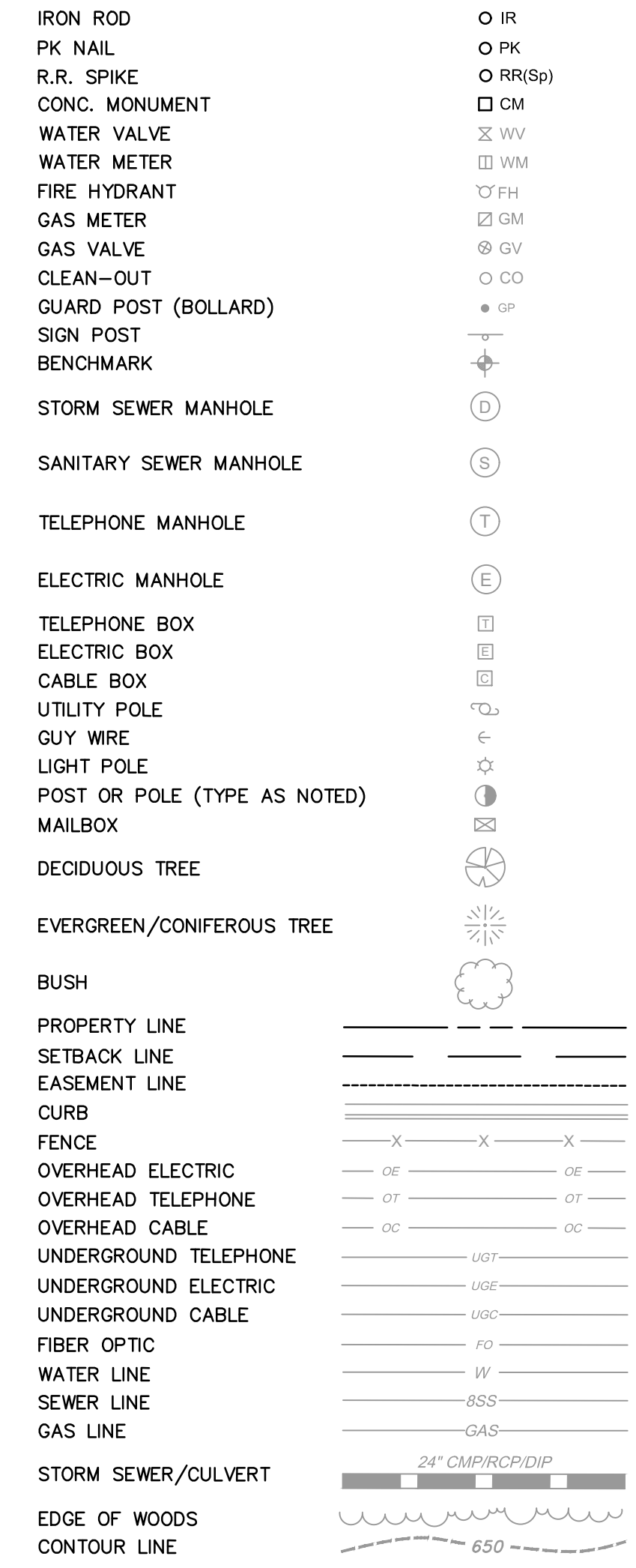

PROPOSED

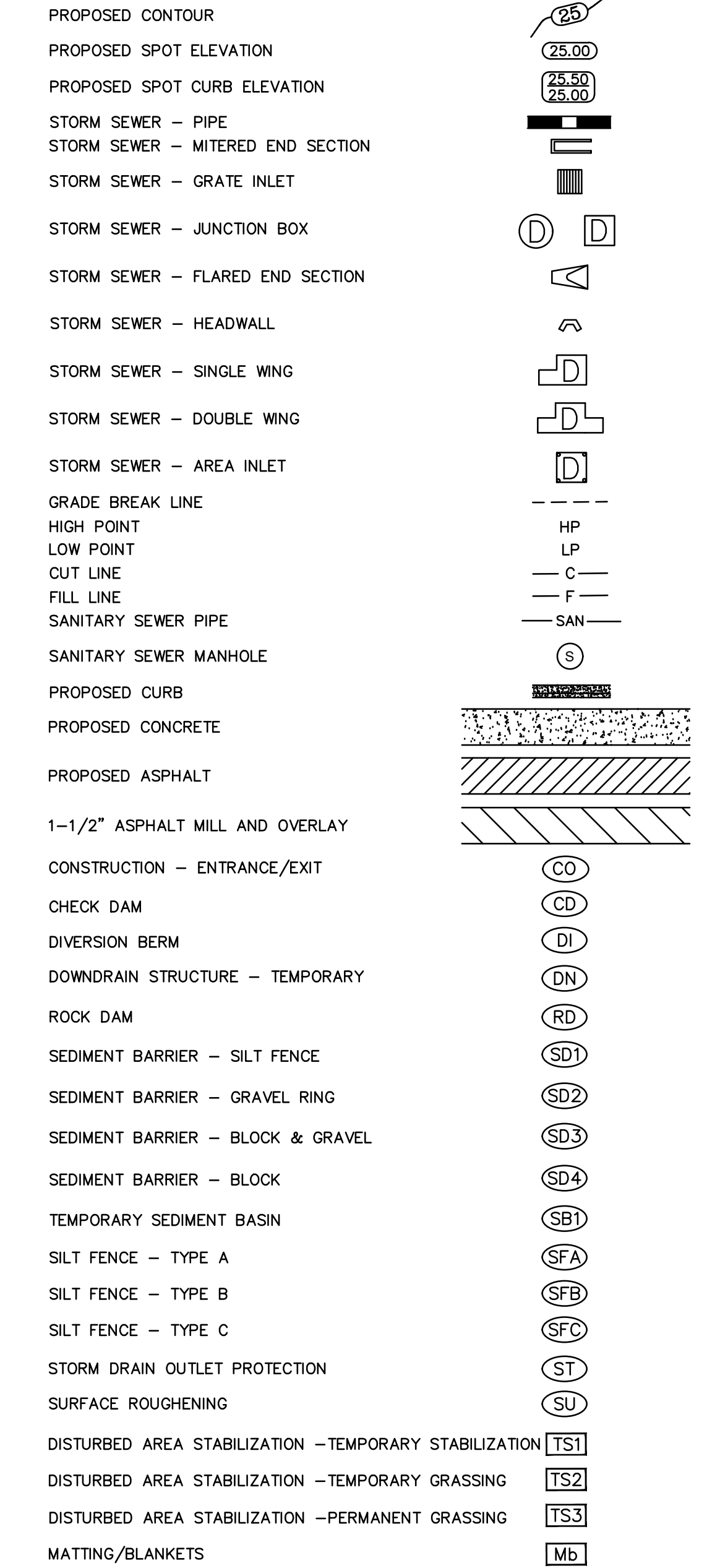

PRICING OF ESTIMATED QUANTITIES		60% PRELIMINARY DESIGN ESTIMATE			
CLR PROJECT 03-18-ST-56					
2024/04/08					
ITEM #	ITEM DESCRIPTION	UNIT	QUANTITY	UNIT COST	TOTAL ITEM COST
2.01	SITE PREPARATION	LS	1	\$ 20,000.00	\$ 20,000.00
2.02	CLEARING AND GRUBBING TREES	LS	1	\$ 2,500.00	\$ 2,500.00
3.01	UNCLASSIFIED EXCAVATION	CY	440	\$ 35.00	\$ 15,400.00
4.01	AGGREGATE BASE COURSE (CLASS 7)	TON	397	\$ 45.00	\$ 17,843.33
5.01	TACK COAT	GAL	59	\$ 7.00	\$ 412.38
6.01	ACHM SURFACE COURSE	TON	105	\$ 150.00	\$ 15,685.08
7.06	CONCRETE DRIVEWAY (6" THICK), STANDARD FINISH	SF	809	\$ 9.58	\$ 7,750.22
7.08	ALLEY TURNOUT (8" THICK)	SF	731	\$ 12.00	\$ 8,772.00
8.03	CONCRETE CURB & GUTTER (CLASS 3)	LF	740	\$ 25.00	\$ 18,500.00
9.04	CONCRETE SIDEWALK, 4" THICK	SF	1397	\$ 12.00	\$ 16,764.00
	JUNCTION BOX (5')	EA	1	\$ 9,100.00	\$ 9,100.00
10.01A	JUNCTION BOX (6')	EA	1	\$ 6,000.00	\$ 6,000.00
10.05	CURB INLET - 5' BOX	EA	5	\$ 7,800.00	\$ 39,000.00
10.07	WING 3' EXTENSION	EA	9	\$ 1,500.00	\$ 13,500.00
13.12C	STORM DRAIN PIPE, 12" (CROSS)	LF	38	\$ 62.50	\$ 2,375.00
13.12S	STORM DRAIN PIPE, 12" (SIDE)	LF	8	\$ 50.00	\$ 400.00
13.18S	STORM DRAIN PIPE, 18" (SIDE)	LF	164	\$ 59.00	\$ 9,676.00
13.24S	STORM DRAIN PIPE, 24" (SIDE)	LF	168	\$ 79.00	\$ 13,272.00
13.36C	STORM DRAIN PIPE, 36" (CROSS)	LF	36	\$ 122.00	\$ 4,392.00
13.36S	STORM DRAIN PIPE, 36" (SIDE)	LF	155	\$ 87.00	\$ 13,485.00
13.61	TIE INTO EXISTING JUNCTION BOX	EA	1	\$ 1,500.00	\$ 1,500.00
13.62	TIE INTO EXISTING CONCRETE PIPE	EA	2	\$ 1,200.00	\$ 2,400.00
14.01	SOLID SODDING (BERMUDA) (INCLUDES 4" TOPSOIL)	SY	158	\$ 12.00	\$ 1,896.00
16.01	MAINTENANCE OF TRAFFIC	LS	1	\$ 10,000.00	\$ 10,000.00
18.50	ACCESS RAMP- TYPE 3	SF	195	\$ 20.00	\$ 3,900.00
19.01	FINAL CLEAN-UP	LS	1	\$ 7,000.00	\$ 7,000.00
24.11	SILT FENCE - TYPE A (SFA)	LF	562	\$ 10.00	\$ 5,620.00
24.02	CHECK DAM (CD)	CY	2	\$ 90.00	\$ 180.00
26.01	TRENCH & EXCAVATION SAFETY	LS	1	\$ 10,000.00	\$ 10,000.00
52.00	PROJECT INFORMATION KIOSK	LS	1	\$ 1,000.00	\$ 1,000.00
SP	SANITARY SEWER MANHOLE ADJUSTMENT	EA	1	\$ 1,200.00	\$ 1,200.00

CITY OF LITTLE ROCK, ARKANSAS
"F" STREET (SPRUCE TO PALM) RECONSTRUCTION
 GENERAL NOTES, LEGEND AND QUANTITIES

DEPARTMENT OF PUBLIC WORKS
 CIVIL ENGINEERING
 701 W. MARKHAM
 LITTLE ROCK, ARKANSAS 72201

60% PRELIMINARY DESIGN

FOR REVIEW ONLY
 These documents are for Design Review and not intended for Construction, Bidding or Permit Purposes. They were prepared by, or under the supervision of:
 CHRISTIAN VILLARREAL P.E.# 21648 4/9/2024
 Date

DRAWN BY
 CV
 DESIGNED
 CV
 CHECKED
 JB
 DATE
 4/9/2024
 SCALE
 N.T.S.
 PROJECT NO.
 CLR # 03-18-ST-56
 SHEET NO.
C2

REVISIONS	DATE

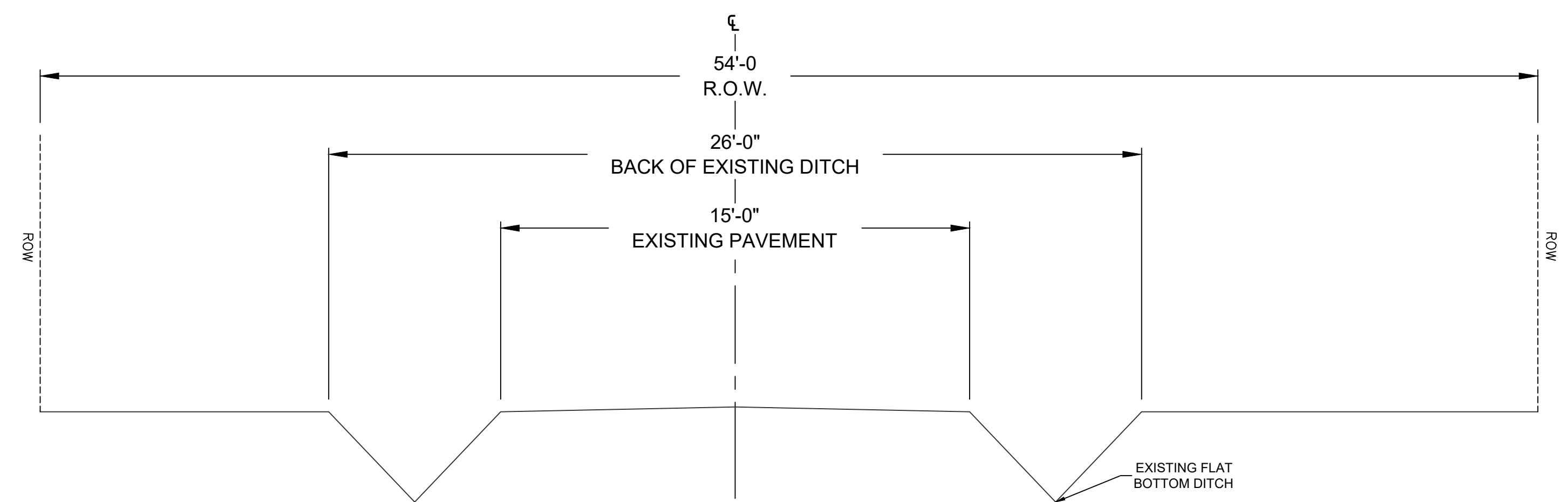

"F" STREET EXISTING TYPICAL SECTION

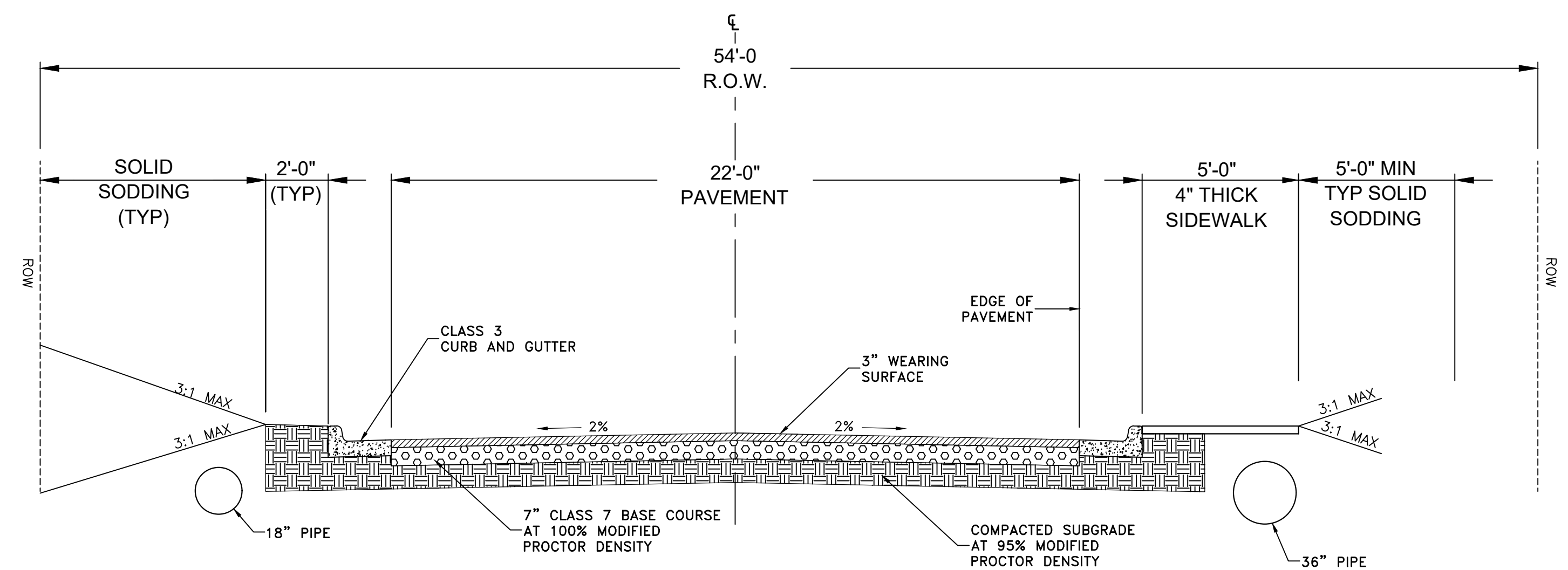

"F" STREET PROPOSED TYPICAL SECTION

STA 10+10.37 TO STA 11+72.19

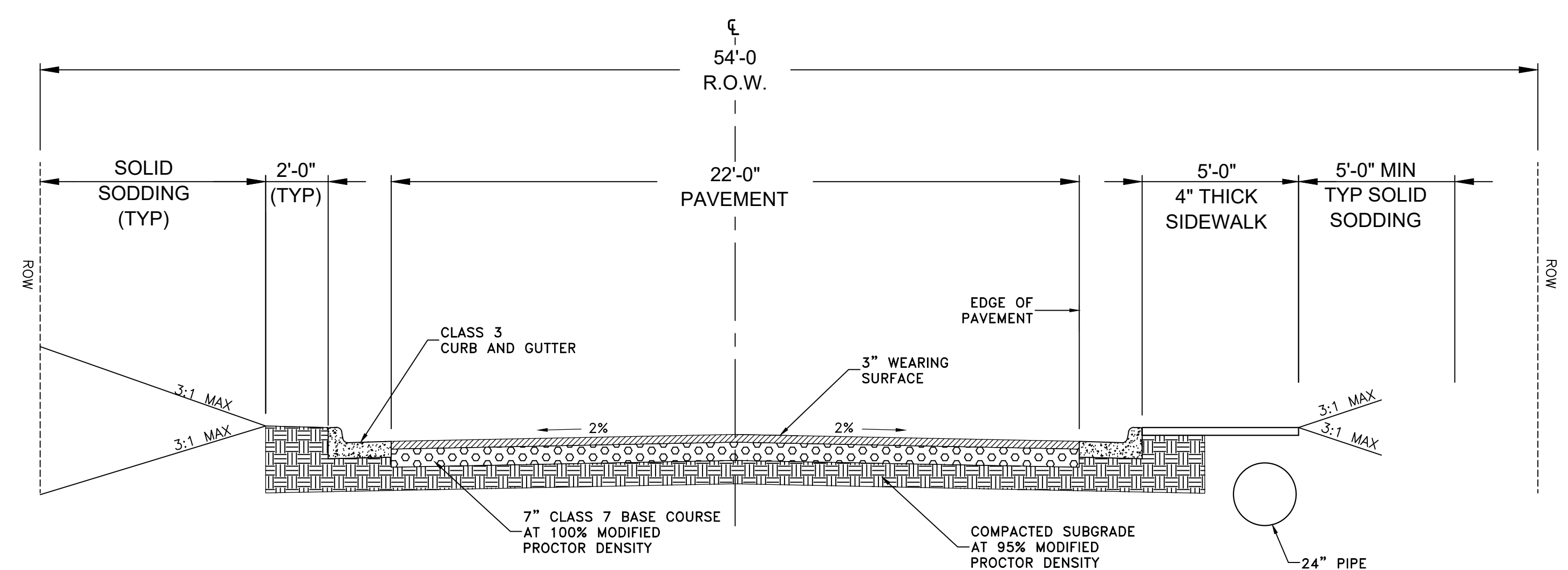

"F" STREET PROPOSED TYPICAL SECTION

STA 11+72.19 TO STA 13+49.10

60% PRELIMINARY DESIGN

FOR REVIEW ONLY

These documents are for Design Review and not intended for Construction, Bidding or Permit Purposes. They were prepared by, or under the supervision of:

CHRISTAN VILLARREAL P.E.# 21648 4/8/2024
Date

CITY OF LITTLE ROCK, ARKANSAS
"F" STREET (SPRUCE TO PALM) RECONSTRUCTION
TYPICAL SECTION

DEPARTMENT OF PUBLIC WORKS
CIVIL ENGINEERING
701 W. MARKHAM
LITTLE ROCK, ARKANSAS 72201

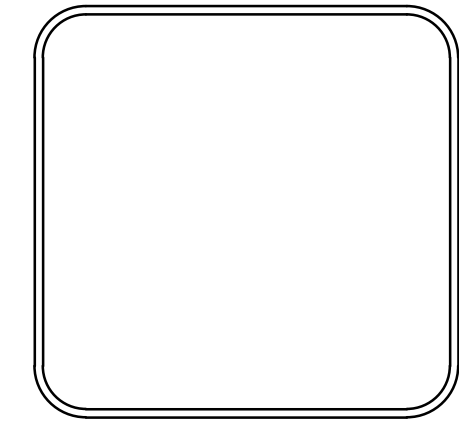

DRAWN BY
CV
DESIGNED
CV
CHECKED
JB
DATE
01/19/2024
SCALE
N.T.S.
PROJECT NO.
CLR # 02-22-DR-06
SHEET NO.
C3

REVISIONS	DATE

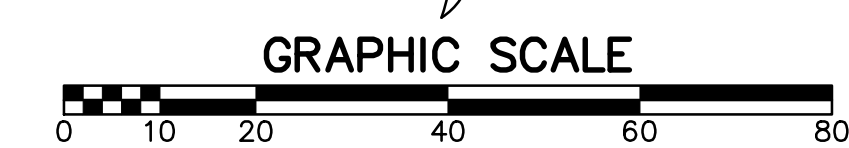
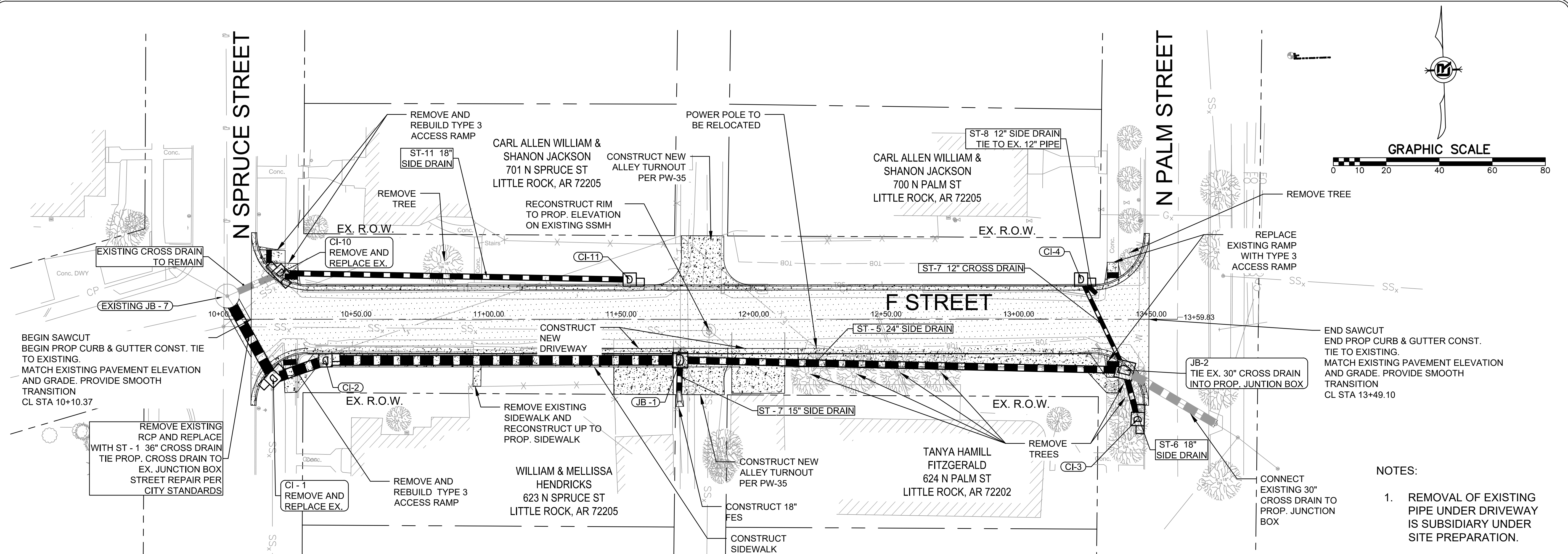

- NOTES:
1. REMOVAL OF EXISTING PIPE UNDER DRIVEWAY IS SUBSIDIARY UNDER SITE PREPARATION.

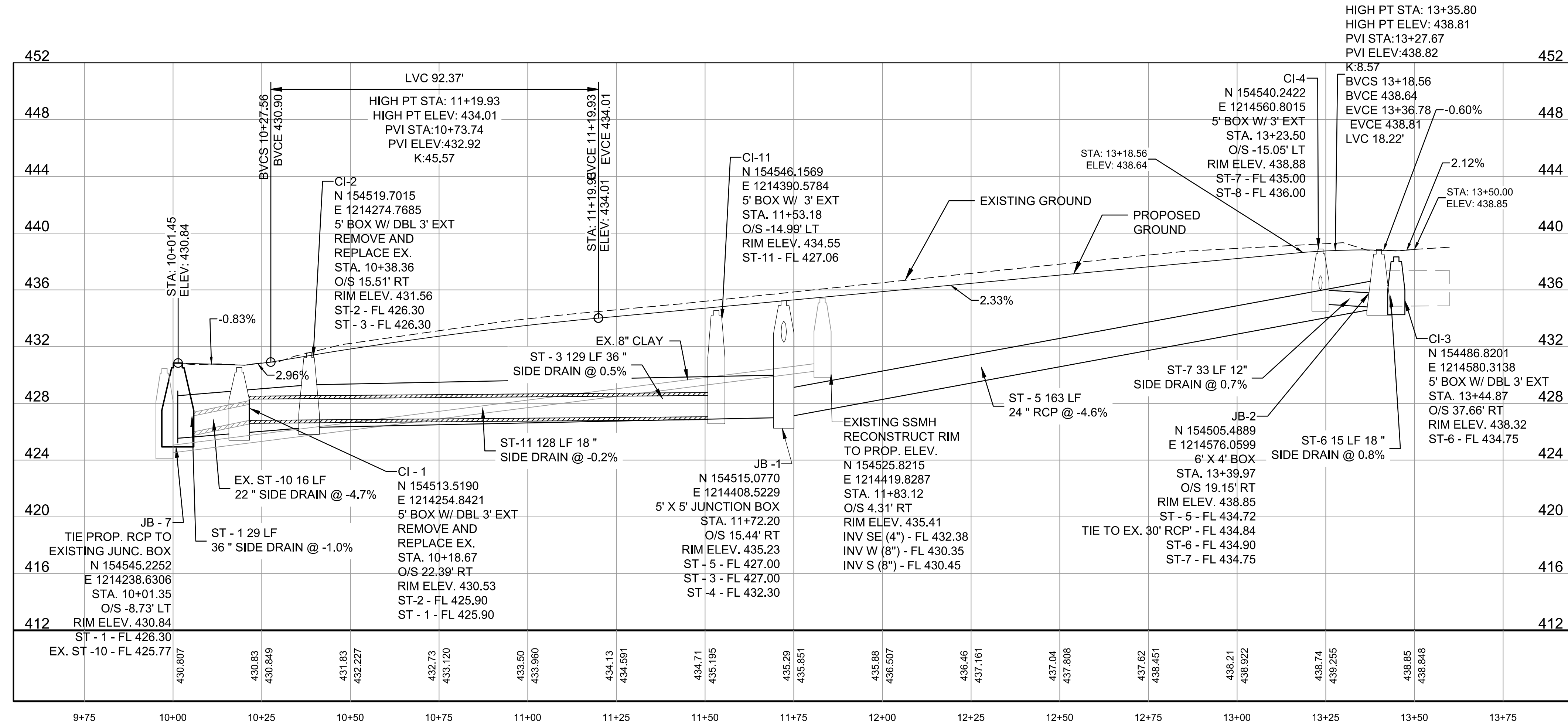

60% PRELIMINARY DESIGN

FOR REVIEW ONLY

These documents are for Design Review and not intended for Construction, Bidding or Permit Purposes. They were prepared by, or under the supervision of:

CHRISTIAN VILLARREAL P.E.# 21648 04/08/2024

Date

CITY OF LITTLE ROCK, ARKANSAS

"F" STREET (SPRUCE TO PALM) RECONSTRUCTION

PLAN SHEET

DEPARTMENT OF PUBLIC WORKS
CIVIL ENGINEERING
701 W. MARKHAM
LITTLE ROCK, ARKANSAS 72201

DRAWN BY
CV
DESIGNED
CV
CHECKED
JB
DATE
4/9/2024
SCALE
1" = 20' H, 1" = 5' V

PROJECT NO.
CLR # 03-18-ST-56
SHEET NO.
C4

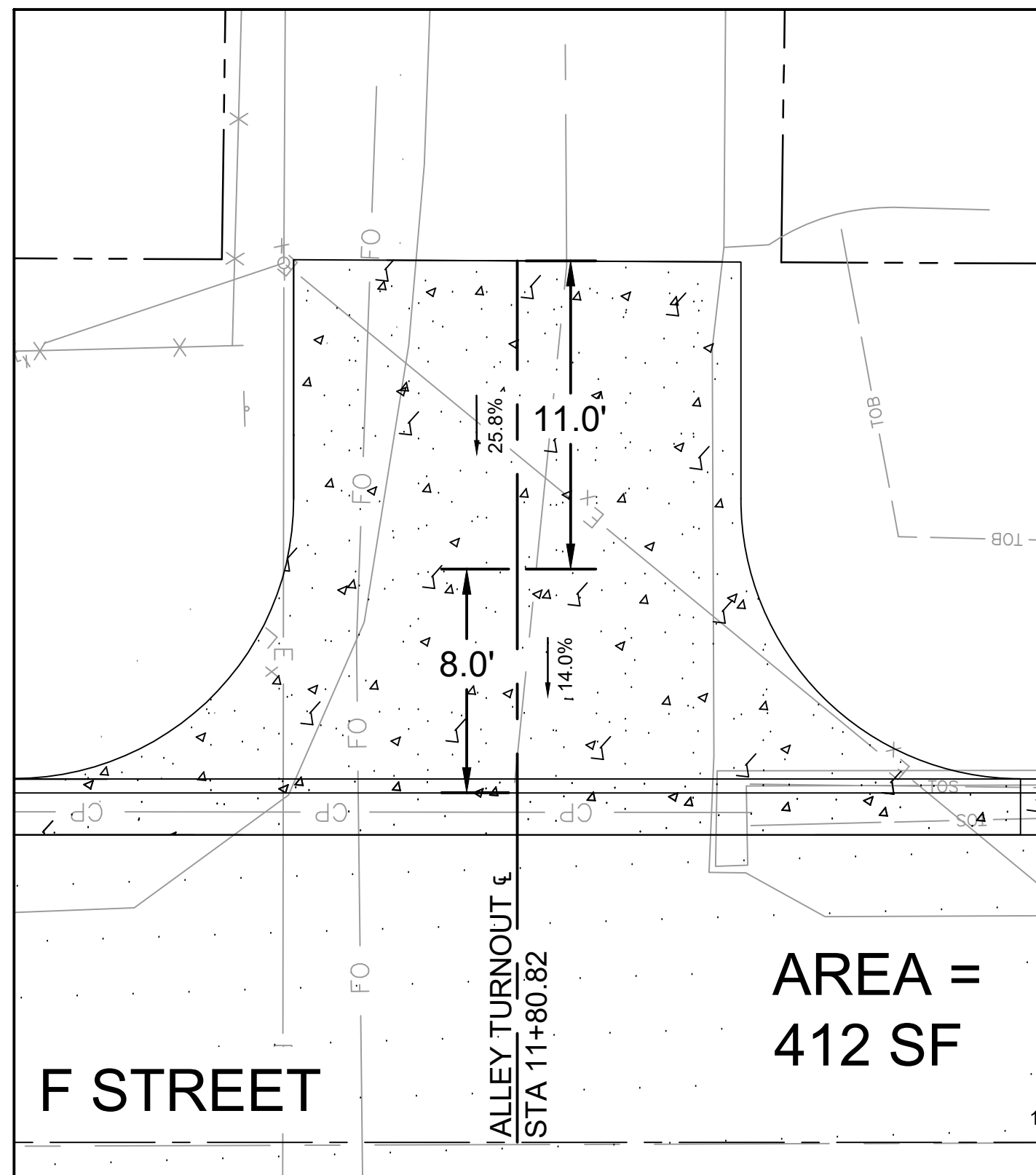

ALLEY TURNOUT AT
STA 11+80.82

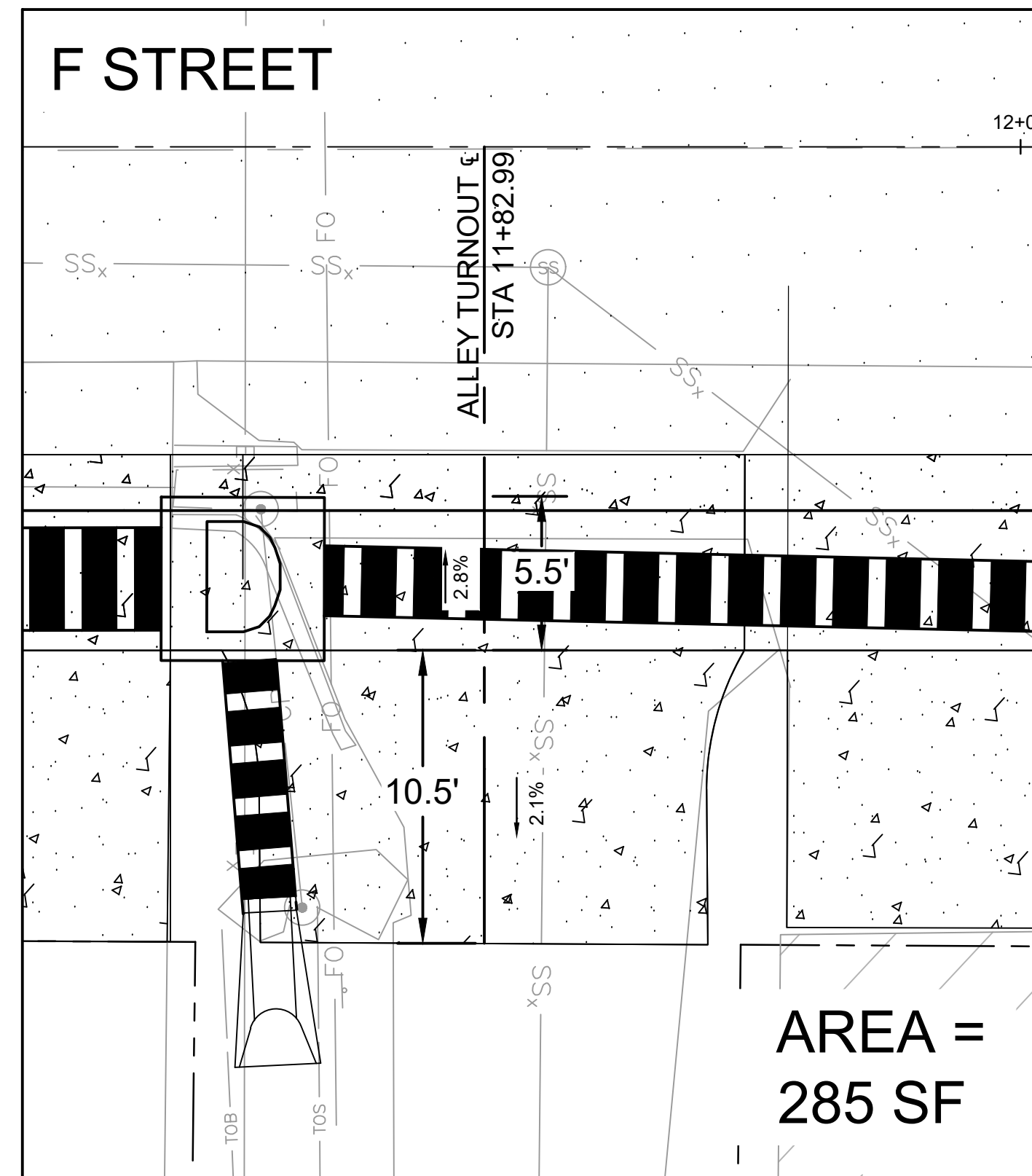

ALLEY TURNOUT AT
STA 11+82.99

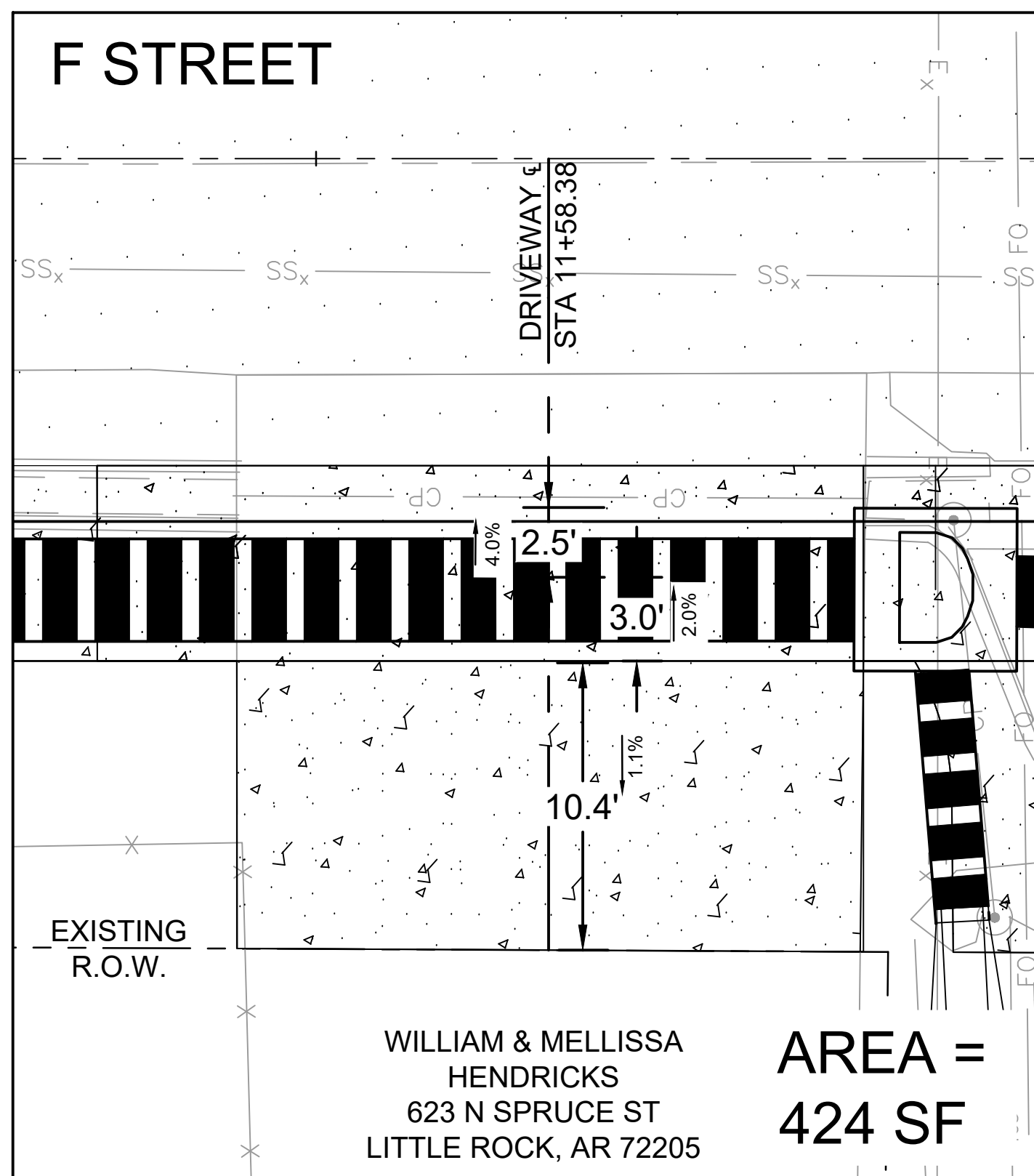

DRIVEWAY AT
STA 11+58.38

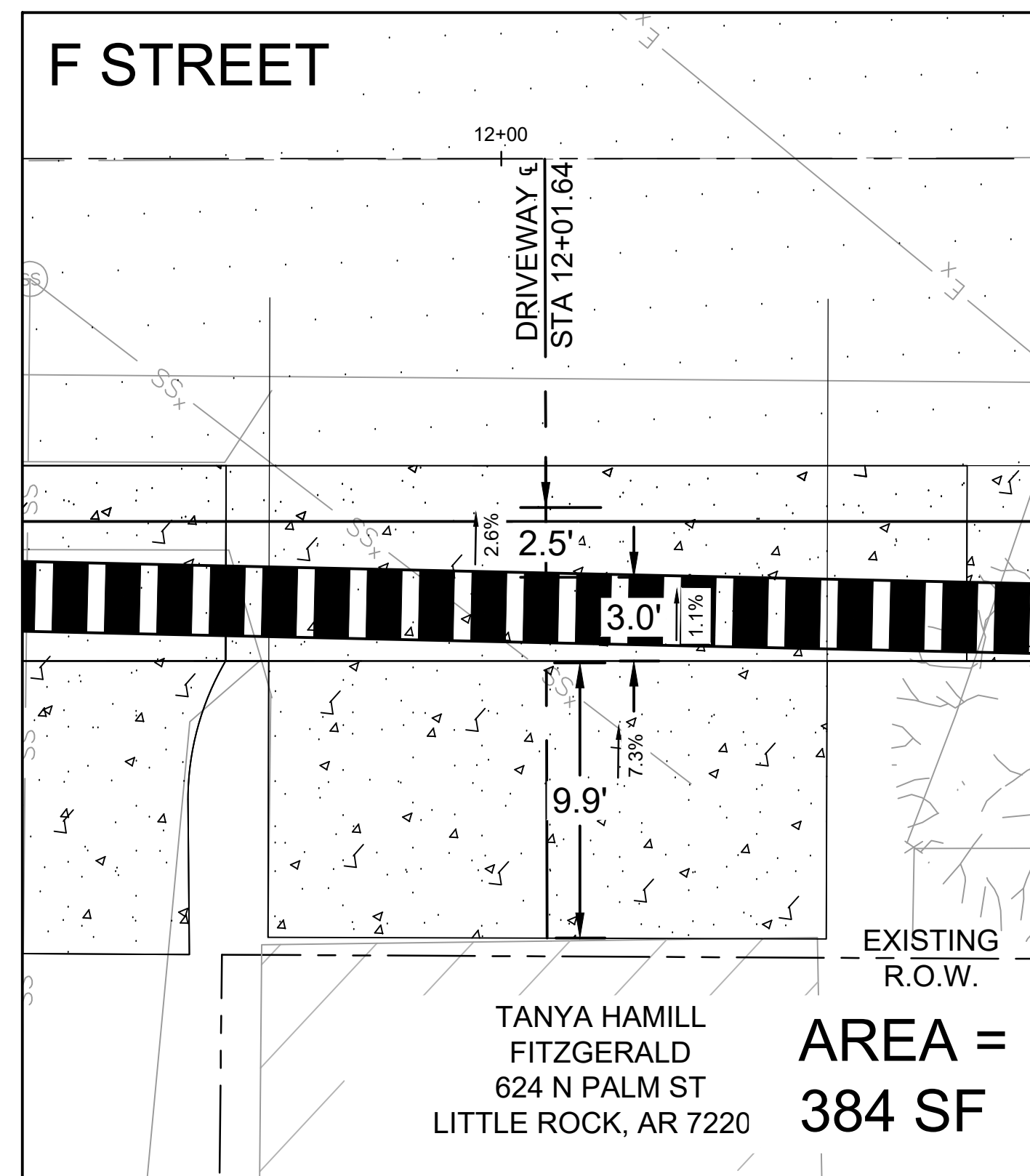

DRIVEWAY AT
STA 12+01.64

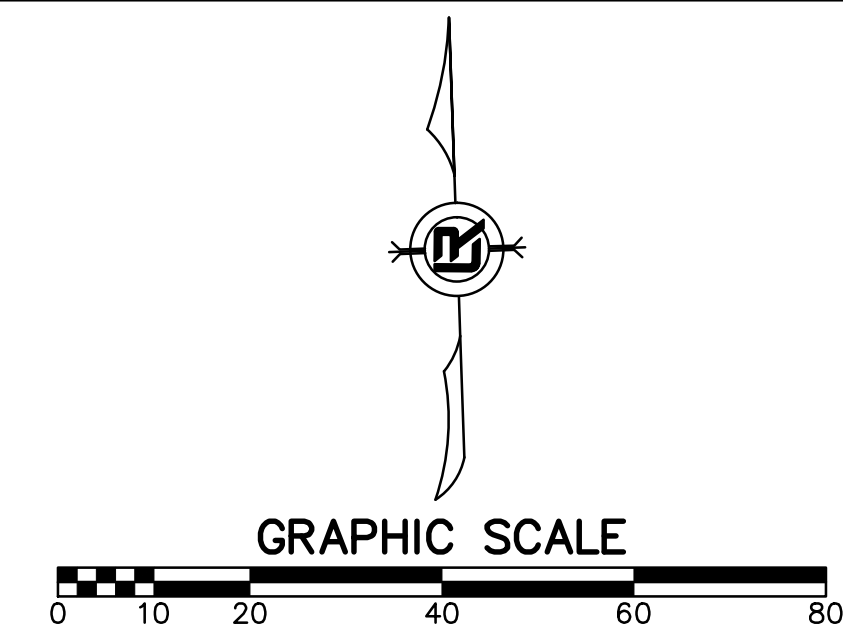

REVISIONS	DATE

CITY OF LITTLE ROCK, ARKANSAS
"F" STREET (SPRUCE TO PALM) RECONSTRUCTION
DRIVEWAY DETAILS

DEPARTMENT OF PUBLIC WORKS
CIVIL ENGINEERING
701 W. MARKHAM
LITTLE ROCK, ARKANSAS 72201

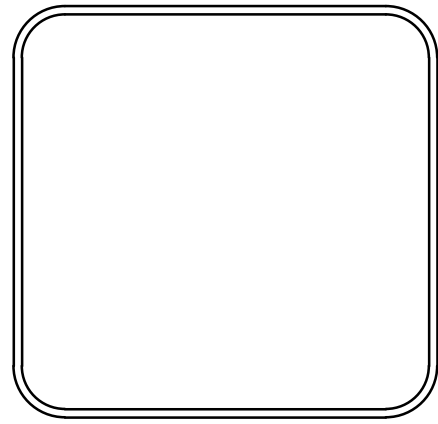

DRAWN BY
CV
DESIGNED
CV
CHECKED
JB
DATE
4/8/2024
SCALE
1" = 5'
PROJECT NO.
CLR # 03-18-ST-56
SHEET NO.
C5

60% PRELIMINARY DESIGN
FOR REVIEW ONLY
These documents are for Design Review and not intended for Construction, Bidding or Permit Purposes. They were prepared by, or under the supervision of:
CHRISTIAN VILLARREAL P.E.# 21648 4/8/2024
Date

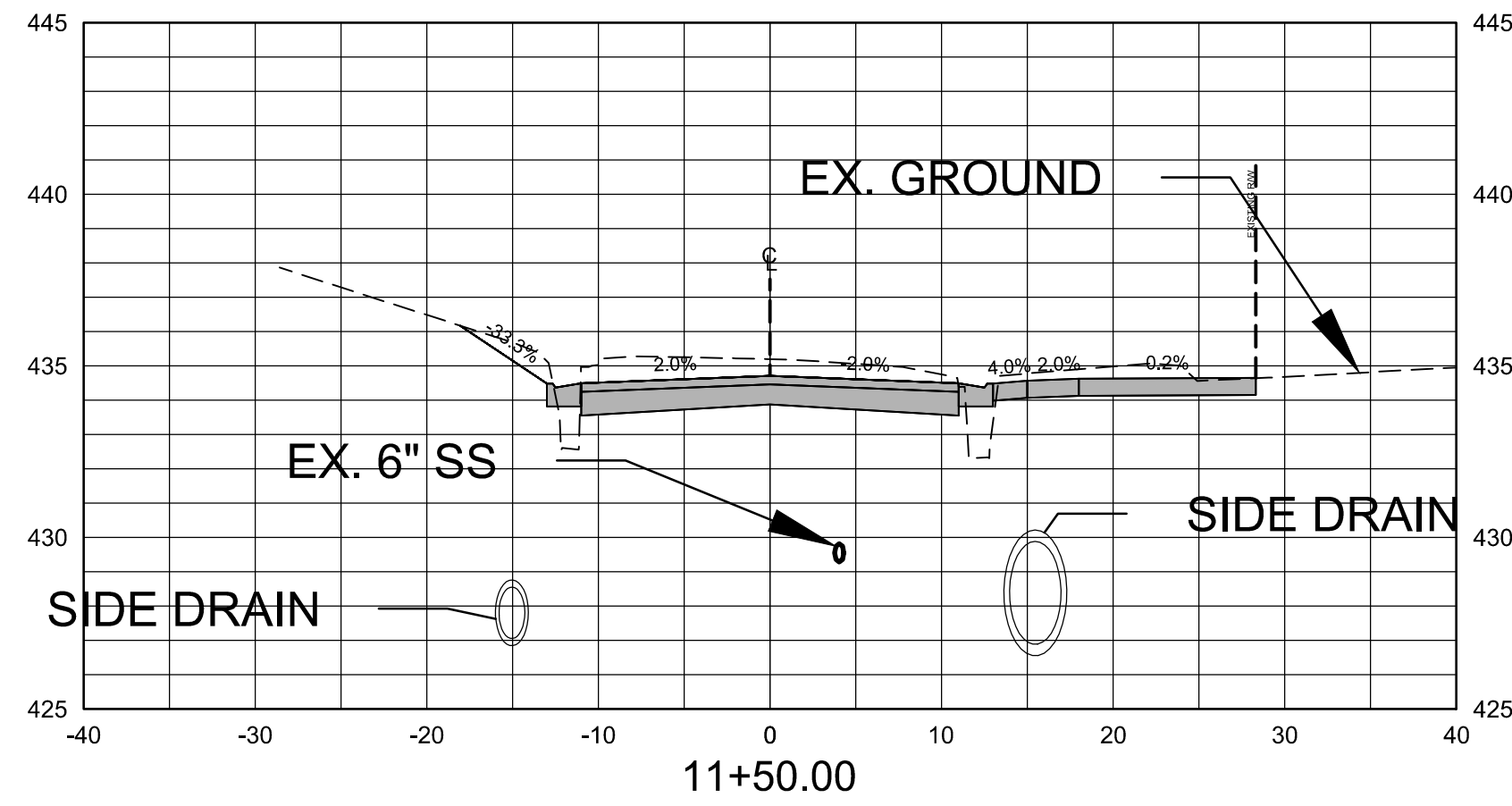

Total Volume at Station 11+50.00	
Cut Area	56.11
Fill Area	3.68
Cut Vol	80.86
Fill Vol	4.73
Cum Cut Vol	146.70
Cum Fill Vol	7.08
Net Vol	139.62

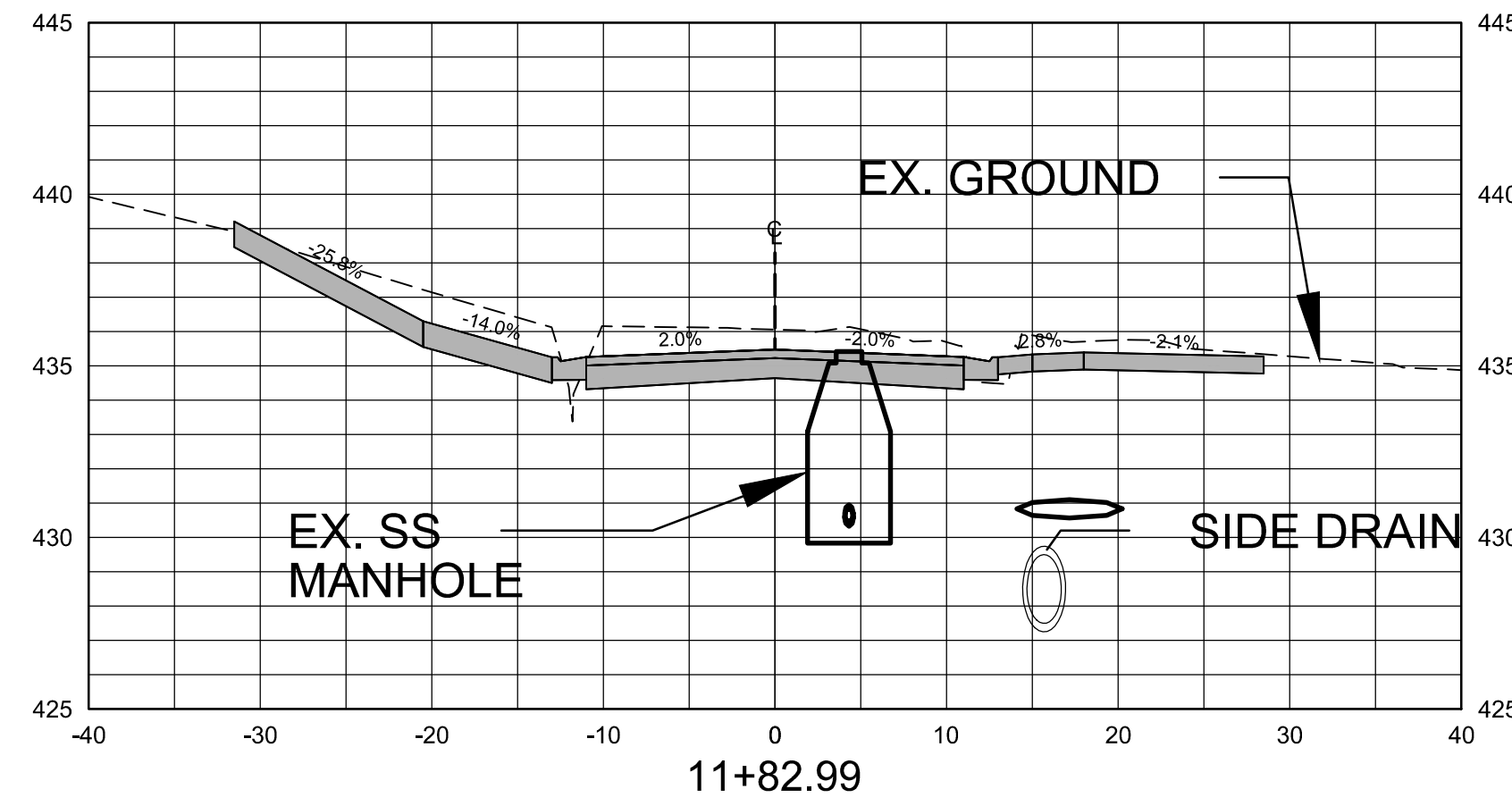

Total Volume at Station 11+82.99	
Cut Area	80.08
Fill Area	0.49
Cut Vol	6.35
Fill Vol	0.06
Cum Cut Vol	232.03
Cum Fill Vol	9.37
Net Vol	222.66

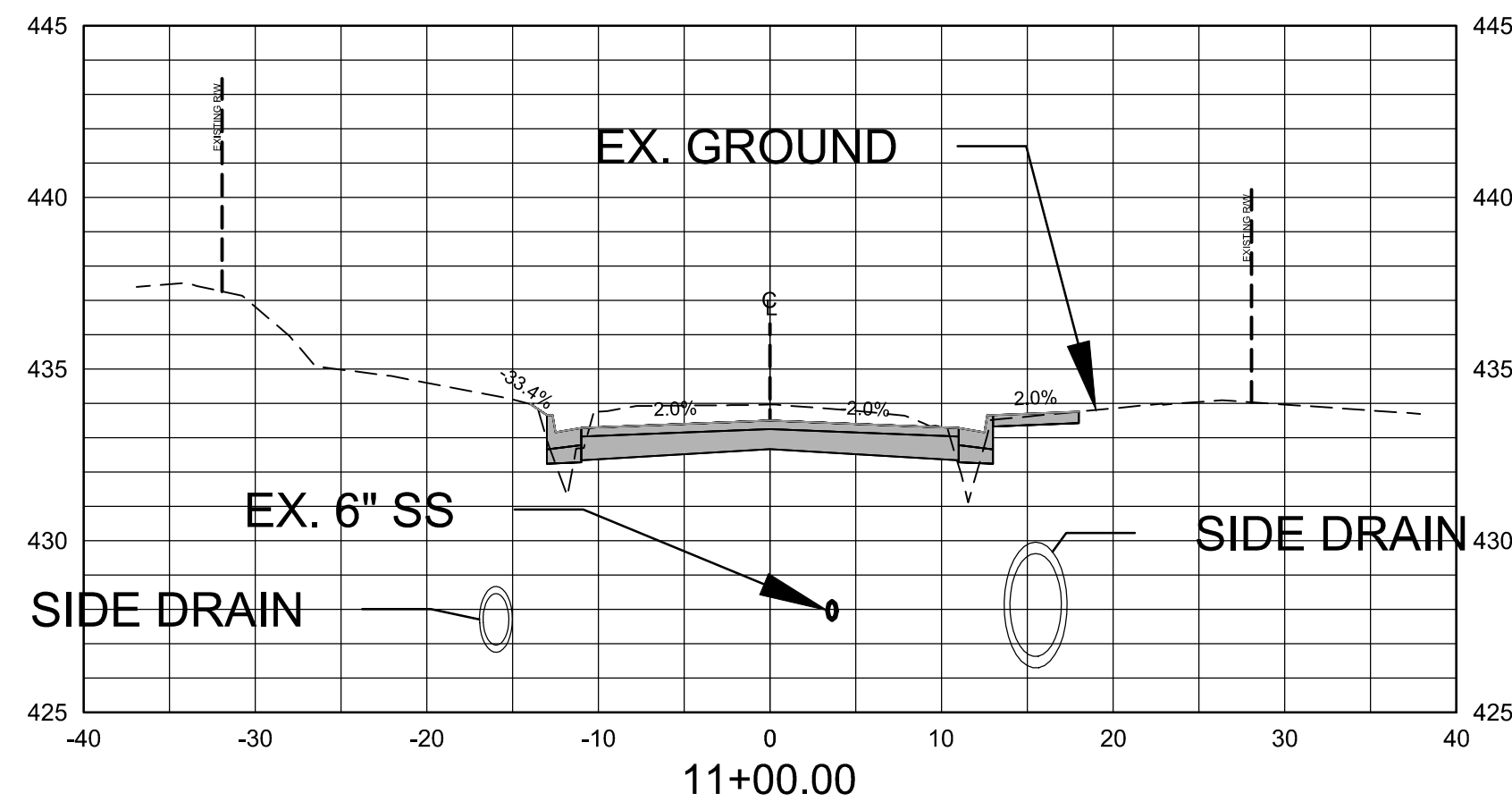

Total Volume at Station 11+00.00	
Cut Area	31.22
Fill Area	1.43
Cut Vol	65.84
Fill Vol	2.35
Cum Cut Vol	65.84
Cum Fill Vol	2.35
Net Vol	63.48

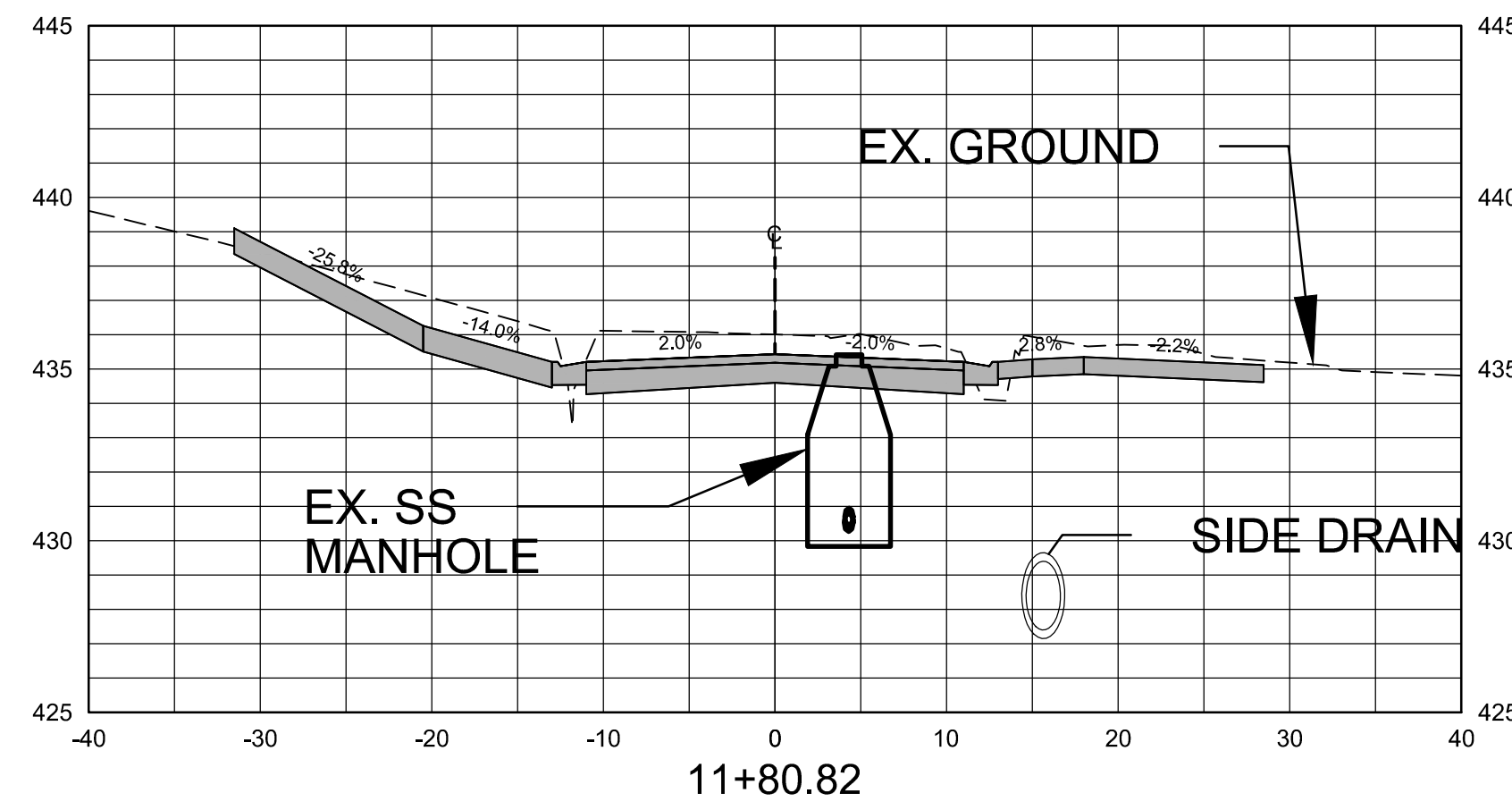

Total Volume at Station 11+80.82	
Cut Area	78.55
Fill Area	1.02
Cut Vol	60.04
Fill Vol	1.33
Cum Cut Vol	225.68
Cum Fill Vol	9.31
Net Vol	216.37

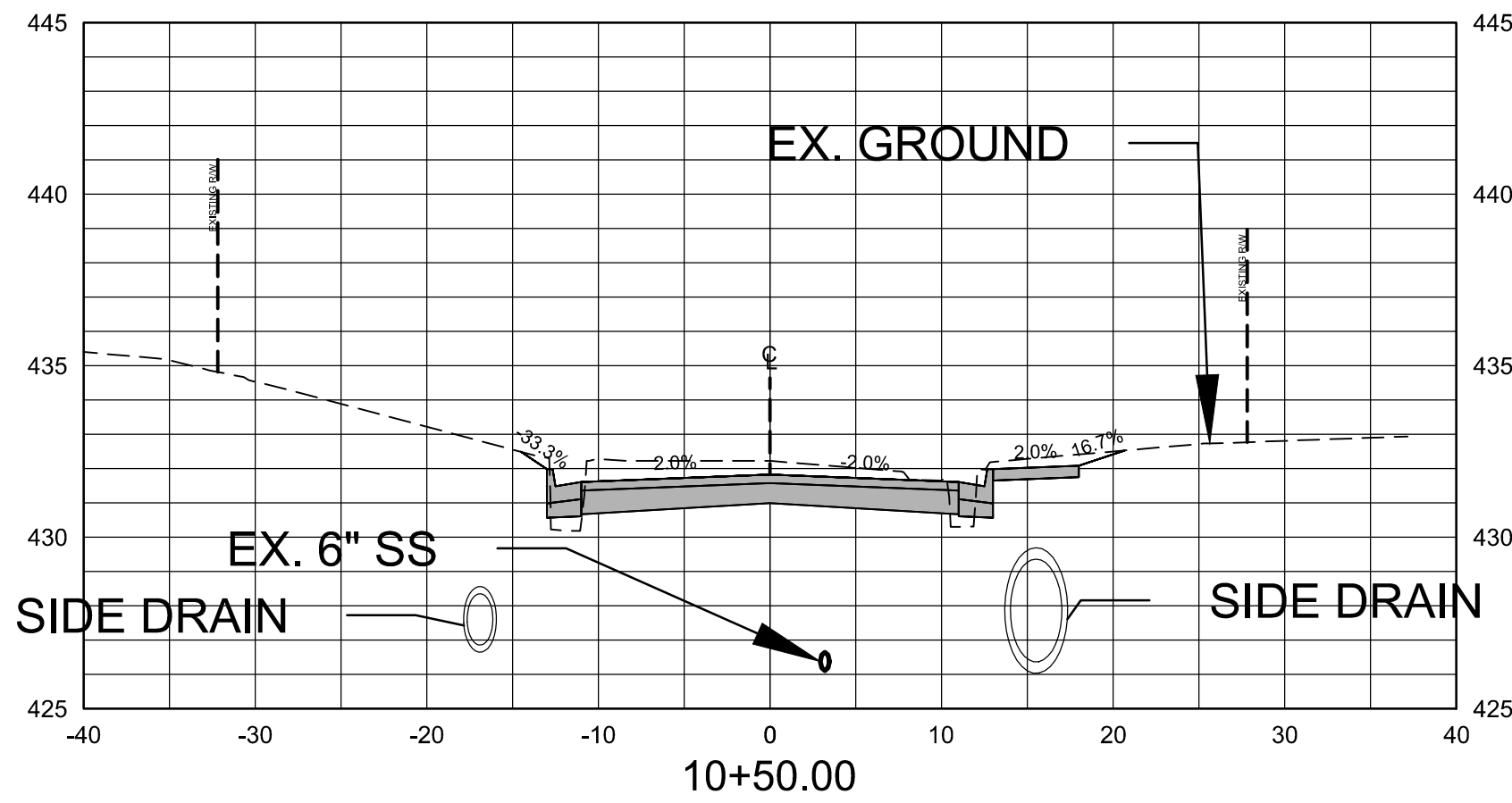

Total Volume at Station 10+50.00	
Cut Area	39.89
Fill Area	1.11
Cut Vol	0.00
Fill Vol	0.00
Cum Cut Vol	0.00
Cum Fill Vol	0.00
Net Vol	0.00

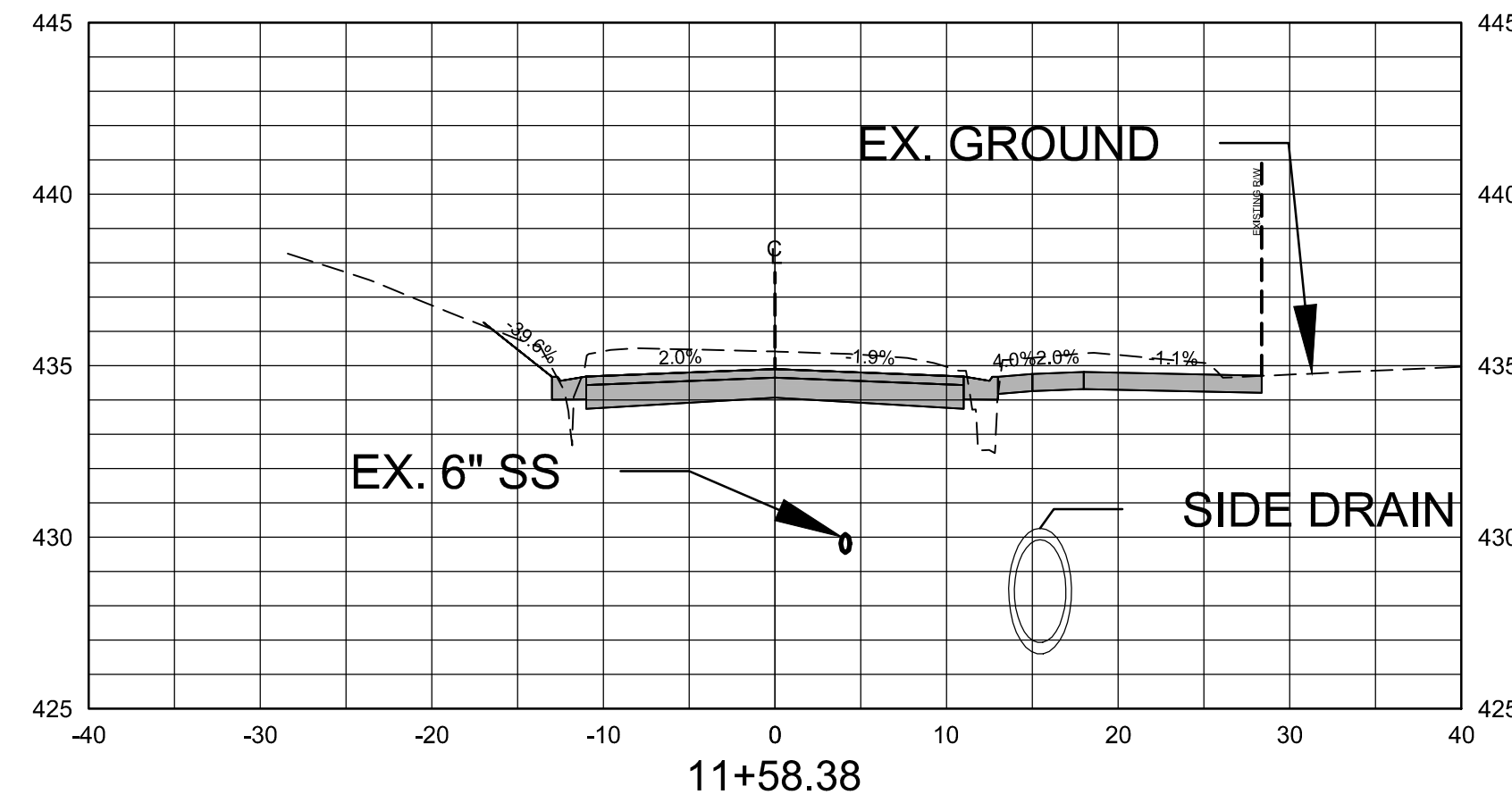

Total Volume at Station 11+58.38	
Cut Area	65.92
Fill Area	2.17
Cut Vol	18.95
Fill Vol	0.91
Cum Cut Vol	165.64
Cum Fill Vol	7.99
Net Vol	157.66

60% PRELIMINARY DESIGN

FOR REVIEW ONLY

These documents are for Design Review and not intended for construction, Bidding or Permit Purposes. They were prepared by, or under the supervision of:

CHRISTIAN VILLARREAL P.E.# 21648 4/08/2024
Date

REVISIONS DATE

CITY OF LITTLE ROCK, ARKANSAS
"F" STREET (SPRUCE TO PALM) RECONSTRUCTION

CROSS SECTION

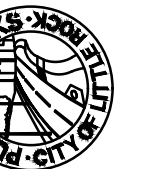

DEPARTMENT OF PUBLIC WORKS
CIVIL ENGINEERING
701 W. MARKHAM
LITTLE ROCK, ARKANSAS 72201



DRAWN BY

GV

DESIGNED

CV

CHECKED

CV

DATE

4/9/2024

SCALE

1" = 20' H, 1" = 5V

PROJECT NO.

CLR# 831B3256

SHEET NO.

C6

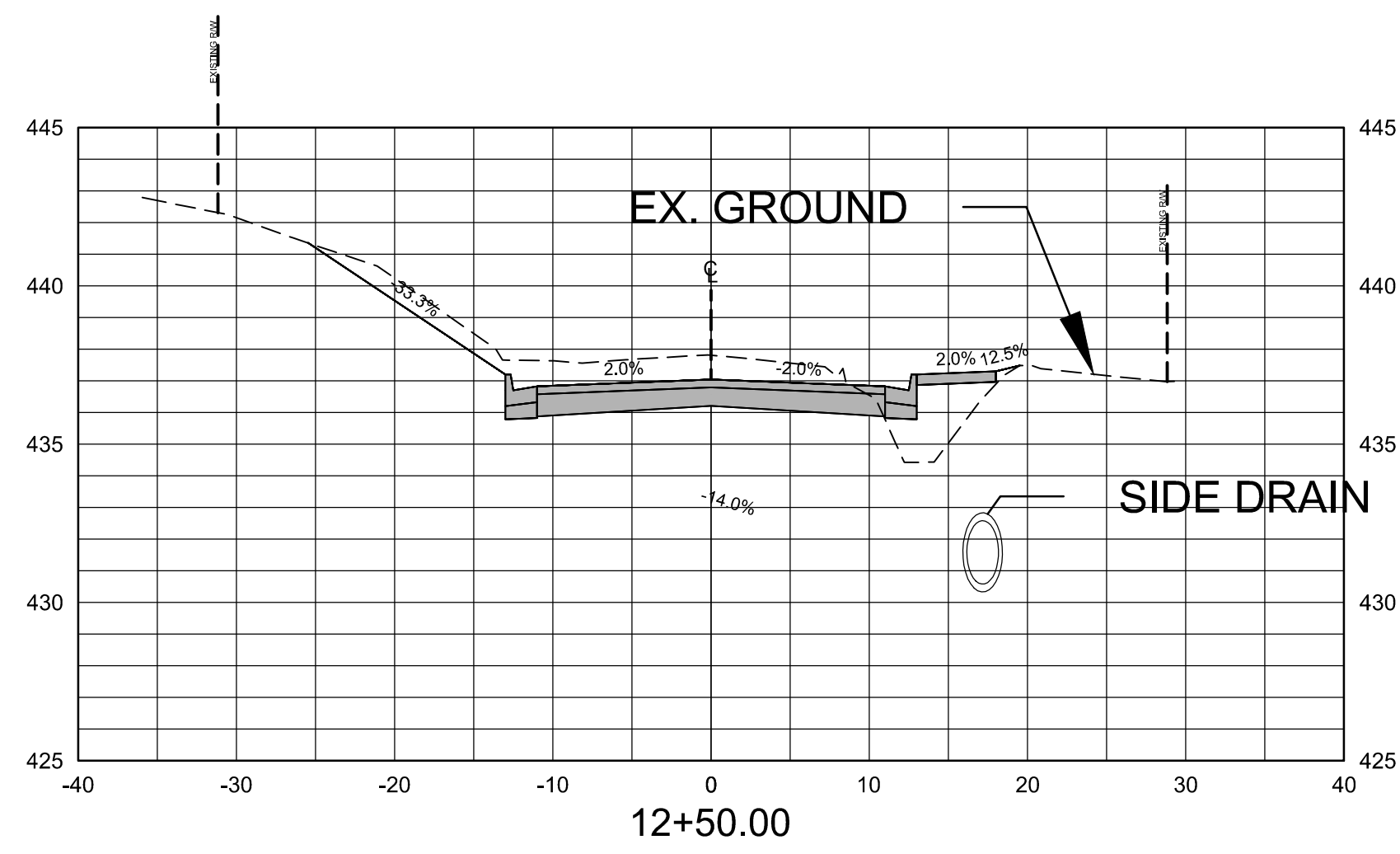

Total Volume at Station 12+50.00	
Cut Area	45.72
Fill Area	9.59
Cut Vol	121.33
Fill Vol	8.98
Cum Cut Vol	412.68
Cum Fill Vol	18.59
Net Vol	394.09

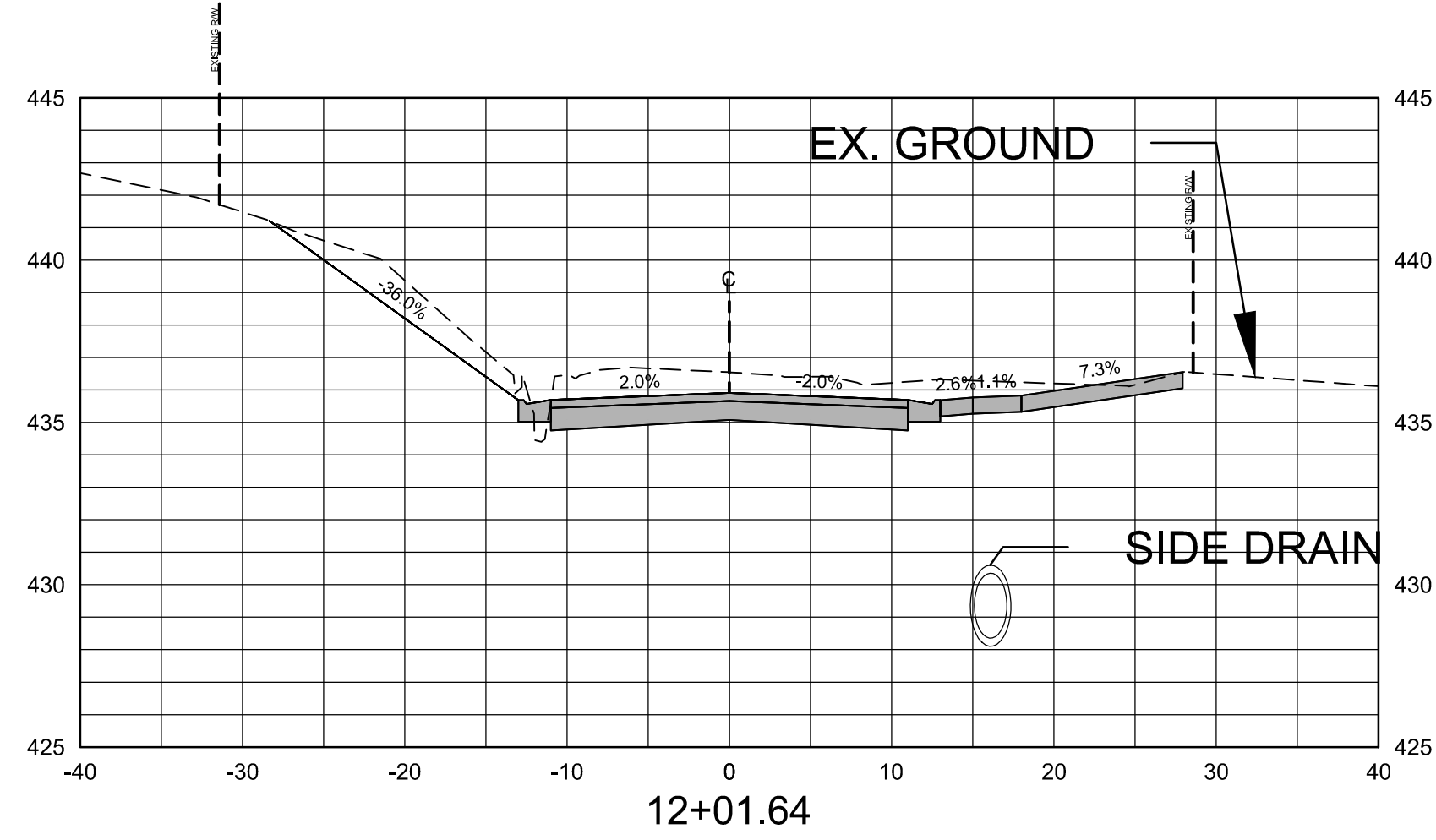

Total Volume at Station 12+01.64	
Cut Area	89.77
Fill Area	0.44
Cut Vol	5.49
Fill Vol	0.02
Cum Cut Vol	291.34
Cum Fill Vol	9.61
Net Vol	281.74

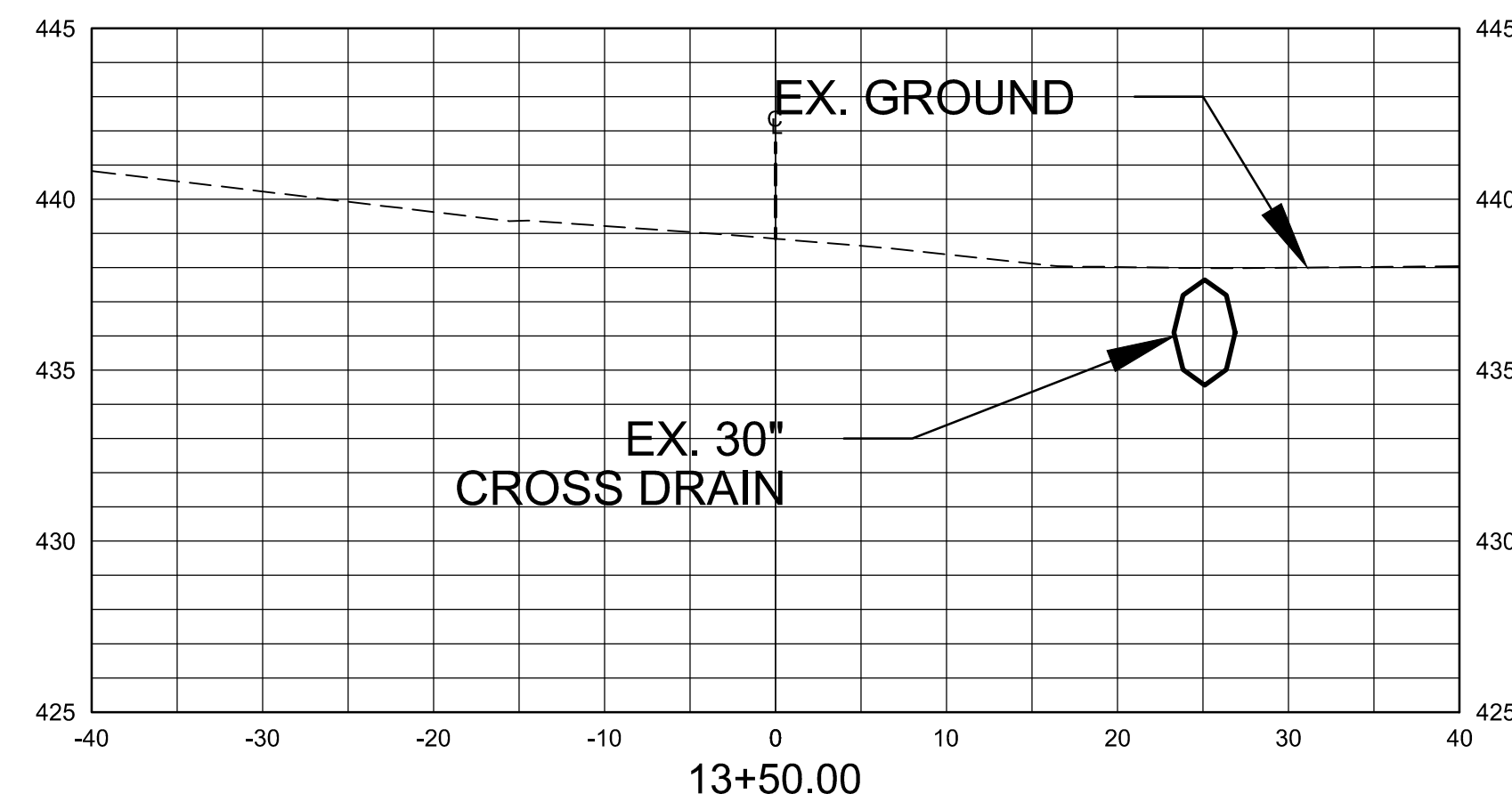

Total Volume at Station 13+50.00	
Cut Area	0.00
Fill Area	0.00
Cut Vol	52.21
Fill Vol	14.19
Cum Cut Vol	559.43
Cum Fill Vol	55.85
Net Vol	503.58

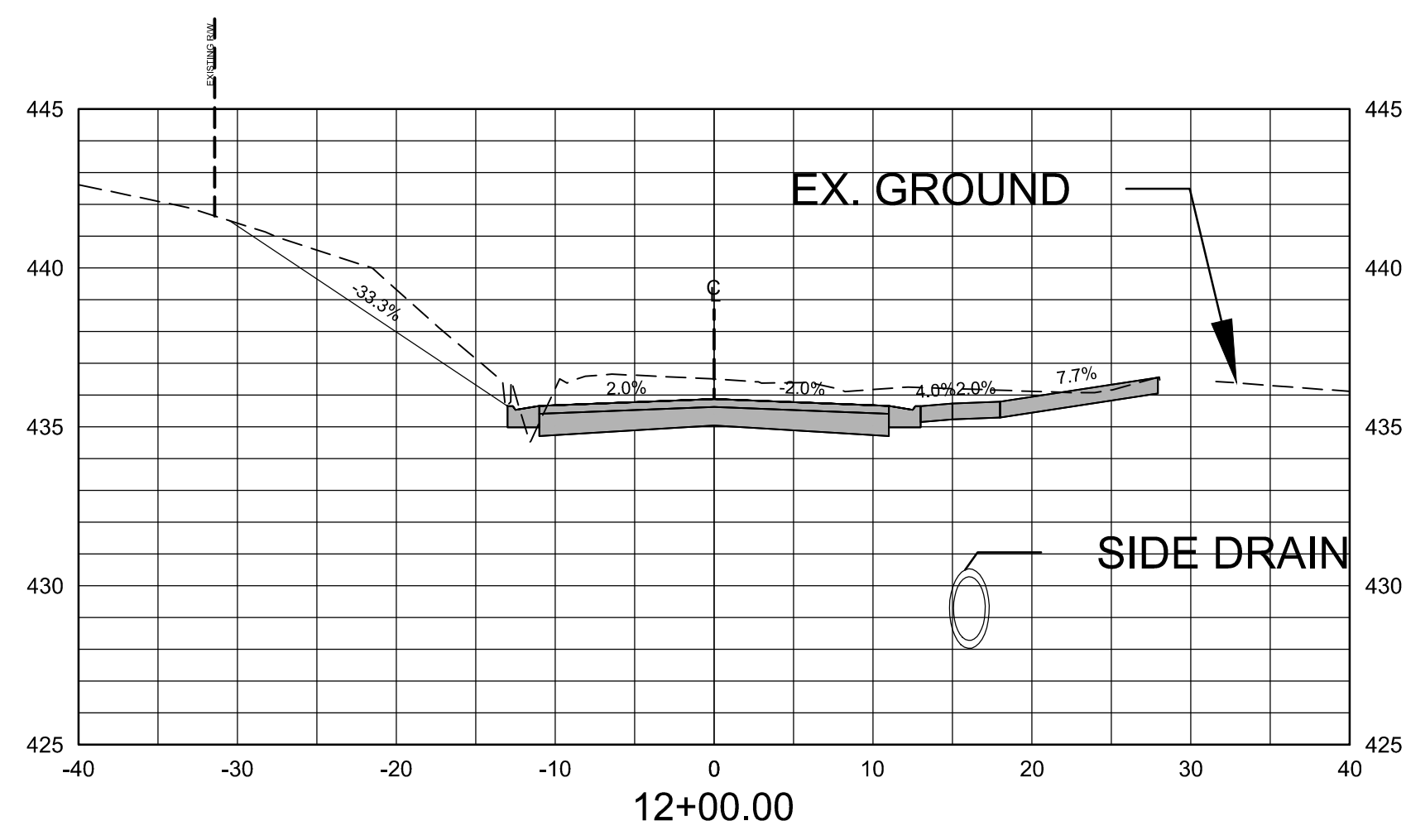

Total Volume at Station 12+00.00	
Cut Area	90.74
Fill Area	0.18
Cut Vol	53.82
Fill Vol	0.21
Cum Cut Vol	285.85
Cum Fill Vol	9.59
Net Vol	276.26

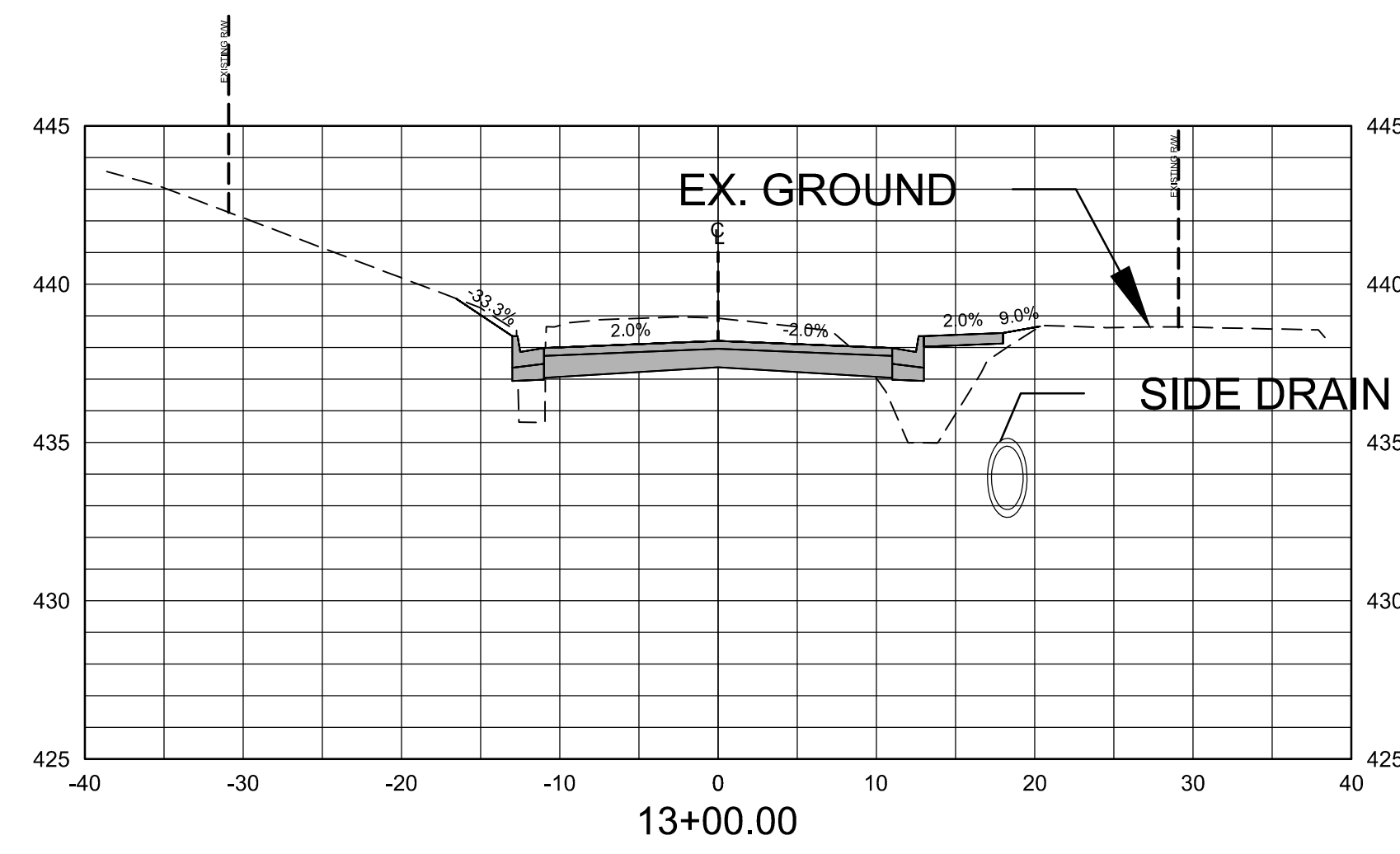

Total Volume at Station 13+00.00	
Cut Area	56.39
Fill Area	15.33
Cut Vol	94.54
Fill Vol	23.07
Cum Cut Vol	507.22
Cum Fill Vol	41.66
Net Vol	465.56

60% PRELIMINARY DESIGN

FOR REVIEW ONLY
 These documents are for Design Review and not intended for construction, Bidding or Permit Purposes. They were prepared by, or under the supervision of:
CHRISTIAN VILLARREAL P.E.# 21648 4/08/2024
 Date

REVISIONS	DATE

CITY OF LITTLE ROCK, ARKANSAS
"F" STREET (SPRUCE TO PALM) RECONSTRUCTION
 CROSS SECTION

DEPARTMENT OF PUBLIC WORKS
CIVIL ENGINEERING
 701 W. MARKHAM
 LITTLE ROCK, ARKANSAS 72201

DRAWN BY
CV
DESIGNED
CV
CHECKED
OB
DATE
4/9/2024
SCALE
 1" = 20' H, 1" = 5V
PROJECT NO.
CLR# 83V1B3256
SHEET NO.
C7

SURVEY CONTROL POINTS LARCH ROAD							
POINT	DESCRIPTION	NORTHING	EASTING	ELEVATION	BASELINE REFERENCE	BASELINE STATION	BASELINE OFFSET
C/P #1	60D NAIL ON THE NORTH SIDE OF "F" STREET	154541.6632	1214580.2110	439.80	F ST.	13+42.85	17.15 LT
C/P #2	PK NAIL ON THE SOUTH SIDE OF "F" STREET	154514.6677	1214413.1152	435.50	F ST.	11+76.80	15.69 RT
C/P #3	60D NAIL ON THE NORTH SIDE OF "F" STREET	154553.3372	1214269.2534	432.08	F ST.	10+31.67	17.91 LT
C/P #6	60D NAIL ON THE NORTH SIDE OF "F" STREET	154550.7794	1214562.9422	441.68	F ST.	13+25.27	25.65 LT
TBM 1	CHISELED SQUARE ON THE NW CORNER OF THE CONCRETE PAD EAST OF THE FENCE ON THE EAST SIDE OF PALM ST.	154621.9354	1214642.8476	446.22	F ST.	N/A	97.99 LT

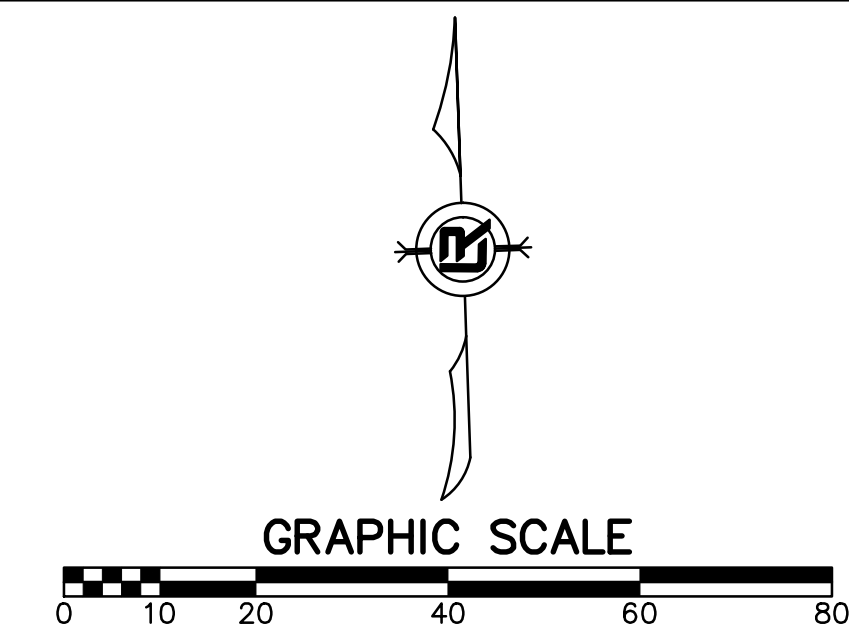

REVISIONS	DATE

CITY OF LITTLE ROCK, ARKANSAS
 "F" STREET (SPRUCE TO PALM) RECONSTRUCTION
 PROJECT LAYOUT

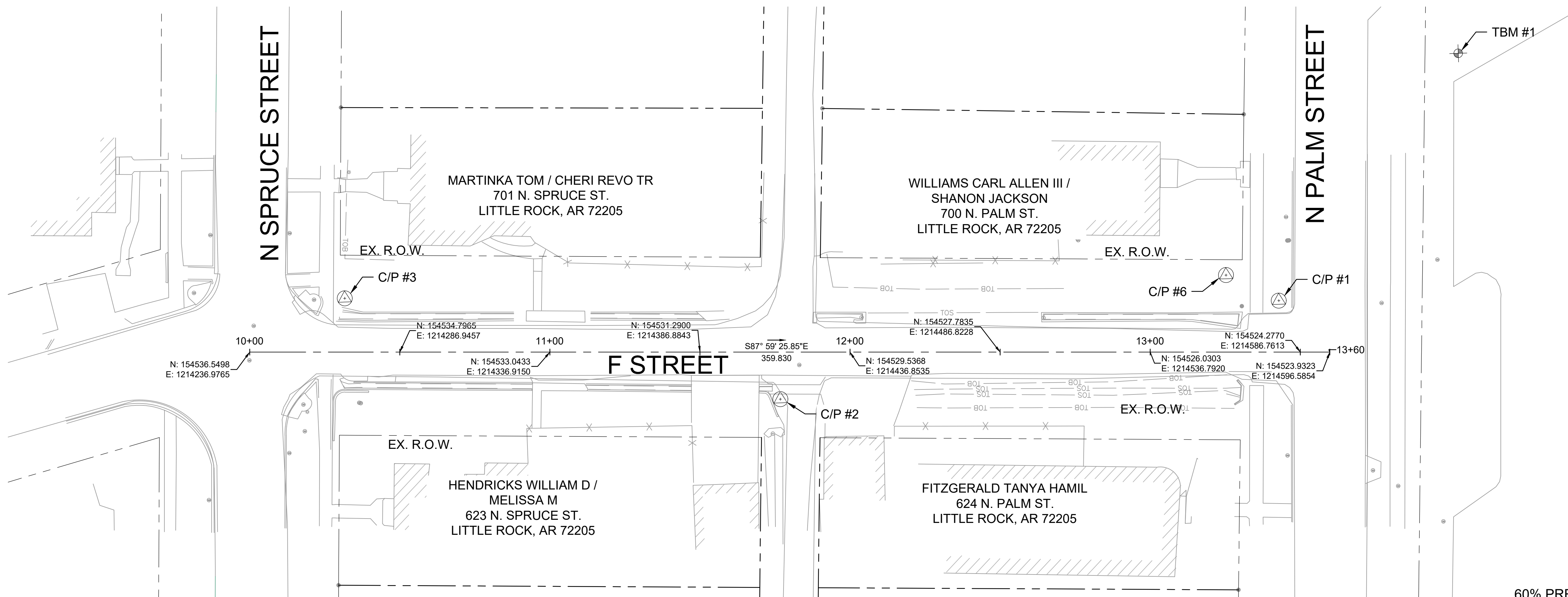

60% PRELIMINARY DESIGN

FOR REVIEW ONLY

These documents are for Design Review and not intended for Construction, Bidding or Permit Purposes. They were prepared by, or under the supervision of:

CHRISTIAN VILLARREAL P.E.# 21648 01/24/2023
Date

DEPARTMENT OF PUBLIC WORKS
 CIVIL ENGINEERING
 701 W. MARKHAM
 LITTLE ROCK, ARKANSAS 72201

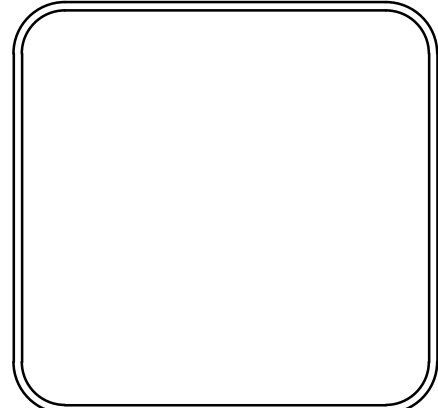

DRAWN BY
 CV
 DESIGNED
 CV
 CHECKED
 JB
 DATE
 4/8/2024
 SCALE
 1" = 20'
 PROJECT NO.
 CLR # 03-18-ST-56
 SHEET NO.
C8

REVISIONS	DATE

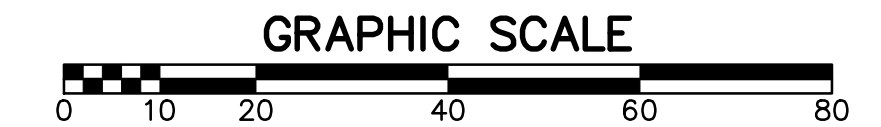
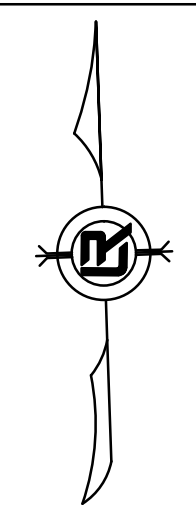

PHASING LEGEND
 PHASE 1 (INITIAL STRIP AND DEMOLITION)
 PHASE 2 (NEW DRAINAGE, AND COMPACTED EMBANKMENT)
 PHASE 3 (NEW, CURB, SIDEWALK, DRIVEWAY APRONS CONSTRUCTED AND FINAL GRADING)
 PHASE 4 ASPHALT AND (RESTORE DISTURBED AREAS WITH SOD)

CITY OF LITTLE ROCK, ARKANSAS
 "F" STREET (SPRUCE TO PALM) RECONSTRUCTION

EROSION CONTROL

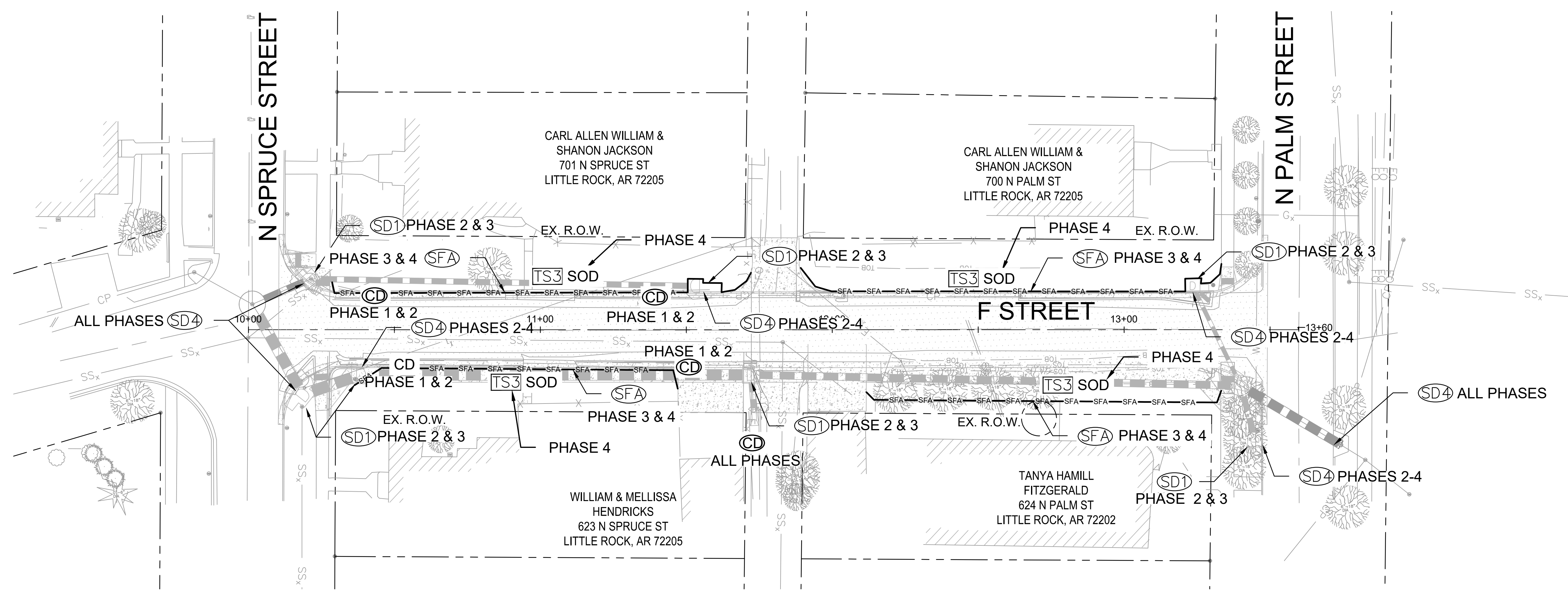

60% PRELIMINARY DESIGN

FOR REVIEW ONLY
 These documents are for Design Review and not intended for Construction, Bidding or Permit Purposes. They were prepared by, or under the supervision of:
 CHRISTIAN VILLARREAL P.E.# 21648 4/8/2024
 Date

DEPARTMENT OF PUBLIC WORKS
 CIVIL ENGINEERING
 701 W. MARKHAM
 LITTLE ROCK, ARKANSAS 72201

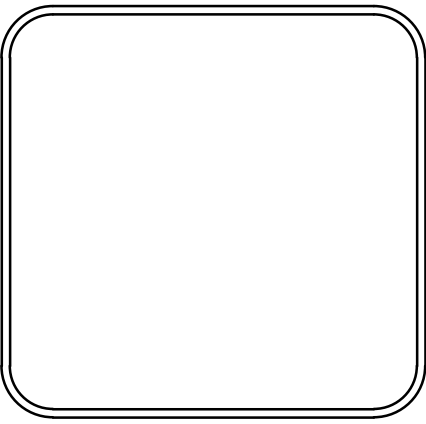

DRAWN BY
 CV
 DESIGNED
 CV
 CHECKED
 JB
 DATE
 4/8/2024
 SCALE
 1" = 20'
 PROJECT NO.
 CLR # 03-18-ST-56
 SHEET NO.
C9