

CLR PROJECT 02-22-DR-06 #57TH STREET DRAINAGE

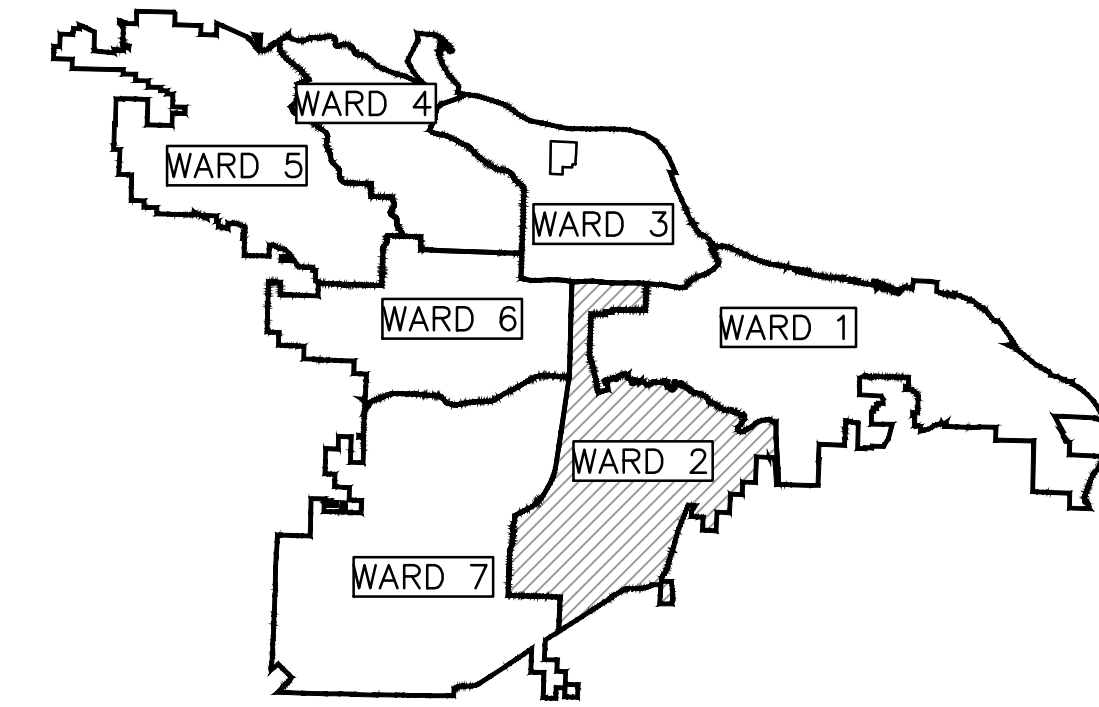

PROJECT LOCATION - WARD 2

60% PRELIMINARY DESIGN

FOR REVIEW ONLY

These documents are for Design Review and not intended for Construction, Bidding or Permit Purposes. They were prepared by, or under the supervision of:

CHRISTIAN VILLARREAL P.E.# 21648 4/1/24

Date

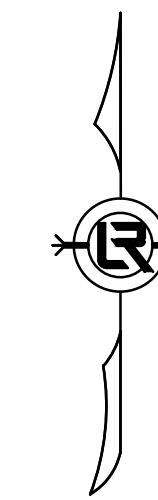
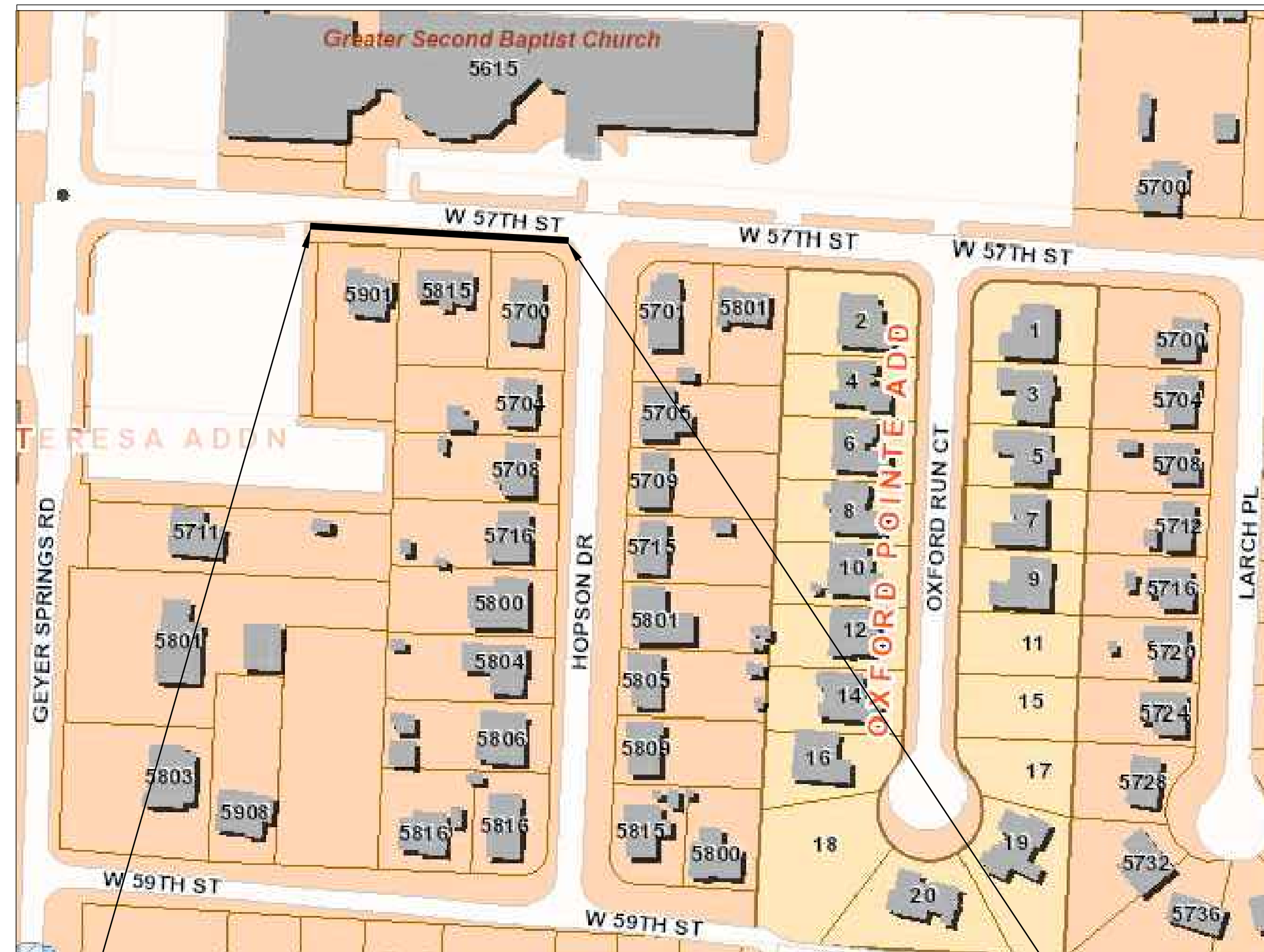

BEGIN PROJECT
57TH STREET
CL STA 10+54.18
NORTHING = 132897.4412
EASTING= 1209480.5066

*PROJECT
LOCATION*

END PROJECT
57TH STREET
CL STA 12+91.44
NORTHING = 132883.4800
EASTING = 1209717.8943

DEPARTMENT OF PUBLIC WORKS
CIVIL ENGINEERING
701 WEST MARKHAM STREET
LITTLE ROCK, ARKANSAS 72201

**2023-2025
BOND PROGRAM**

INDEX OF SHEETS:

- C1 COVER SHEET
- C2 GENERAL NOTES, LEGEND AND QUANTITIES
- C3 TYPICAL SECTIONS
- C4 EXISTING CONDITIONS
- C5 PLAN & PROFILE SHEET
- C6 DRIVEWAY DETAILS
- C7 CROSS SECTIONS
- C8 PROJECT LAYOUT
- C9 EROSION CONTROL



SURVEYOR:



4701 NORTHSHORE DRIVE
NORTH LITTLE ROCK, AR 72118
PHONE: 501-376-3633
WWW.GARVERUSA.COM

ENGINEER OF RECORD:



2020 WEST 3RD STREET, SUITE 504
LITTLE ROCK, AR 72205
PHONE: 501-215-5807 FAX:501-227-8302
WWW.ICONICCG.COM

REVISIONS DATE

REVISIONS	DATE

CITY OF LITTLE ROCK, ARKANSAS
#57TH STREET DRAINAGE

COVER SHEET



DEPARTMENT OF PUBLIC WORKS
CIVIL ENGINEERING
701 W. MARKHAM
LITTLE ROCK, ARKANSAS 72201



DRAWN BY

BJ
DESIGNED
BJ
CHECKED
CV
DATE
4/1/2024
SCALE
N.T.S.
PROJECT NO.
02-22-DR-06
SHEET NO.

C1

REVISIONS	DATE

PRICING OF ESTIMATED QUANTITIES		60% PRELIMINARY DESIGN ESTIMATE			
CLR PROJECT 02-22-DR-06					
2024/04/01					
ITEM #	ITEM DESCRIPTION	UNIT	QUANTITY	UNIT COST	TOTAL ITEM COST
2.01	SITE PREPARATION	LS	1	\$ 10,000.00	\$ 10,000.00
3.01	UNCLASSIFIED EXCAVATION	CY	60	\$ 60.00	\$ 3,600.00
3.07	COMPACTED EMBANKMENT	CY	88	\$ 60.00	\$ 5,280.00
4.01	AGGREGATE BASE COURSE	TON	12	\$ 31.00	\$ 385.67
5.01	TACK COAT	GAL	5	\$ 24.00	\$ 127.20
6.01	ACHM SURFACE COURSE	TON	5	\$ 125.00	\$ 562.50
7.06	CONCRETE DRIVEWAY (6" THICK), STANDARD FINISH	SF	497	\$ 9.58	\$ 4,761.26
8.03	CONCRETE CURB & GUTTER (CLASS 3)	LF	237	\$ 53.00	\$ 12,561.00
10.01	JUNCTION BOX (4')	EA	1	\$ 4,600.00	\$ 4,600.00
10.04A	CURB INLET-4' X8' BOX	EA	1	\$ 7,800.00	\$ 7,800.00
10.07	WING 3' EXTENSION	EA	1	\$ 1,500.00	\$ 1,500.00
13.21RC	STORM DRAIN PIPE, 21" RCP	LF	170	\$ 90.00	\$ 15,300.00
13.21RC	STORM DRAIN PIPE, 24" RCP	LF	62	\$ 90.00	\$ 5,580.00
13.61	TIE TO EXISTING JUNCTION BOX	EA	1	\$ 1,391.00	\$ 1,391.00
14.01	SOLID SODDING (BERMUDA) (INCLUDES 4" TOPSOIL)	SY	350	\$ 12.00	\$ 4,200.00
16.01	MAINTENANCE OF TRAFFIC	LS	1	\$ 4,550.00	\$ 4,550.00
19.01	FINAL CLEAN-UP	LS	1	\$ 2,000.00	\$ 2,000.00
24.01	SILT FENCE - TYPE A (SFA)	LF	267	\$ 10.00	\$ 2,670.00
24.09	SEDIMENT BARRIER, BLOCK (SD4)	EA	1.0	\$ 98.00	\$ 98.00
26.01	TRENCH & EXCAVATION SAFETY	LS	1	\$ 2,750.00	\$ 2,750.00
52.00	PROJECT INFORMATION KIOSK	LS	1	\$ 1,000.00	\$ 1,000.00
SP	RELOCATE COMMUNICATION BOX	EA	1	\$ 1,500.00	\$ 1,500.00

EXISTING	PROPOSED
IRON ROD	PROPOSED CONTOUR
PK NAIL	PROPOSED SPOT ELEVATION
R.R. SPIKE	PROPOSED SPOT CURB ELEVATION
CONC. MONUMENT	STORM SEWER - PIPE
WATER VALVE	STORM SEWER - MITERED END SECTION
WATER METER	STORM SEWER - GRATE INLET
FIRE HYDRANT	STORM SEWER - JUNCTION BOX
GAS METER	STORM SEWER - FLARED END SECTION
GAS VALVE	STORM SEWER - HEADWALL
CLEAN-OUT	STORM SEWER - SINGLE WING
GUARD POST (BOLLARD)	STORM SEWER - DOUBLE WING
SIGN POST	STORM SEWER - AREA INLET
BENCHMARK	GRADE BREAK LINE
STORM SEWER MANHOLE	HIGH POINT
SANITARY SEWER MANHOLE	LOW POINT
TELEPHONE MANHOLE	CUT LINE
ELECTRIC MANHOLE	FILL LINE
TELEPHONE BOX	SANITARY SEWER PIPE
ELECTRIC BOX	SANITARY SEWER MANHOLE
CABLE BOX	PROPOSED CURB
UTILITY POLE	PROPOSED CONCRETE
GUY WIRE	PROPOSED ASPHALT
LIGHT POLE	1-1/2" ASPHALT MILL AND OVERLAY
POST OR POLE (TYPE AS NOTED)	CONSTRUCTION - ENTRANCE/EXIT
MAILBOX	CHECK DAM
DECIDUOUS TREE	DIVERSION BERM
EVERGREEN/CONIFEROUS TREE	DOWNDRAIN STRUCTURE - TEMPORARY
BUSH	ROCK DAM
PROPERTY LINE	SEDIMENT BARRIER - SILT FENCE
SETBACK LINE	SEDIMENT BARRIER - GRAVEL RING
EASEMENT LINE	SEDIMENT BARRIER - BLOCK & GRAVEL
CURB	SEDIMENT BARRIER - BLOCK
FENCE	TEMPORARY SEDIMENT BASIN
OVERHEAD ELECTRIC	SILT FENCE - TYPE A
OVERHEAD TELEPHONE	SILT FENCE - TYPE B
OVERHEAD CABLE	SILT FENCE - TYPE C
UNDERGROUND TELEPHONE	STORM DRAIN OUTLET PROTECTION
UNDERGROUND ELECTRIC	SURFACE ROUGHENING
UNDERGROUND CABLE	DISTURBED AREA STABILIZATION - TEMPORARY STABILIZATION
FIBER OPTIC	DISTURBED AREA STABILIZATION - TEMPORARY GRASSING
WATER LINE	DISTURBED AREA STABILIZATION - PERMANENT GRASSING
SEWER LINE	MATting/BLANKETS
GAS LINE	
STORM SEWER/CULVERT	
EDGE OF WOODS	
CONTOUR LINE	

CITY OF LITTLE ROCK, ARKANSAS
#57TH STREET DRAINAGE
GENERAL NOTES, LEGEND AND QUANTITIES

 DEPARTMENT OF PUBLIC WORKS
 CIVIL ENGINEERING
 701 W. MARKHAM
 LITTLE ROCK, ARKANSAS 72201

60% PRELIMINARY DESIGN

FOR REVIEW ONLY

These documents are for Design Review and not intended for Construction, Bidding or Permit Purposes. They were prepared by, or under the supervision of:

CHRISTIAN VILLARREAL P.E.# 21648 4/1/2024
Date

DRAWN BY
BJ
DESIGNED
BJ
CHECKED
CV
DATE
4/1/2024
SCALE
N.T.S
PROJECT NO.
02-22-DR-06
SHEET NO.
C2

REVISIONS	DATE

CITY OF LITTLE ROCK, ARKANSAS
#57TH STREET DRAINAGE

TYPICAL SECTIONS



DEPARTMENT OF PUBLIC WORKS
CIVIL ENGINEERING
701 W. MARKHAM
LITTLE ROCK, ARKANSAS 72201



DRAWN BY
BJ
DESIGNED
BJ
CHECKED
CV

DATE
4/1/2024
SCALE
NTS

PROJECT NO.
02-22-DR-06

SHEET NO.
C3

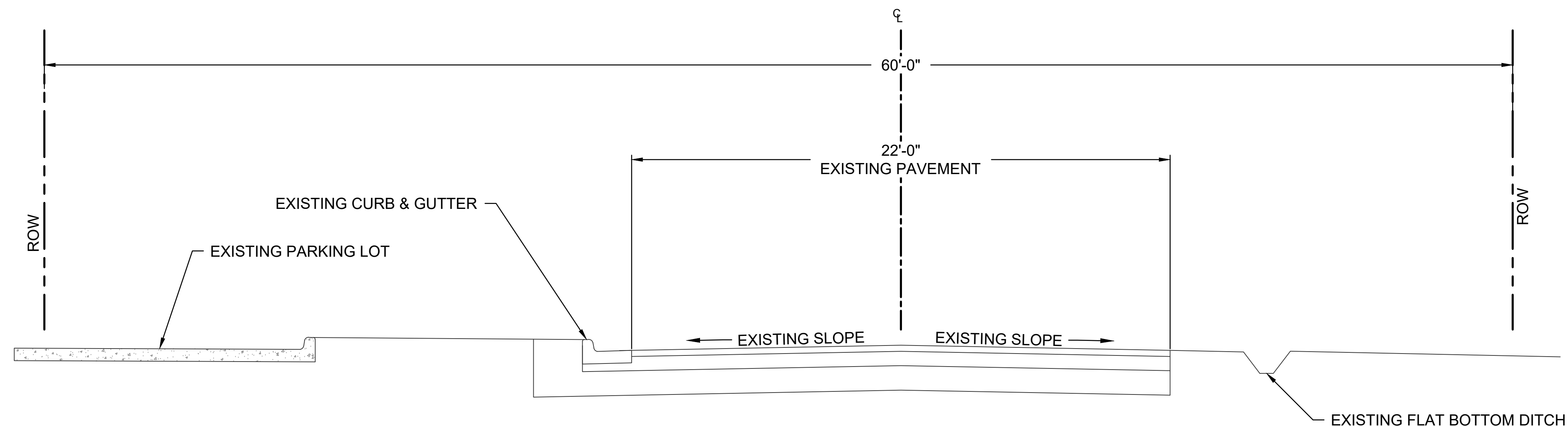

EXISTING TYPICAL SECTION

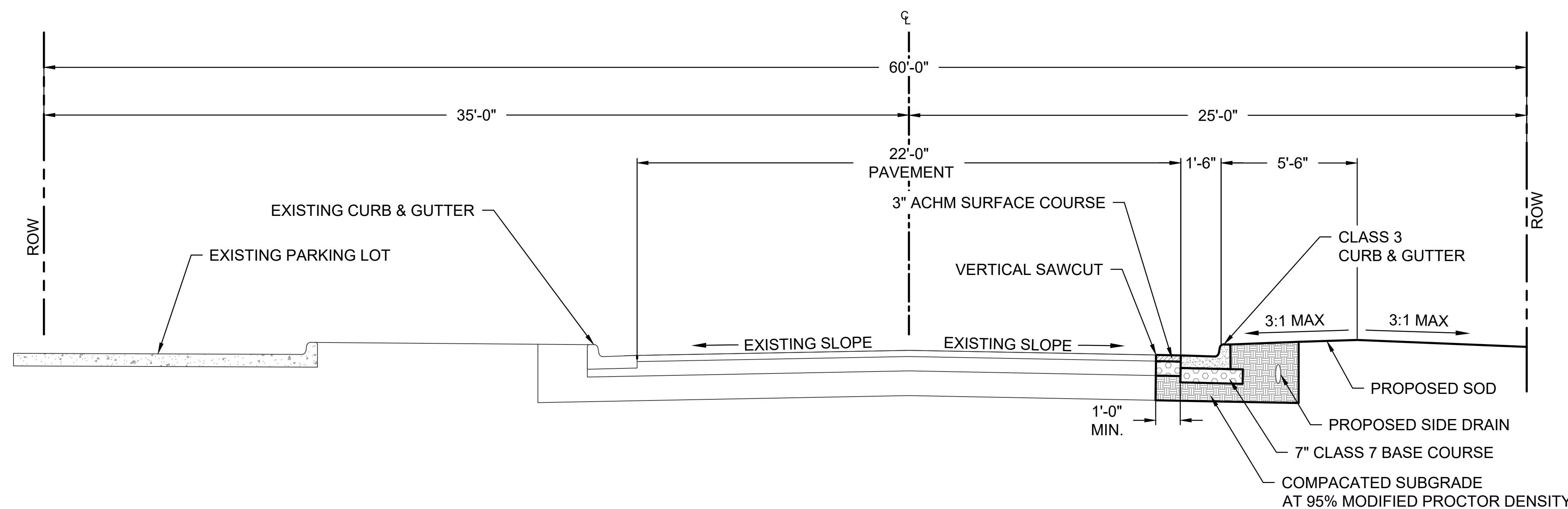

PROPOSED TYPICAL SECTION

60% PRELIMINARY DESIGN

FOR REVIEW ONLY

These documents are for Design Review and not intended for Construction, Bidding or Permit Purposes. They were prepared by, or under the supervision of:

CHRISTIAN VILLARREAL P.E.# 21648 4/1/2024

Date

REVISIONS	DATE

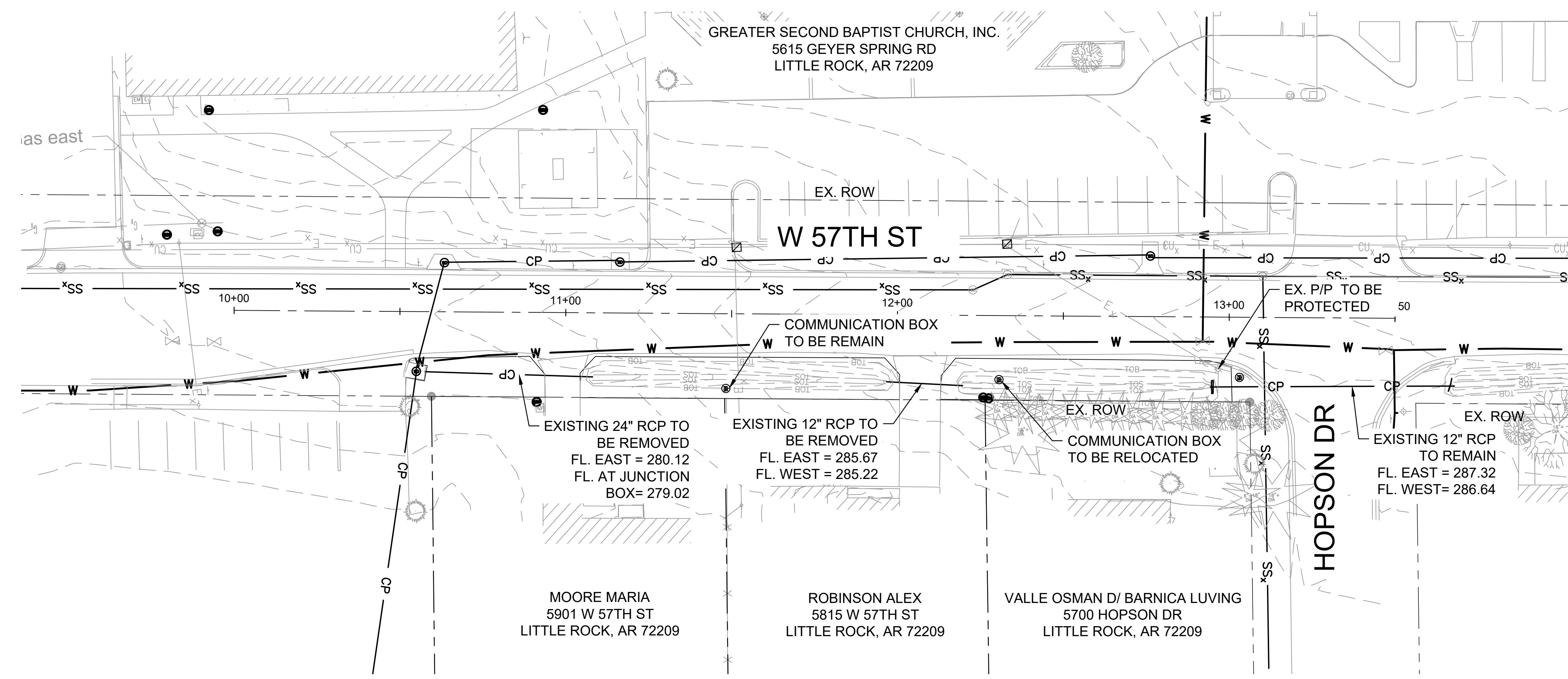
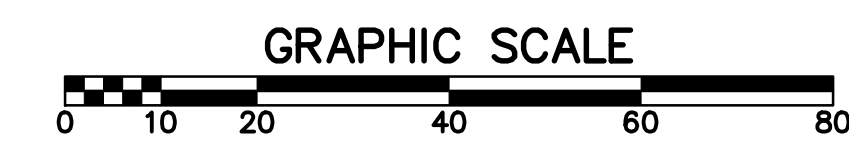
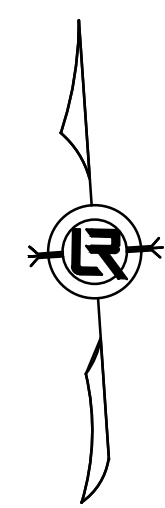

- NOTES:
- REMOVAL OF EXISTING PIPE UNDER DRIVEWAY IS SUBSIDIARY UNDER SITE PREPARATION.

CITY OF LITTLE ROCK, ARKANSAS
 #57TH STREET DRAINAGE
 EXISTING CONDITIONS

DEPARTMENT OF PUBLIC WORKS
 CIVIL ENGINEERING
 701 W. MARKHAM
 LITTLE ROCK, ARKANSAS 72201

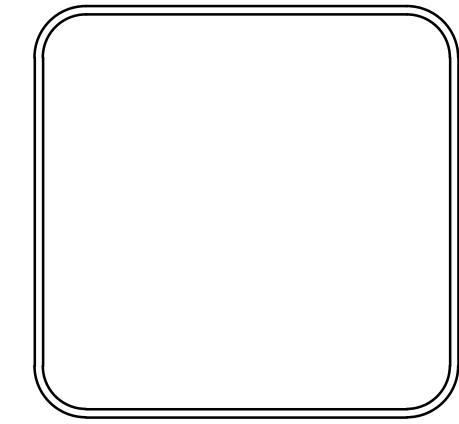

60% PRELIMINARY DESIGN
 FOR REVIEW ONLY
 These documents are for Design Review and not intended for Construction, Bidding or Permit Purposes. They were prepared by, or under the supervision of:
 CHRISTIAN VILLARREAL P.E.# 21648 4/1/2024
 Date

DRAWN BY
 B.J
 DESIGNED
 B.J
 CHECKED
 CV
 DATE
 4/1/2024
 SCALE
 H: 1" = 20' V: 1"=5'
 PROJECT NO.
 02-22-DR-06
 SHEET NO.
 C4

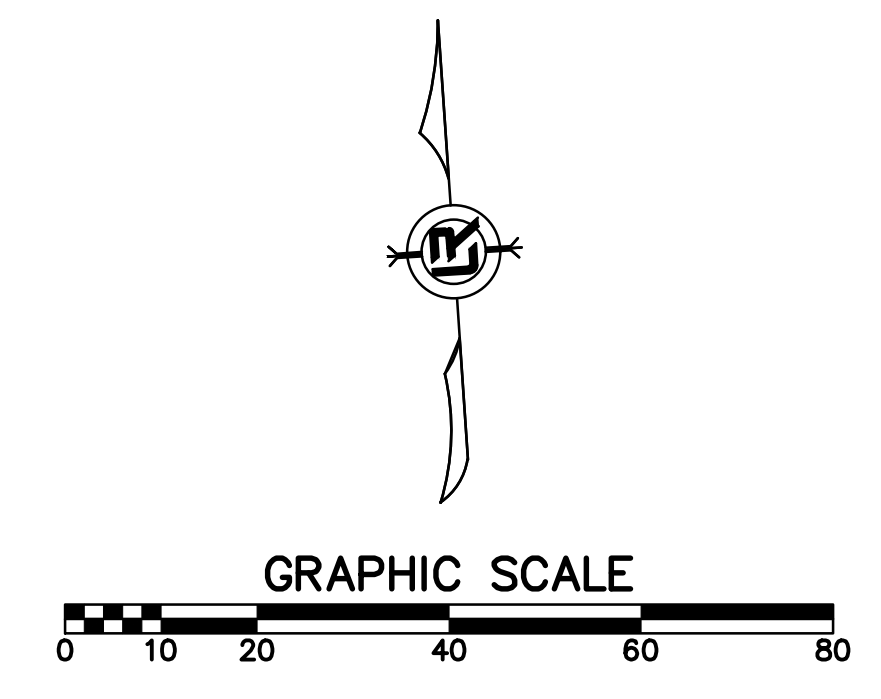
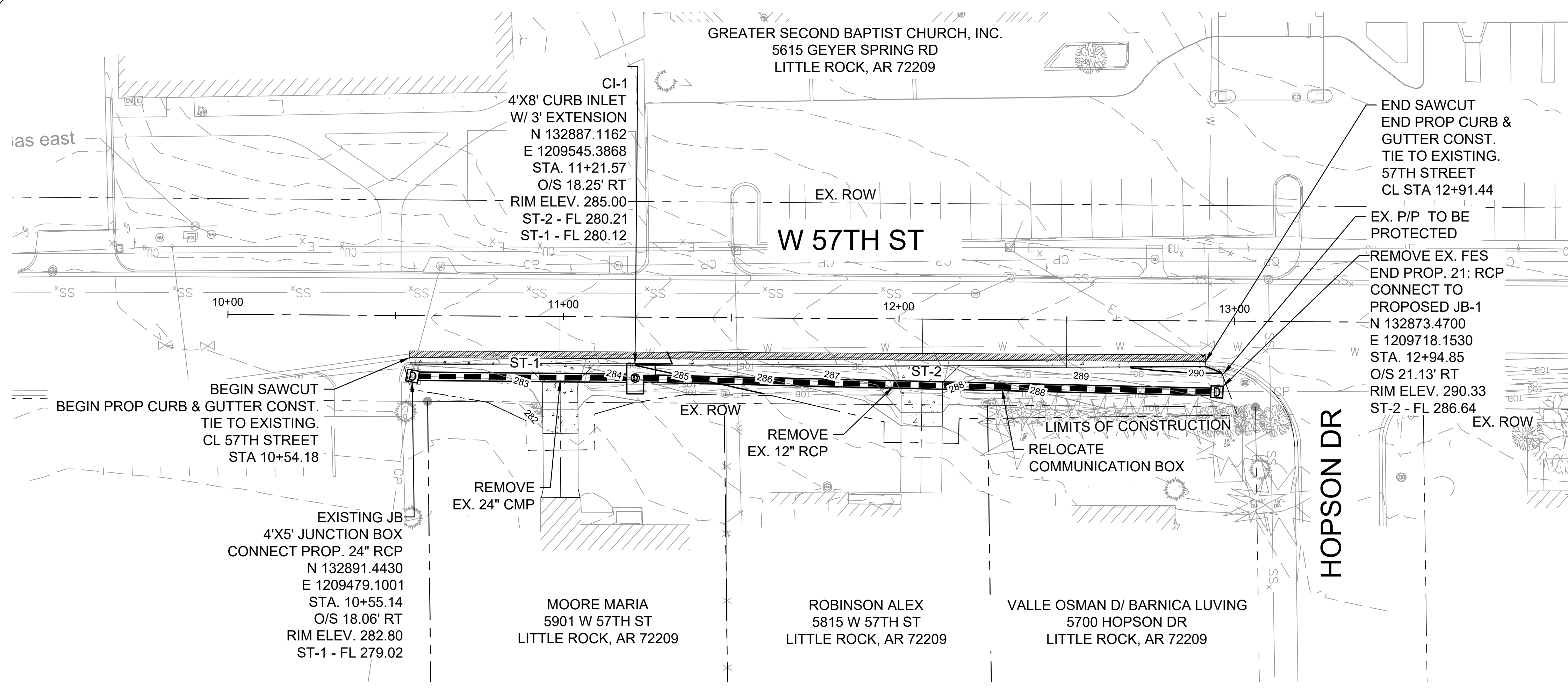

- NOTES:
- REMOVAL OF EXISTING PIPE UNDER DRIVEWAY IS SUBSIDIARY UNDER SITE PREPARATION.

REVISIONS	DATE

CITY OF LITTLE ROCK, ARKANSAS
#57TH STREET DRAINAGE
PLAN & PROFILE

 DEPARTMENT OF PUBLIC WORKS
 CIVIL ENGINEERING
 701 W. MARKHAM
 LITTLE ROCK, ARKANSAS 72201

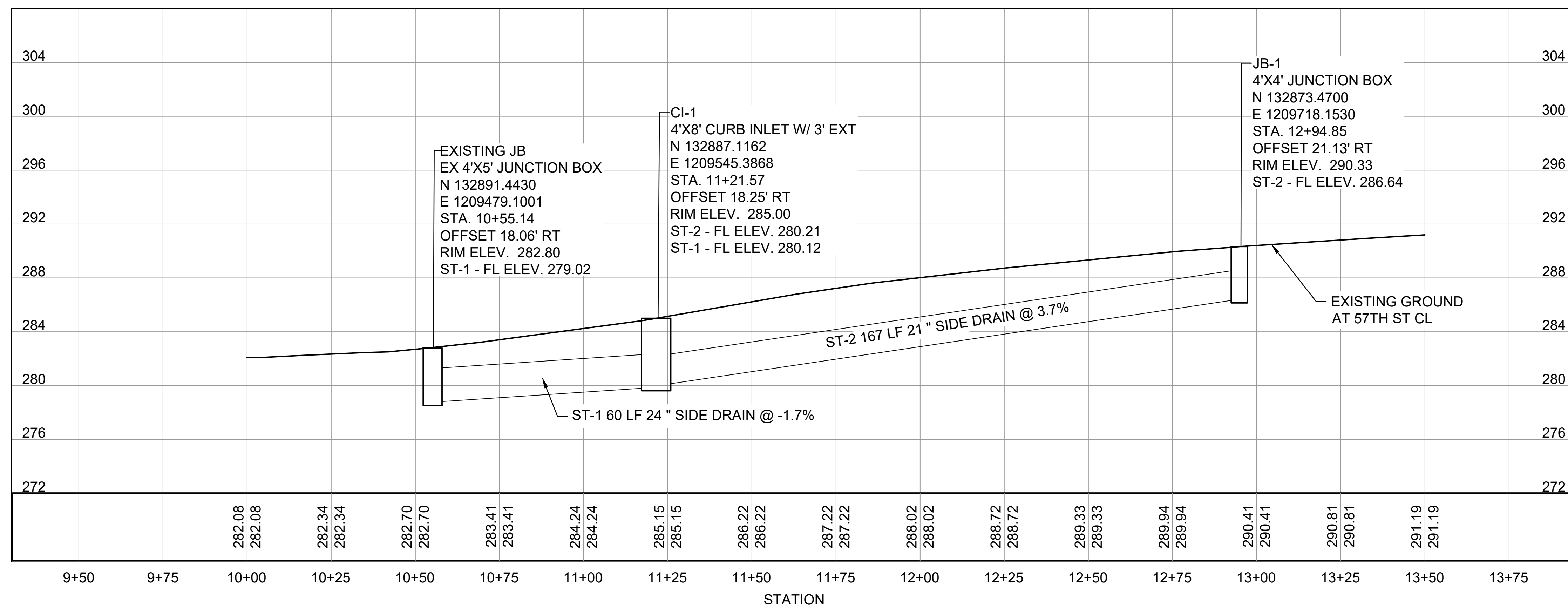

60% PRELIMINARY DESIGN

FOR REVIEW ONLY

These documents are for Design Review and not intended for Construction, Bidding or Permit Purposes. They were prepared by, or under the supervision of:

CHRISTIAN VILLARREAL P.E.# 21648 4/1/24
Date

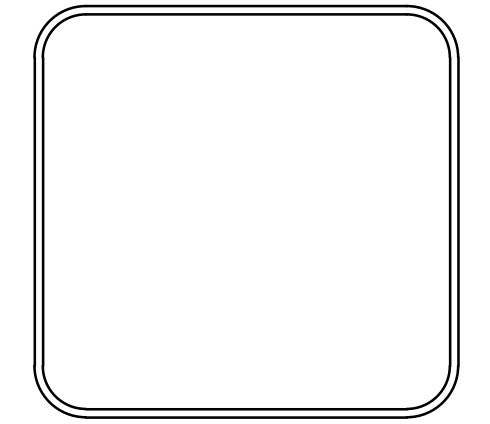

DRAWN BY
 B.J.
 DESIGNED
 B.J.
 CHECKED
 C.V.
 DATE
 4/1/2024
 SCALE
 H: 1" = 20' V: 1" = 5'
 PROJECT NO.
 02-22-DR-06
 SHEET NO.
C5

REVISIONS	DATE

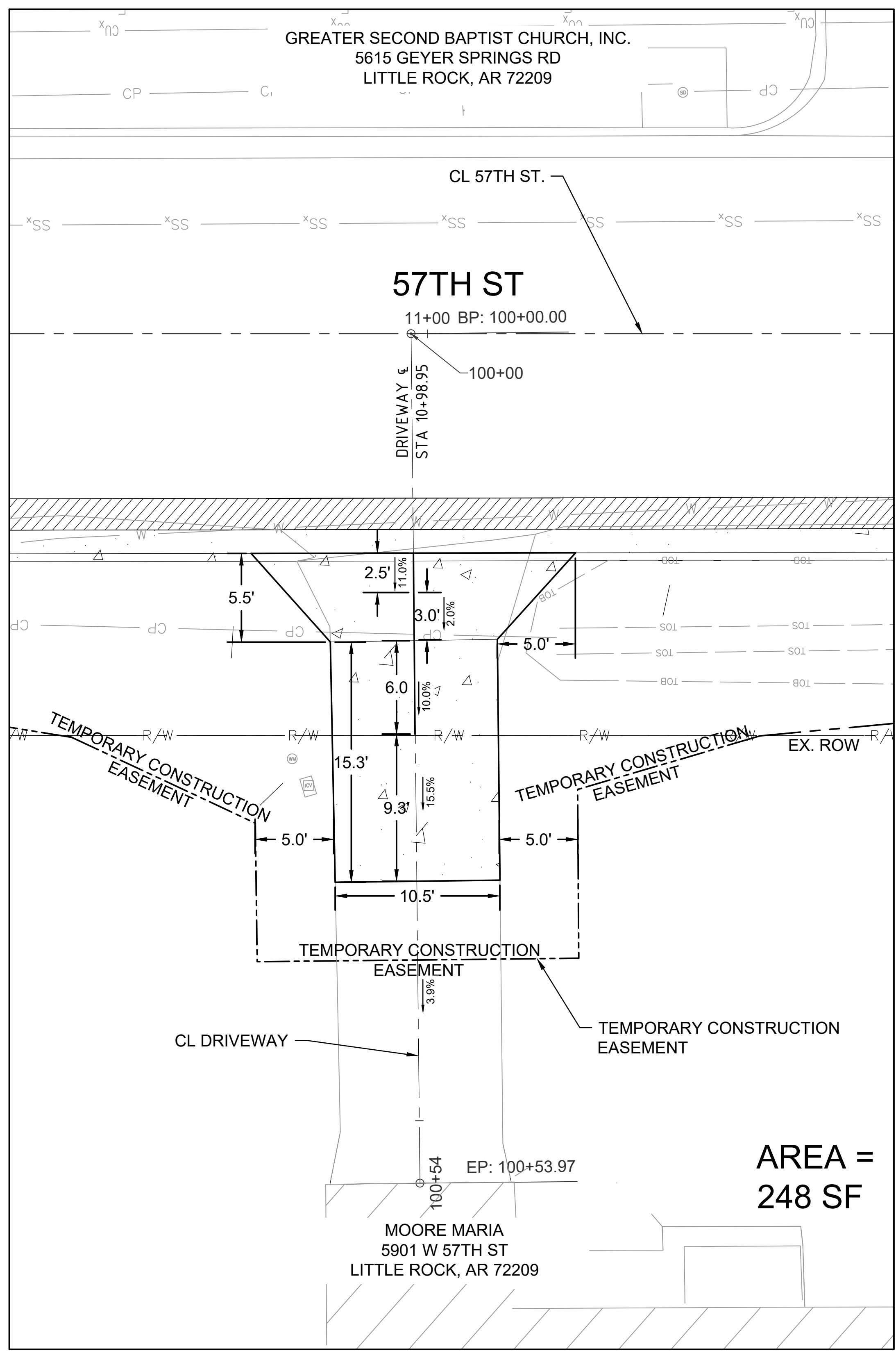

**DRIVEWAY AT
STA 10+98.95**

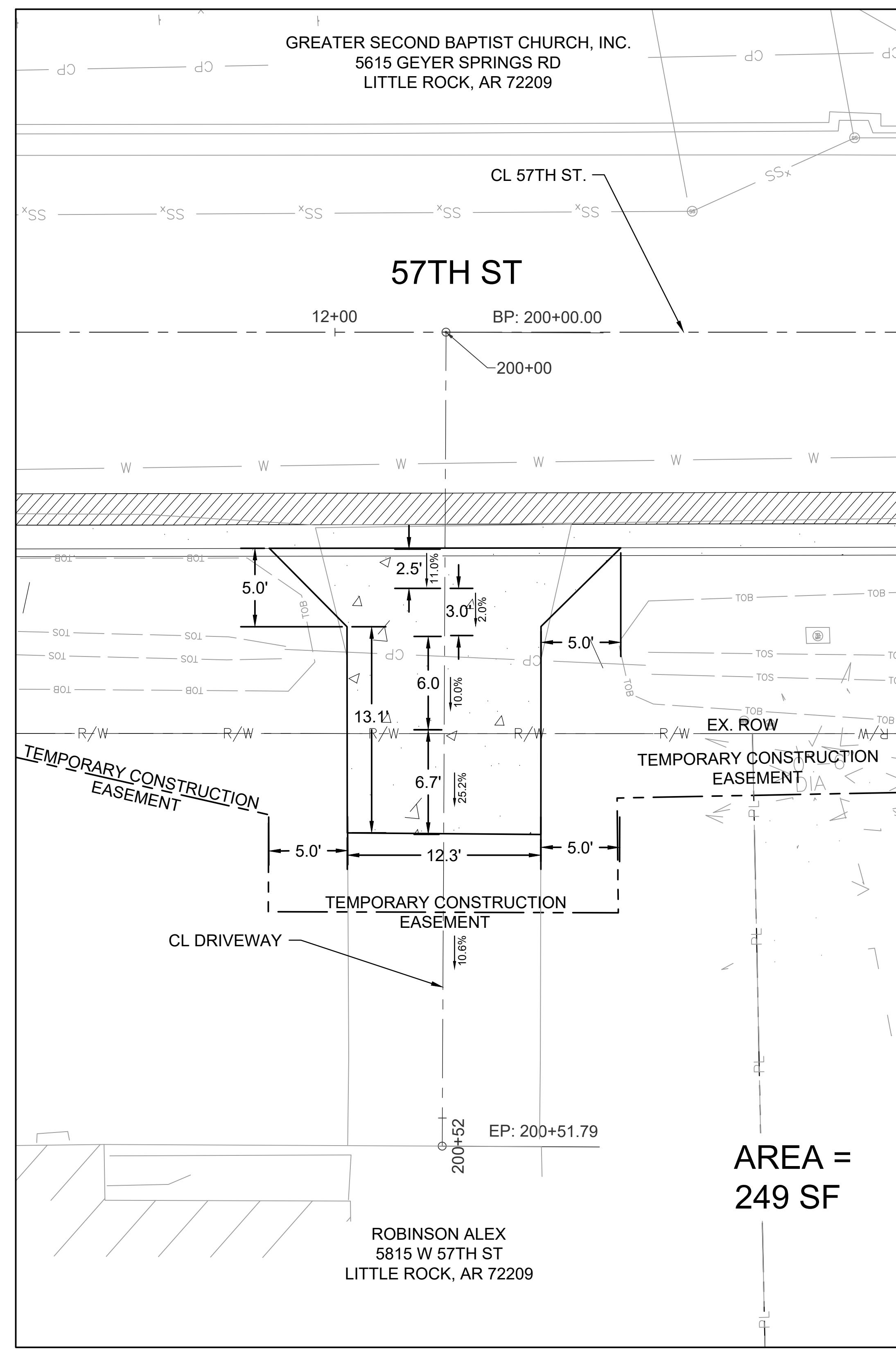

**DRIVEWAY AT
STA 12+07.07**

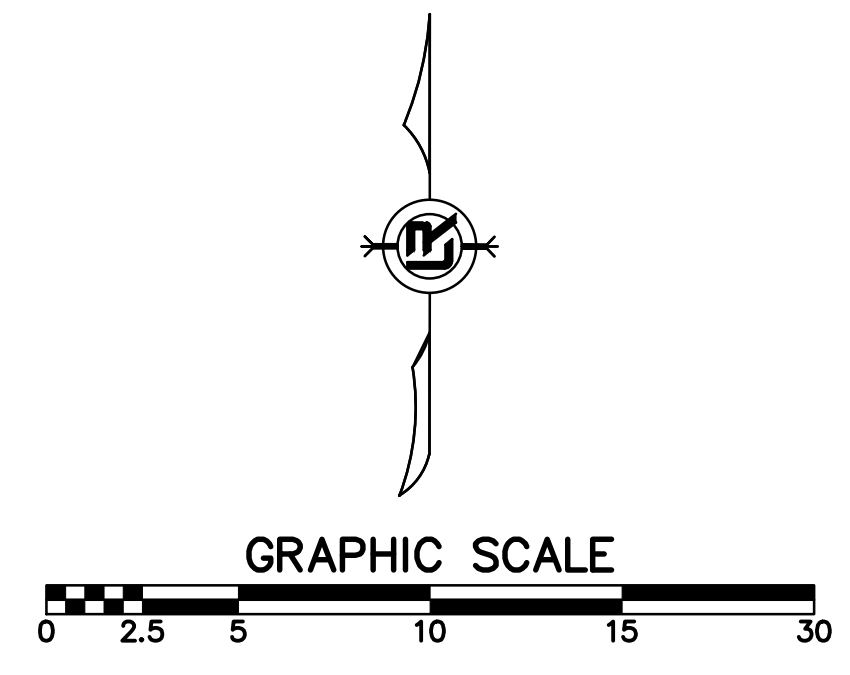

NOTES:
1. ALL DIMENSIONS ARE IN FEET. UNLESS OTHERWISE NOTED.

60% PRELIMINARY DESIGN

FOR REVIEW ONLY

These documents are for Design Review and not intended for Construction, Bidding or Permit Purposes. They were prepared by, or under the supervision of:
CHRISTIAN VILLARREAL P.E.# 21648 4/1/24
Date

CITY OF LITTLE ROCK, ARKANSAS
#57TH STREET DRAINAGE
DRIVEWAY DETAILS

DEPARTMENT OF PUBLIC WORKS
CIVIL ENGINEERING
701 W. MARKHAM
LITTLE ROCK, ARKANSAS 72201

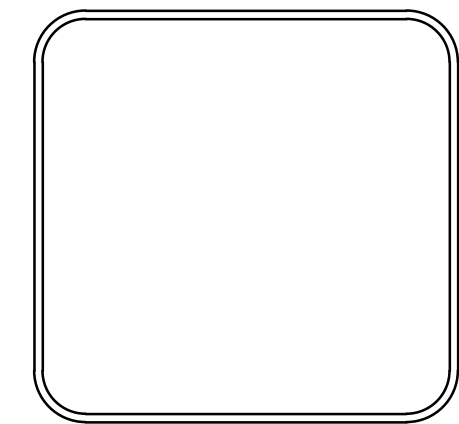

DRAWN BY
BJ
DESIGNED
BJ
CHECKED
CV
DATE
4/1/2024
SCALE
1" = 5'
PROJECT NO.
02-22-DR-06
SHEET NO.
C6

REVISIONS	DATE

CITY OF LITTLE ROCK, ARKANSAS
#57TH STREET DRAINAGE

CROSS SECTION



DEPARTMENT OF PUBLIC WORKS
CIVIL ENGINEERING
701 W. MARKHAM
LITTLE ROCK, ARKANSAS 72201

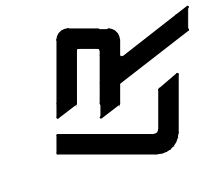

DRAWN BY BJ
DESIGNED BJ
CHECKED CV
DATE 4/1/2024
SCALE 1" = 10' H, 1" = 5V
PROJECT NO. 02-22-DR-06
SHEET NO. C7

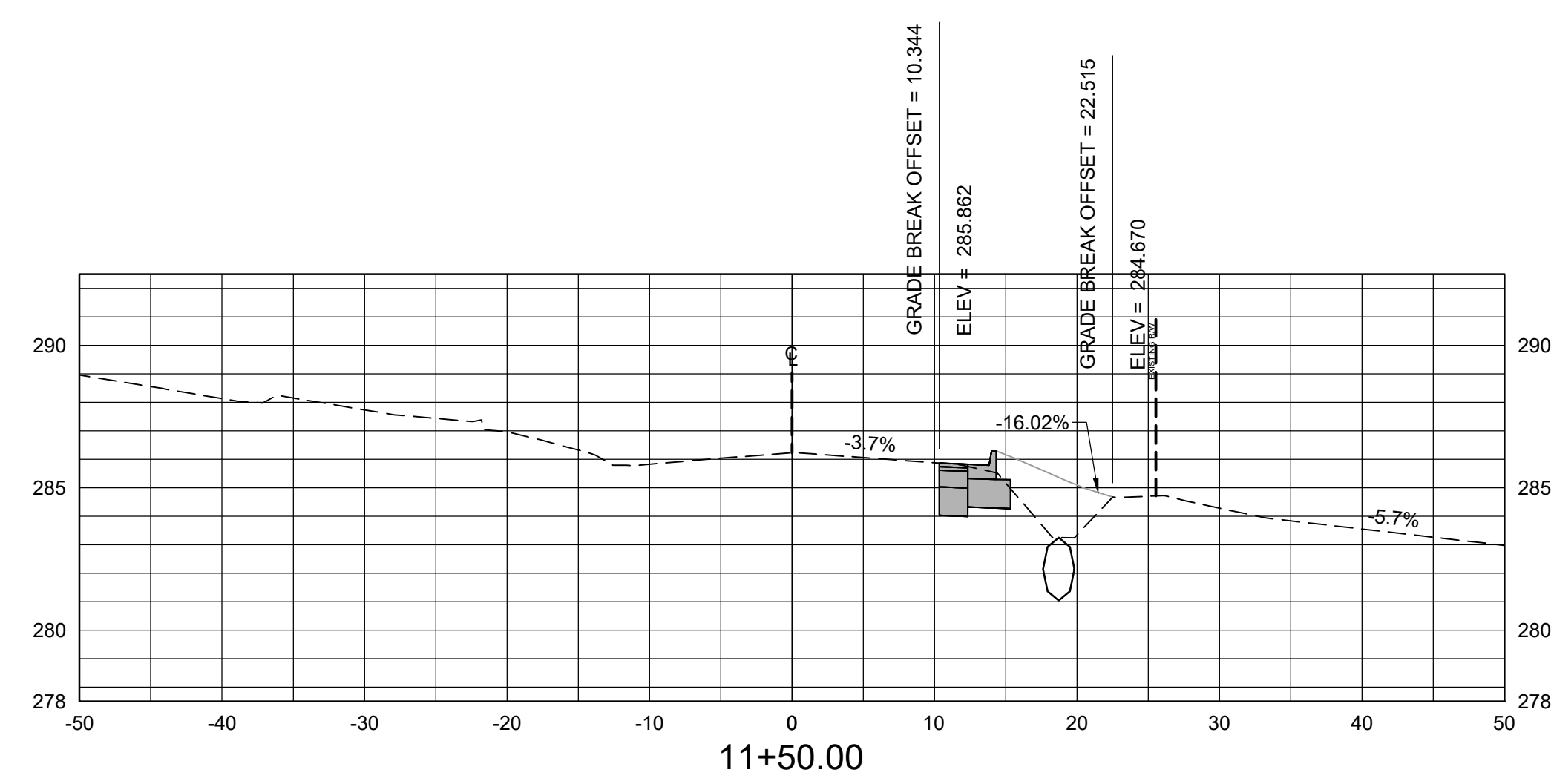

Total Volume at Station 11+50.00	
Cut Area	7.26
Fill Area	12.10
Cut Vol	15.30
Fill Vol	20.64
Cum Cut Vol	23.87
Cum Fill Vol	30.09
Net Vol	-6.22

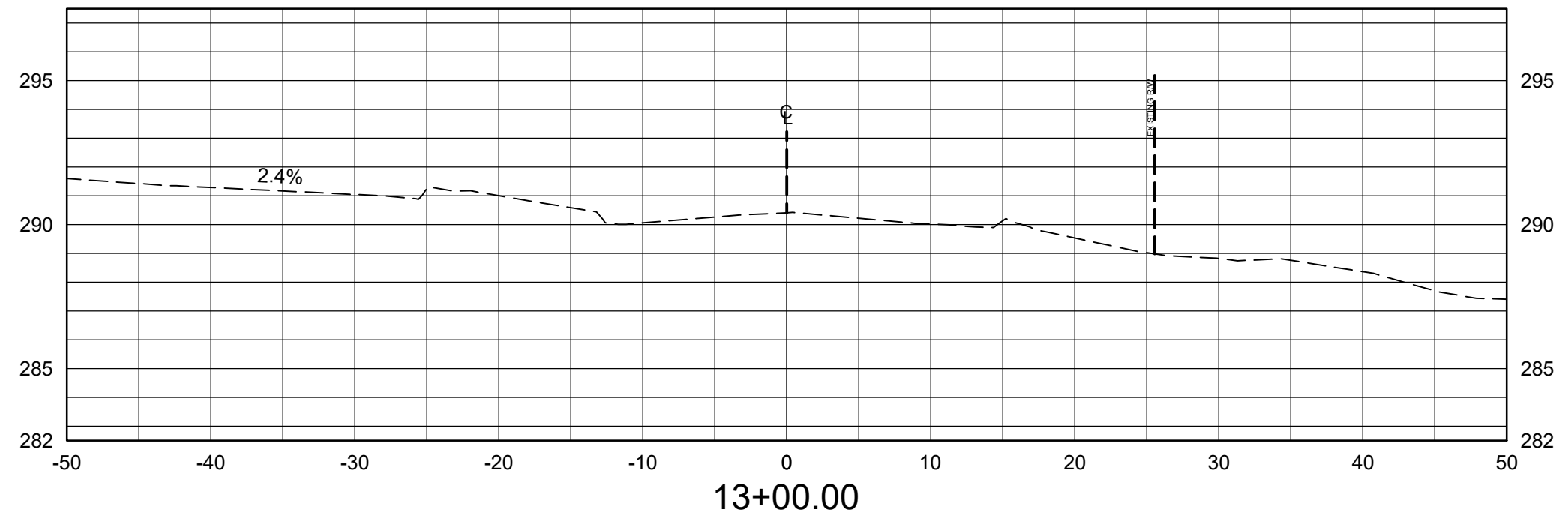

Total Volume at Station 13+00.00	
Cut Area	0.00
Fill Area	0.00
Cut Vol	7.31
Fill Vol	10.61
Cum Cut Vol	60.44
Cum Fill Vol	87.67
Net Vol	-27.23

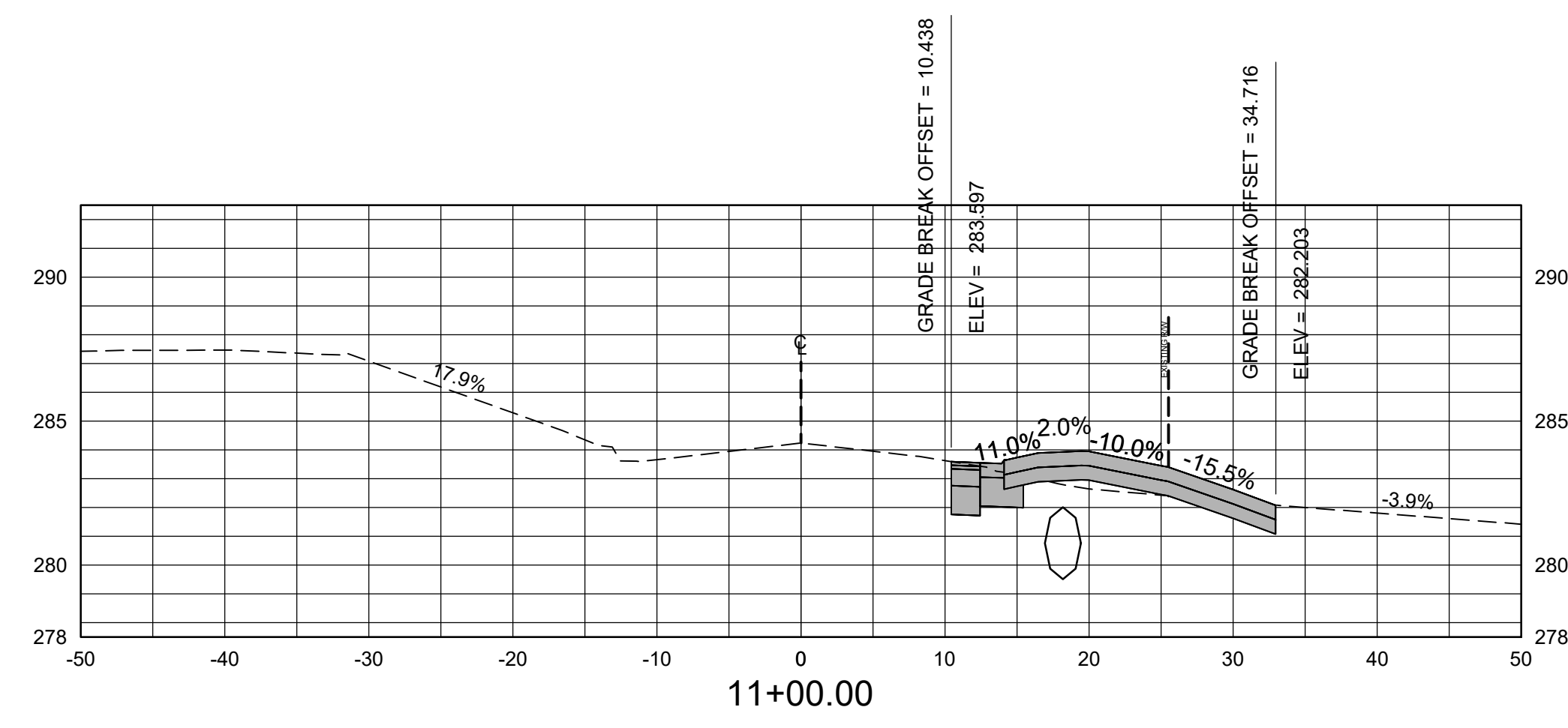

Total Volume at Station 11+00.00	
Cut Area	9.26
Fill Area	10.20
Cut Vol	8.57
Fill Vol	9.44
Cum Cut Vol	8.57
Cum Fill Vol	9.44
Net Vol	-0.87

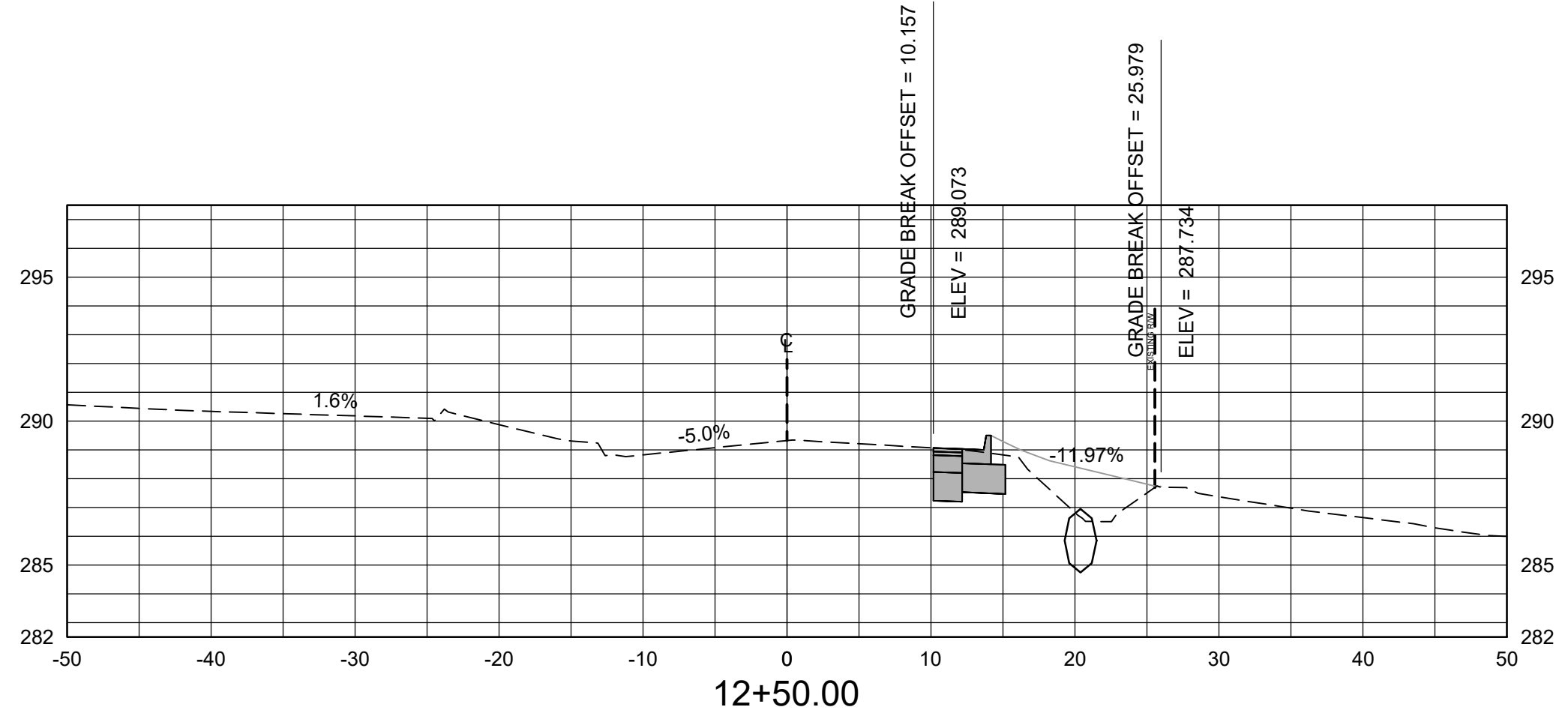

Total Volume at Station 12+50.00	
Cut Area	7.89
Fill Area	11.46
Cut Vol	14.92
Fill Vol	23.19
Cum Cut Vol	53.14
Cum Fill Vol	77.06
Net Vol	-23.93

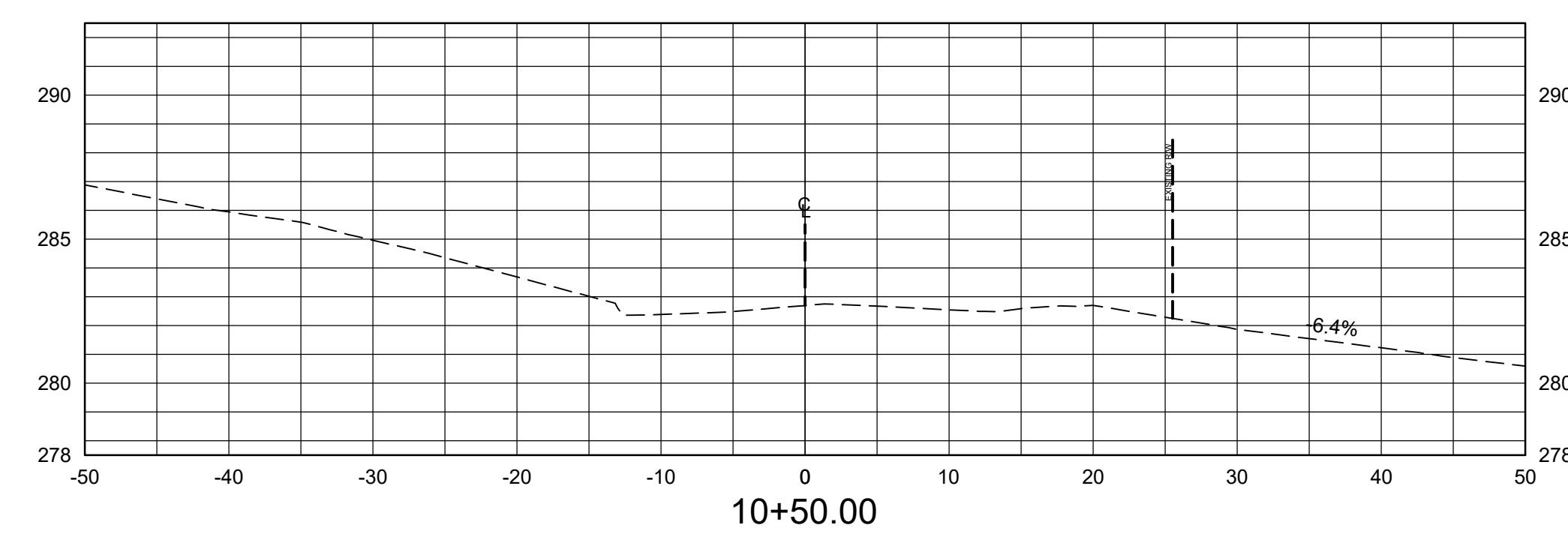

Total Volume at Station 10+50.00	
Cut Area	0.00
Fill Area	0.00
Cut Vol	0.00
Fill Vol	0.00
Cum Cut Vol	0.00
Cum Fill Vol	0.00
Net Vol	0.00

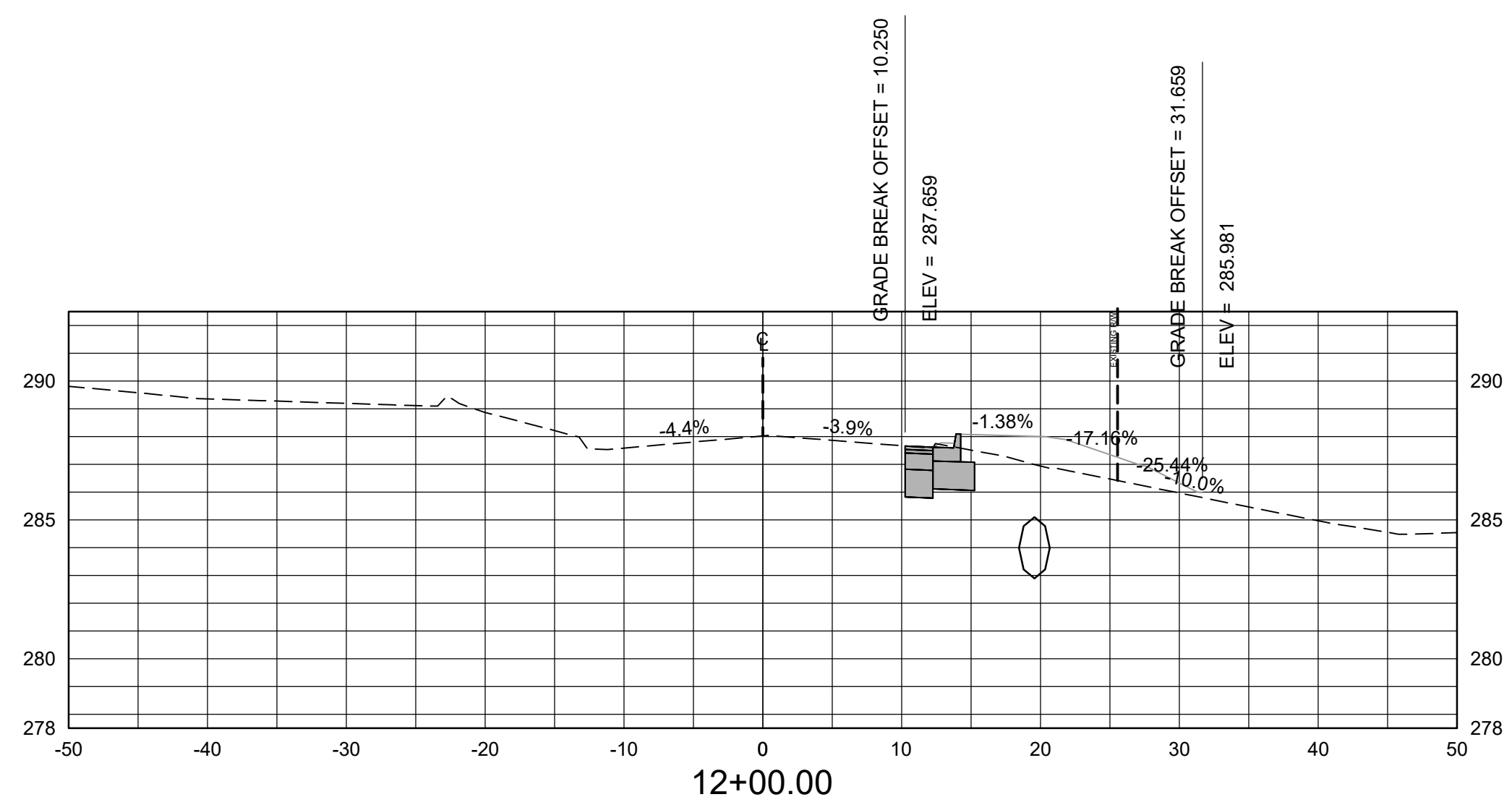

Total Volume at Station 12+00.00	
Cut Area	8.23
Fill Area	13.59
Cut Vol	14.34
Fill Vol	23.79
Cum Cut Vol	38.21
Cum Fill Vol	53.87
Net Vol	-15.66

60% PRELIMINARY DESIGN

FOR REVIEW ONLY
These documents are for Design Review and not intended for Construction, Bidding or Permit Purposes. They were prepared by, or under the supervision of:
CHRISTIAN VILLARREAL P.E.# 21648 4/1/2024
Date

SURVEY CONTROL POINTS LARCH ROAD							
POINT	DESCRIPTION	NORTHING	EASTING	ELEVATION	BASELINE REFERENCE	BASELINE STATION	BASELINE OFFSET
C/P #1	ALUMINUM MONUMENT 3' FROM BACK OF SOUTH CURB ON W. 57TH ST. AND 56' FROM BACK OF EAST CURB OF GEYER SPRINGS RD.	132893.5420	1209314.1830	281.38	W. 57TH ST.	N/A	25.47 RT
C/P #2	ALUMINUM MONUMENT ON THE NORTH SIDE OF W. 57TH ST.	132934.4470	1209546.5620	286.91	W. 57TH ST.	11+19.77	29.03 LT
C/P #3	ALUMINUM MONUMENT 8.5' FROM BACK OF SOUTH CURB ON W. 57TH ST. AND 111.5' FROM BACK OF EAST CURB OF GEYER SPRINGS RD.	133566.8902	1213365.8978	269.61	W. 57TH ST.	N/A	31.29 RT
C/P #4	ALUMINUM MONUMENT ON THE NORTH SIDE OF W. 57TH ST.	132913.6850	1209723.1460	290.95	W. 57TH ST.	12+97.29	19.27 LT
C/P #6	ALUMINUM MONUMENT WEST SIDE OF HOPSON DR.	132860.8010	1209737.8490	289.01	W. 57TH ST.	13+15.28	32.54 RT
C/P #7	ALUMINUM MONUMENT NORTH SIDE OF GREATER 2ND BAPTIST'S CONCRETE SIDEWALK	132983.6660	1209535.5230	288.79	W. 57TH ST.	11+05.71	77.49 LT
C/P #8	ALUMINUM MONUMENT ON THE NORTH SIDE OF W. 57TH ST.	132916.7660	1209678.9480	290.03	W. 57TH ST.	12+53.01	19.63 LT

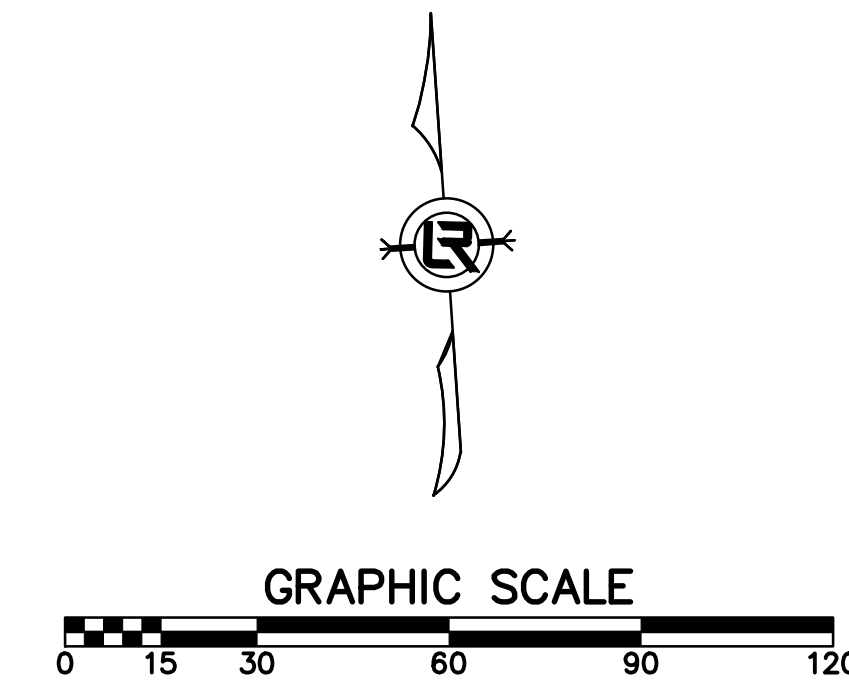

REVISIONS	DATE

CITY OF LITTLE ROCK, ARKANSAS
#57TH STREET DRAINAGE
PROJECT LAYOUT

 DEPARTMENT OF PUBLIC WORKS
 CIVIL ENGINEERING
 701 W. MARKHAM
 LITTLE ROCK, ARKANSAS 72201

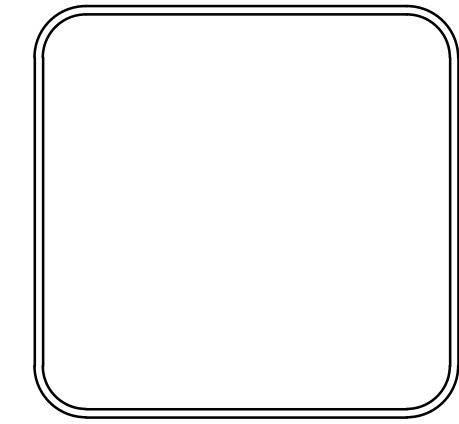

DRAWN BY
 BJ
 DESIGNED
 BJ
 CHECKED
 CV
 DATE
 4/1/2024
 SCALE
 1" = 30'
 PROJECT NO.
 02-22-DR-06
 SHEET NO.
C8

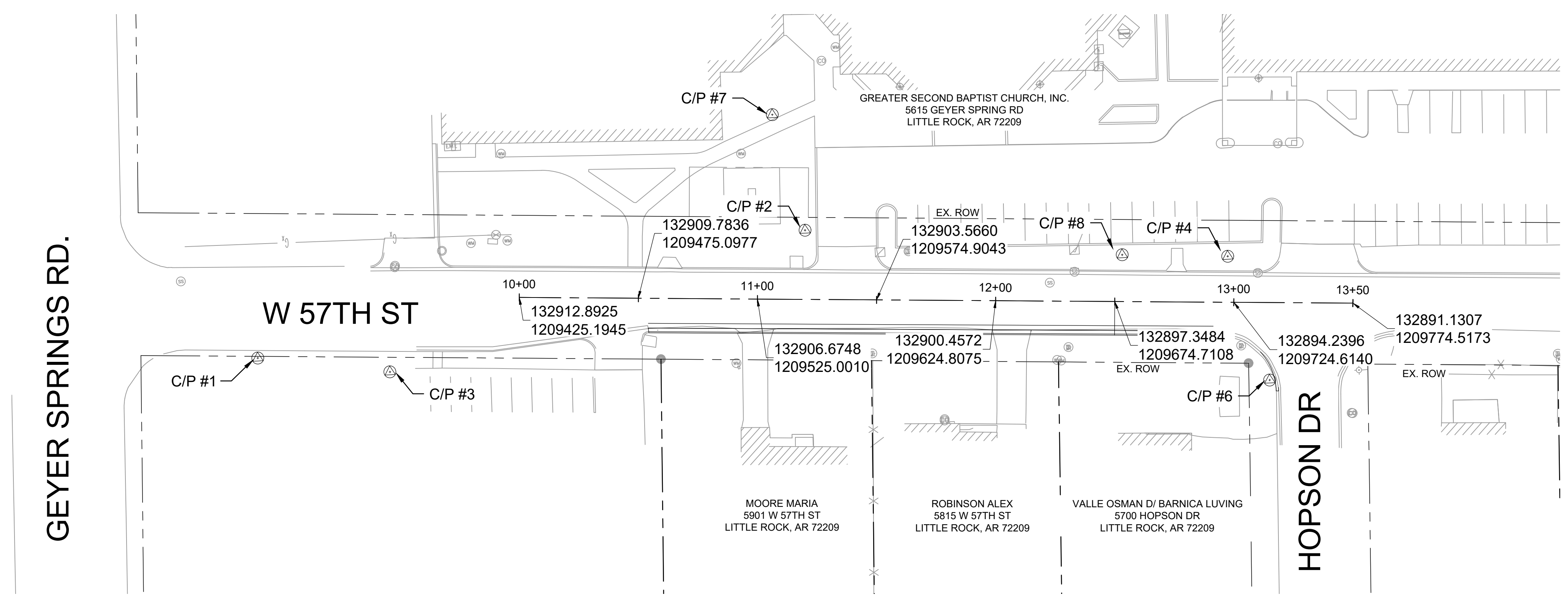

60% PRELIMINARY DESIGN

FOR REVIEW ONLY

These documents are for Design Review and not intended for Construction, Bidding or Permit Purposes. They were prepared by, or under the supervision of:

CHRISTIAN VILLARREAL P.E.# 21648 4/1/24
Date

GEYER SPRINGS RD.

HOPSON DR

REVISIONS	DATE

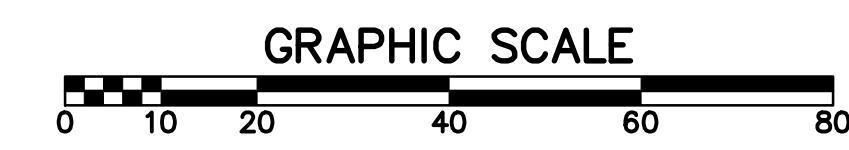
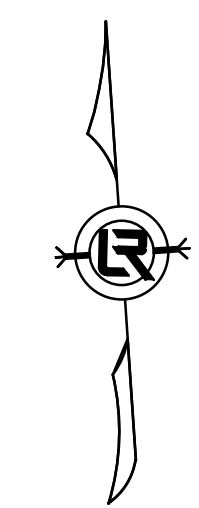

PHASING LEGEND
 PHASE 1 (INITIAL STRIP AND DEMOLITION)
 PHASE 2 (NEW DRAINAGE, CURB, ASPHALT, AND DRIVEWAY APRON CONSTRUCTED)
 PHASE 3 (RESTORE DISTURBED AREAS WITH SOD)

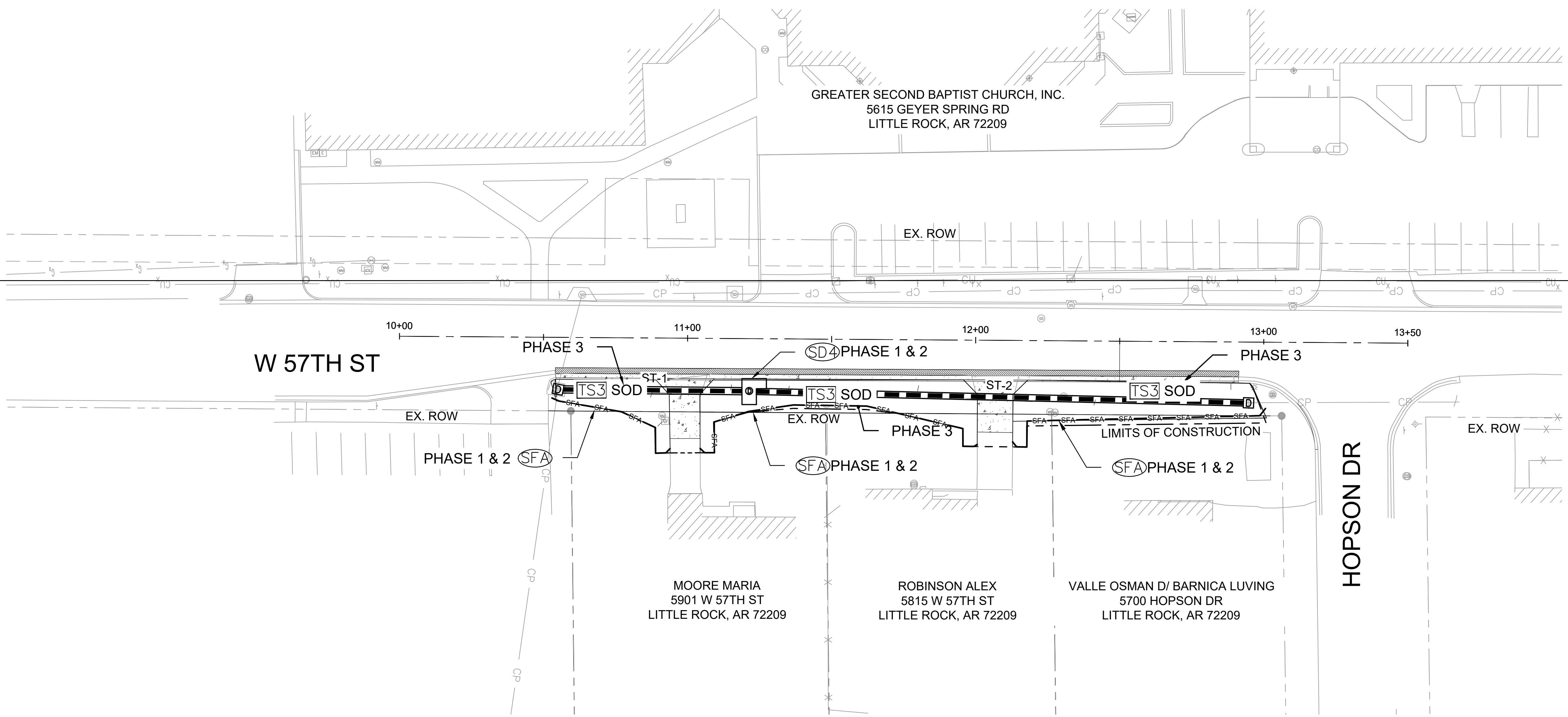

60% PRELIMINARY DESIGN

FOR REVIEW ONLY
 These documents are for Design Review and not intended for Construction, Bidding or Permit Purposes. They were prepared by, or under the supervision of:
 CHRISTIAN VILLARREAL P.E.# 21648 4/1/24
 Date

CITY OF LITTLE ROCK, ARKANSAS
 #57TH STREET DRAINAGE
 EROSION CONTROL

DEPARTMENT OF PUBLIC WORKS
 CIVIL ENGINEERING
 701 W. MARKHAM
 LITTLE ROCK, ARKANSAS 72201

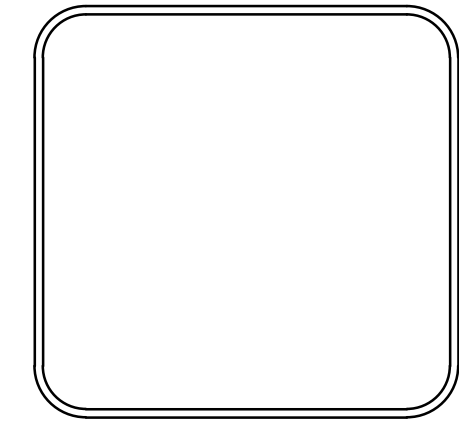

DRAWN BY
 B.J.
 DESIGNED
 B.J.
 CHECKED
 C.V.
 DATE
 4/1/2024
 SCALE
 1" = 20'
 PROJECT NO.
 02-22-DR-06
 SHEET NO.
 C9