

# PLANTATION DRIVE SEDIMENT REMOVAL

## CITY of LITTLE ROCK

LITTLE ROCK, ARKANSAS

MAY 2018

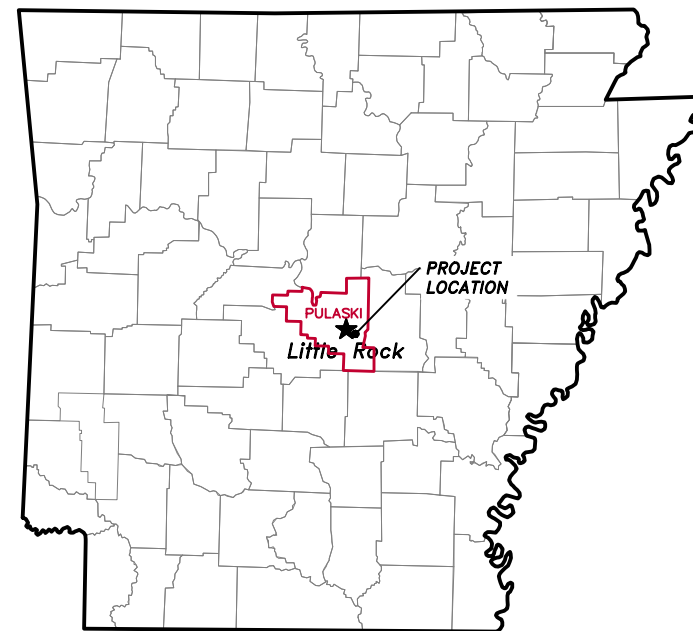

INDEX OF DRAWINGS	
SHT NO.	TITLE
1	EXISTING SITE SURVEY WITH AERIAL
2	PROPOSED SITE LAYOUT (SHEET 1 OF 2)
3	PROPOSED SITE LAYOUT (SHEET 2 OF 2)
4	FLOWAGE EASEMENT LAND AREA
5	PROFILES
6	PROFILES
7	ADJACENT PROPERTY OWNER MAP
8	DETAILS



Know what's below.  
Call before you dig.



PROJECT NO. LITT-8957



**ISSUED FOR CONSTRUCTION**





TOP OF EXPOSED 12"  
CONCRETE PIPE  
ELEV. 232.25

CONTROL POINT  
1/2" REBAR  
ELEV. 238.87'

MANHOLE  
(TYPE UNKNOWN)

FOURCHE CREEK

ARKANSAS RIVER

Plantation Dr

TOP OF 48" CMP  
ELEV. 235.74'  
(FL RUSTED OUT)

STORM WATER  
MANHOLE  
RIM ELEV. 247.32'

Pickett Dr

Longstreet Dr

NOTE:  
ELEVATIONS AND COORDINATES ARE BASED ON  
NAVD88 AND ARKANSAS STATE PLANE NORTH ZONE



© 2013 Google

STATE OF ARKANSAS REGISTERED PROFESSIONAL ENGINEER No. 7040 WILLIAM D. FORD	
PLANTATION DRIVE SEDIMENT REMOVAL CITY OF LITTLE ROCK	
LITTLE ROCK, ARKANSAS	
EXISTING SITE SURVEY WITH AERIAL	REVISIONS: NO. DATE DESCRIPTION BY:
CIVIL AND ENVIRONMENTAL ENGINEERING SERVICES 5212 SHACKERS RD LITTLE ROCK, ARKANSAS 72206 PE (501) 221-7122 FX (501) 221-7775	DESIGNED BY: B/W PLOT DATE: 5/8/2018 DRAWN BY: JAB CHECKED BY: WDF
JOB NUMBER: LITT-8957	SCALE: 1" = 150' FILE: L:\LITTLE ROCK, CITY OF\UIT-8957\PLANTATION DRIVE SEDIMENT REMOVAL\DRAWINGS\01-05 SITE LAYOUT - SITE PLANS & PROFILES.DWG
SHEET NO.:	1





NORTH LEVEE  
(405 yd<sup>3</sup> FILL)

VOLUME AVAILABLE  
BETWEEN LEVEES:  
(≈11,227 yd<sup>3</sup>)

SOUTH LEVEE  
(830 yd<sup>3</sup> FILL)

CORPS OF ENGINEERS  
FLOWAGE EASEMENT LINE  
(FROM COE "EXHIBIT A")

VOLUME TO BE  
REMOVED:  
(≈11,537 yd<sup>3</sup>)

CORPS OF ENGINEERS  
AREA OF DISPOSITION  
(FROM COE "EXHIBIT A")

CORPS CHANNEL  
RECTIFICATION EASEMENT  
(FROM COE "EXHIBIT A")

MATCH LINE  
SHEET 3



PLANTATION DRIVE SEDIMENT REMOVAL  
CITY OF LITTLE ROCK  
LITTLE ROCK, ARKANSAS

SHEET TITLE: PROPOSED SITE LAYOUT (SHEET 1 OF 2)

NO.	DATE	REVISIONS:
		DESCRIPTION:

CIVIL AND ENVIRONMENTAL  
ENGINEERING SERVICES  
321 SOUTH SHARKEY ST. #200  
LITTLE ROCK, ARKANSAS 72206  
PH: (501) 221-7122 FX: (501) 221-7775

DESIGNED BY: B.W. PLOT DATE: 5/8/2018  
DRAWN BY: JAB  
CHECKED BY: WDF

SCALE: 1" = 100'

FILE: L:\LITTLE ROCK, CITY OF\11-8957 PLANTATION DRIVE SEDIMENT REMOVAL\DRAWINGS\04-05 ALTERNATIVE SITE LAYOUT - SITE PLANS.DWG

JOB NUMBER:  
LITT-8957

SHEET NO.: 2



CORPS CHANNEL  
RECTIFICATION EASEMENT  
(FROM COE "EXHIBIT A")

MATCH LINE  
SHEET 2



ARKANSAS RIVER

VOLUME TO BE  
REMOVED:  
(≈11,537 yd³)

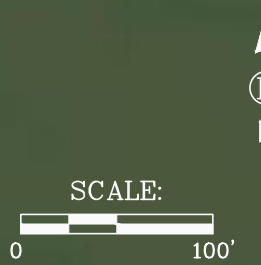

© 2013 Google

PLANTATION DRIVE SEDIMENT REMOVAL  
CITY OF LITTLE ROCK  
LITTLE ROCK, ARKANSAS

SHEET TITLE: PROPOSED SITE LAYOUT  
(SHEET 2 OF 2)

NO.	DATE	DESCRIPTION

CIVIL AND ENVIRONMENTAL  
ENGINEERING SERVICES  
5212 W. SHILOH RD  
LITTLE ROCK, AR 72206  
PMI PE (501) 221-7122 FX (501) 221-7775

DESIGNED BY: BJW PLOT DATE: 5/8/2018  
DRAWN BY: JAB  
CHECKED BY: WDF

SCALE: 1" = 100'

FILE: L:\LITTLE ROCK, CITY OF\UTL-8957 PLANTATION DRIVE SEDIMENT REMOVAL\DRAWINGS\04-05 ALTERNATE SITE LAYOUT - SITE PLANS.DWG

JOB NUMBER:  
LITT-8957

SHEET NO.: 3





**LEGEND:**  
 — AREA AVAILABLE FOR FILL MATERIAL  
 ▨ AREA OF CORPS OF ENGINEERS FLOWAGE ESTIMATE

EXISTING 12" CONCRETE PIPE  
 ELEV. 232.25  
 (FIELD VERIFY)  
 ABANDON IN PLACE

EXISTING MANHOLE  
 RAISE TO ELEV. 241.00  
 (FIELD VERIFY)

NORTH LEVEE

FOURCHE CREEK

ELEV. = 231.0

ELEV. = 234.0

AREA 2 = 3,889 SF

AREA 1 = 6,110 SF

ELEV. = 240.0  
 (TOP OF FILL AREA)

SOUTH LEVEE

**GENERAL NOTES:**

1. THE CONTRACTOR SHALL NOTIFY ARKANSAS ONE CALL PRIOR TO ANY EXCAVATION OR FILL.
2. THE CONTRACTOR SHALL CLEAR THE TREES FROM THE AREA OF FILL. THE TREES MAY BE BURIED WITHIN THE AREA OF THE FILL.
3. THE EMBANKMENT MATERIAL FOR THE NORTH AND SOUTH LEVEE SHALL BE SELECT MATERIAL CAPABLE OF BEING COMPACTED TO 95% STANDARD PROCTOR DENSITY. SELECT MATERIAL SHALL BE CLASSIFIED AS MH OR CH MATERIAL UNDER THE UNIFIED SOIL CLASSIFICATION SYSTEM. THE CONTRACTOR IS RESPONSIBLE FOR SUPPLYING THE LEVEE EMBANKMENT MATERIAL. THE CONTRACTOR SHALL IDENTIFY SITES PROPOSED TO OBTAIN BORROW MATERIAL FOR LEVEE EMBANKMENTS. THE BORROW SITES SHALL BE MADE ACCESSIBLE FOR OBSERVATION BY CITY PERSONNEL. CONTRACTOR SHALL PROVIDE THE RESULTS OF GEOTECHNICAL TESTING OF PROPOSED EMBANKMENT MATERIAL INDICATING THE SUITABILITY OF PROPOSED MATERIAL.
4. THE FILL MATERIAL BETWEEN THE LEVEES SHALL BE DREDGED MATERIAL FROM THE CHANNEL DREDGING. THE CONTRACTOR SHALL PLACE THE DREDGED MATERIAL IN A MANNER TO ALLOW DEWATERING OF THE MATERIAL.
4. THE FILL MATERIAL BETWEEN THE LEVEES SHALL BE DREDGED MATERIAL FROM THE CHANNEL DREDGING. THE CONTRACTOR SHALL PLACE THE DREDGED MATERIAL IN A MANNER TO ALLOW DEWATERING OF THE MATERIAL.

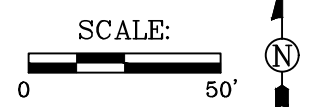

PLANTATION DRIVE SEDIMENT REMOVAL  
 CITY OF LITTLE ROCK  
 LITTLE ROCK, ARKANSAS

SHEET TITLE: FLOWAGE EASEMENT LAND AREA		NO.	DATE	BY:
REVISIONS:		NO.	DATE	DESCRIPTION
CIVIL AND ENVIRONMENTAL ENGINEERING SERVICES 3525 SOUTH SHACKERS ROAD LITTLE ROCK, AR 72206 PH: (501) 221-7122 FX: (501) 221-7775		DESIGNED BY: B.W.	PLOT DATE: 5/8/2018	JOB SCALE: 1" = 50'
DRAWN BY: J.W.F.		CHECKED BY: W.D.F.	JOB NUMBER: LITT-8957	
SHEET NO.:		4		

FILE: L:\LITTLE ROCK, CITY OF\UT-8957-PLANTATION DRIVE SEDIMENT REMOVAL\DRAWINGS\04-05 ALTERNATIVE SITE LAYOUT - SITE PLANS.DWG

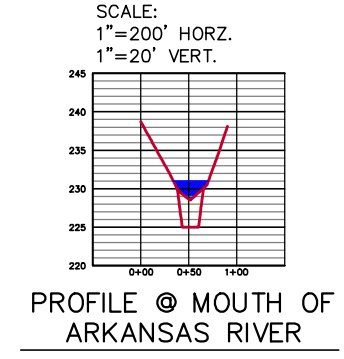
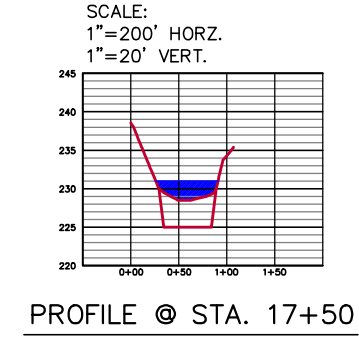
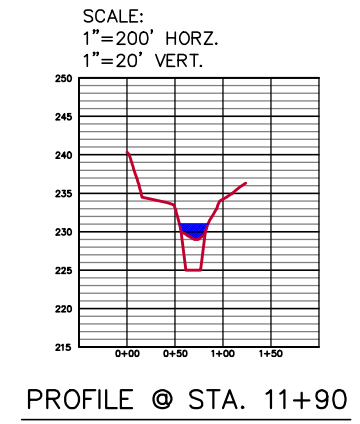
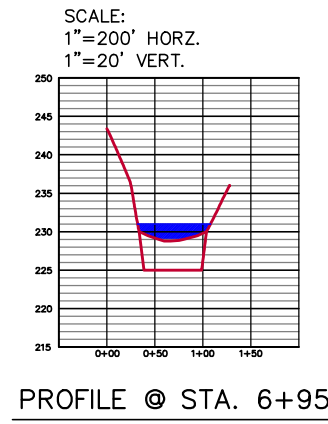
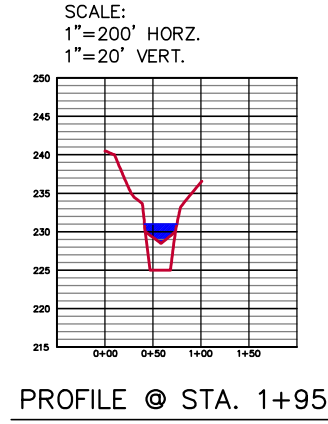
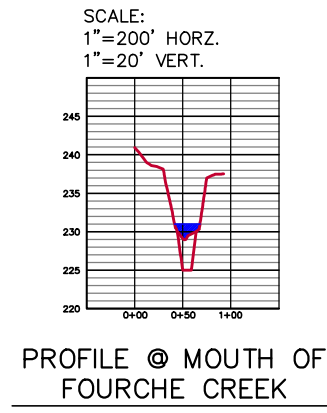
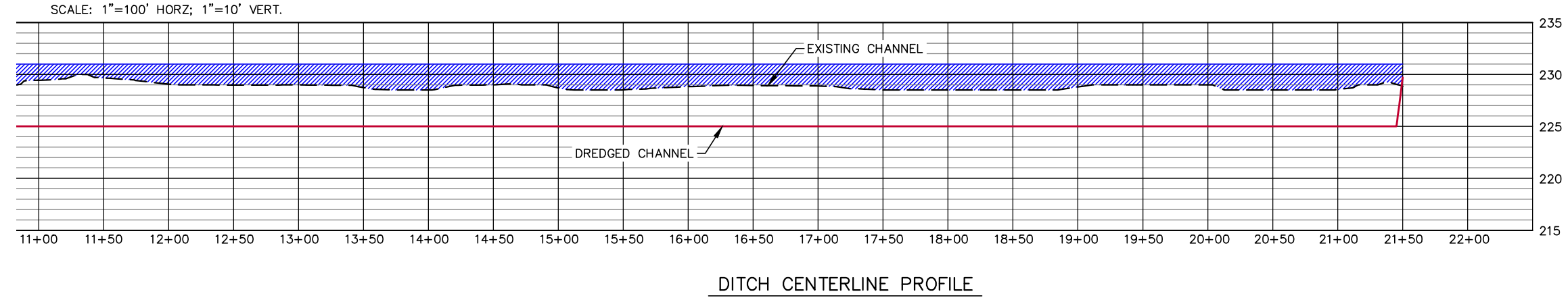
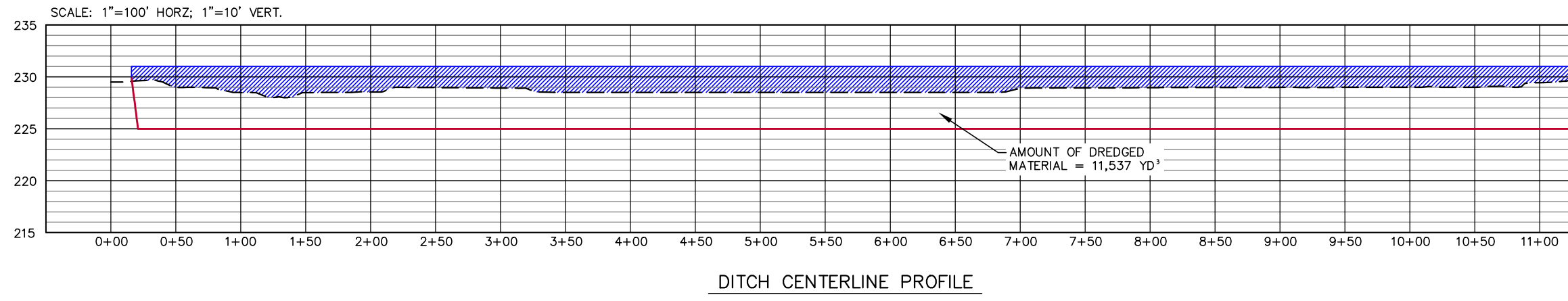

PLANTATION DRIVE SEDIMENT REMOVAL  
CITY OF LITTLE ROCK  
LITTLE ROCK, ARKANSAS

SHEET TITLE:	PROFILES
	REVISIONS:
NO.	DATE:
BY:	DESCRIPTION:
CIVIL AND ENVIRONMENTAL ENGINEERING SERVICES 3822 SOUTH SHACKERS ROAD LITTLE ROCK, AR 72206 PH: (501) 221-7122 FX: (501) 221-7775	
DESIGNED BY:	B.W. PLOT DATE: 5/8/2018
DRAWN BY:	JAB
CHECKED BY:	WDF
SCALE: AS NOTED	
JOB NUMBER: LITT-8957	
SHEET NO.:	5

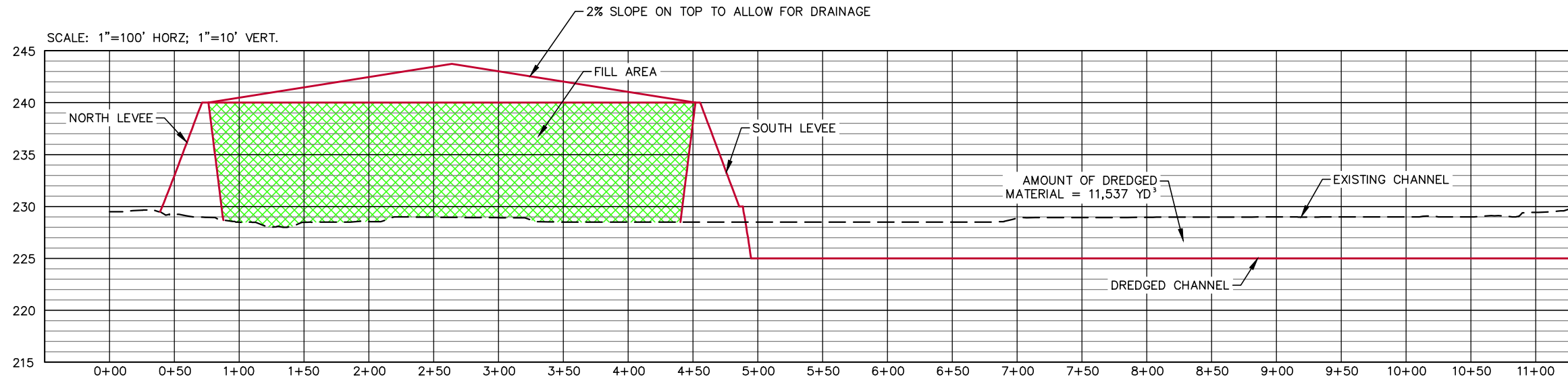

CHANNEL PROFILE WITH LEVEES

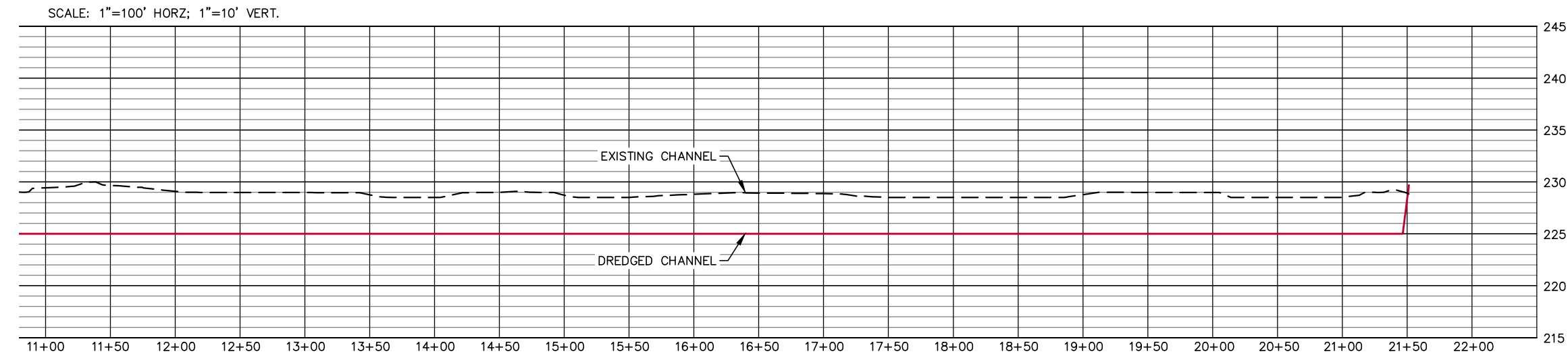

CHANNEL PROFILE WITH LEVEES

PLANTATION DRIVE SEDIMENT REMOVAL  
CITY OF LITTLE ROCK

LITTLE ROCK, ARKANSAS

SHEET TITLE:	PROFILES
	REVISIONS:
NO.	DATE:
BY:	DESCRIPTION:
DESIGNED BY:	SCALE: AS NOTED
DRAWN BY:	JOB:
CHECKED BY:	WDF
FILE: L:\LITTLE ROCK, CITY OF\UT-8957-PLANTATION DRIVE SEDIMENT REMOVAL\DRAWINGS\04-05 ALTERNATIVE SITE LAYOUT - SITE PLANS.DWG	

JOB NUMBER:  
LITT-8957

SHEET NO.: 6



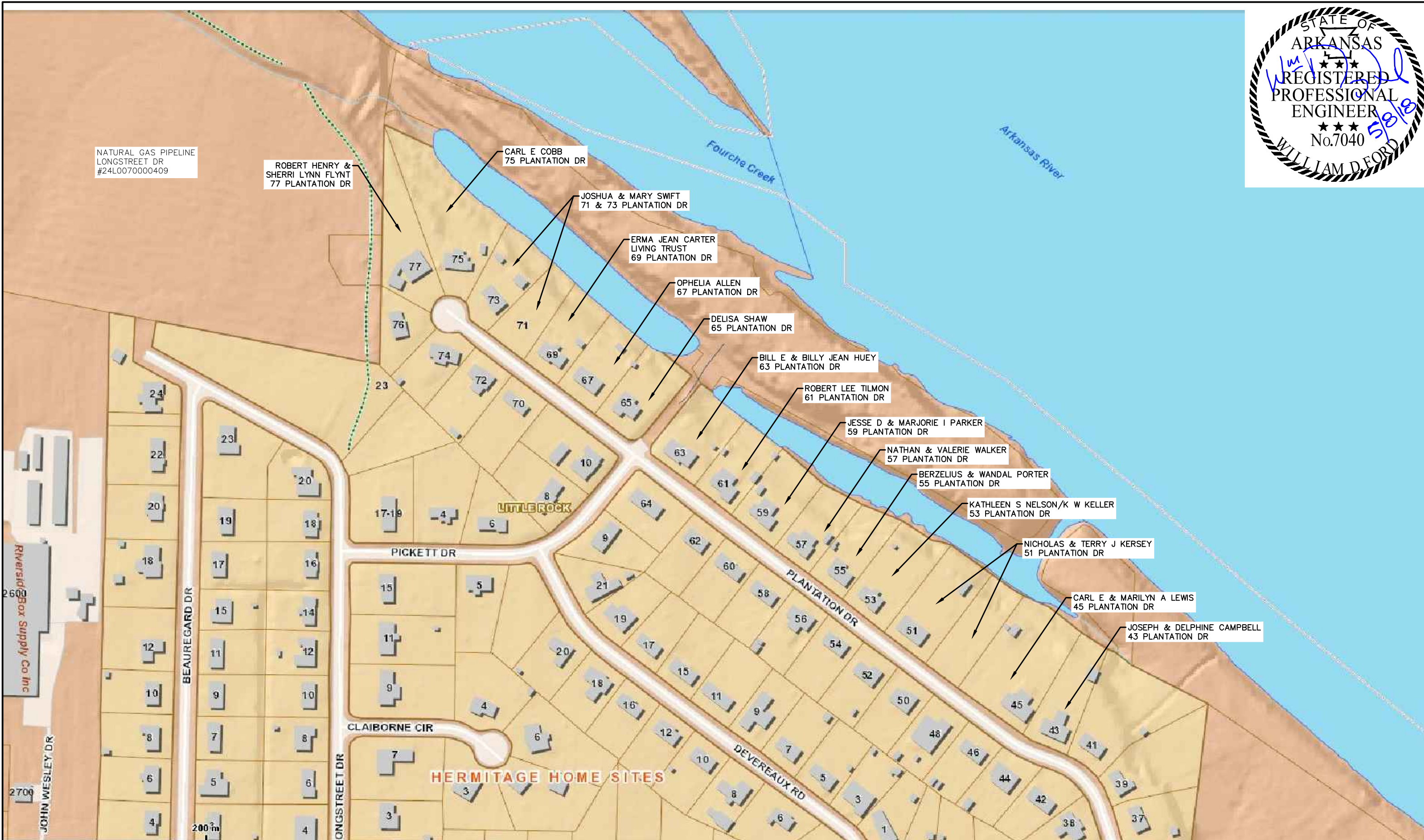

NATURAL GAS PIPELINE  
LONGSTREET DR  
#24L0070000409

ROBERT HENRY &  
SHERRI LYNN FLYNT  
77 PLANTATION DR

CARL E COBB  
75 PLANTATION DR

JOSHUA & MARY SWIFT  
71 & 73 PLANTATION DR

ERMA JEAN CARTER  
LIVING TRUST  
69 PLANTATION DR

OPHELIA ALLEN  
67 PLANTATION DR

DELISA SHAW  
65 PLANTATION DR

BILL E & BILLY JEAN HUEY  
63 PLANTATION DR

ROBERT LEE TILMON  
61 PLANTATION DR

JESSE D & MARJORIE I PARKER  
59 PLANTATION DR

NATHAN & VALERIE WALKER  
57 PLANTATION DR

BERZELIUS & WANDAL PORTER  
55 PLANTATION DR

KATHLEEN S NELSON/K W KELLER  
53 PLANTATION DR

NICHOLAS & TERRY J KERSEY  
51 PLANTATION DR

CARL E & MARILYN A LEWIS  
45 PLANTATION DR

JOSEPH & DELPHINE CAMPBELL  
43 PLANTATION DR

**CIVIL ENGINEERING AND ENVIRONMENTAL SERVICES**  
3512 South Shackleford Road  
Little Rock, Arkansas 72205  
(501) 221-7122 fax (501) 221-7775



SUBMITTED:	B. WINGFIELD
DRAWN:	J. BLACK
CHECKED:	D. FORD
DATE:	MAY 5, 2018

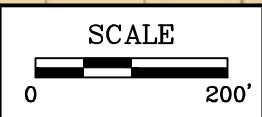
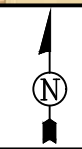

PLANTATION DRIVE SEDIMENT REMOVAL  
CITY OF LITTLE ROCK  
LITTLE ROCK, ARKANSAS

ADJACENT PROPERTY  
OWNER MAP

JOB NUMBER  
LITT-8957  
DRAWING NO.  
7



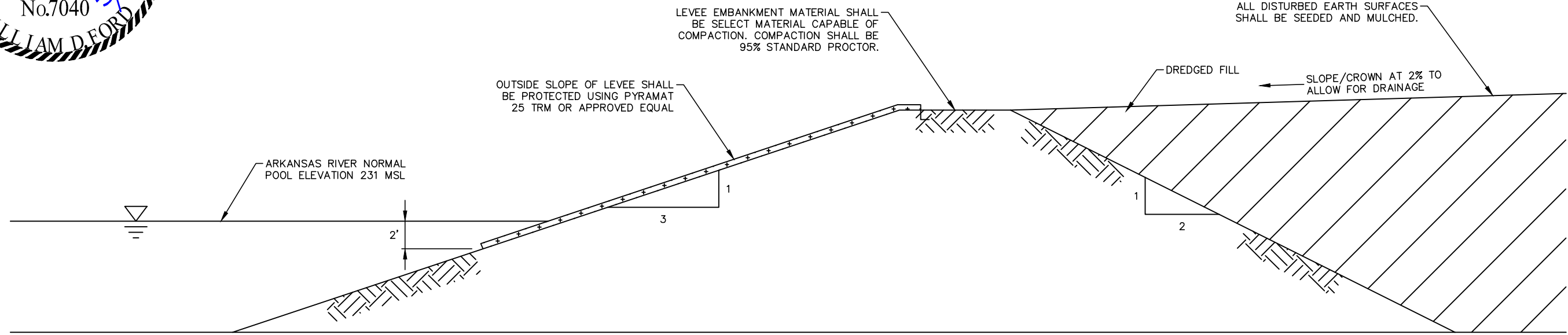

NORTH LEVEE PROFILE 1  
8  
SCALE: NTS

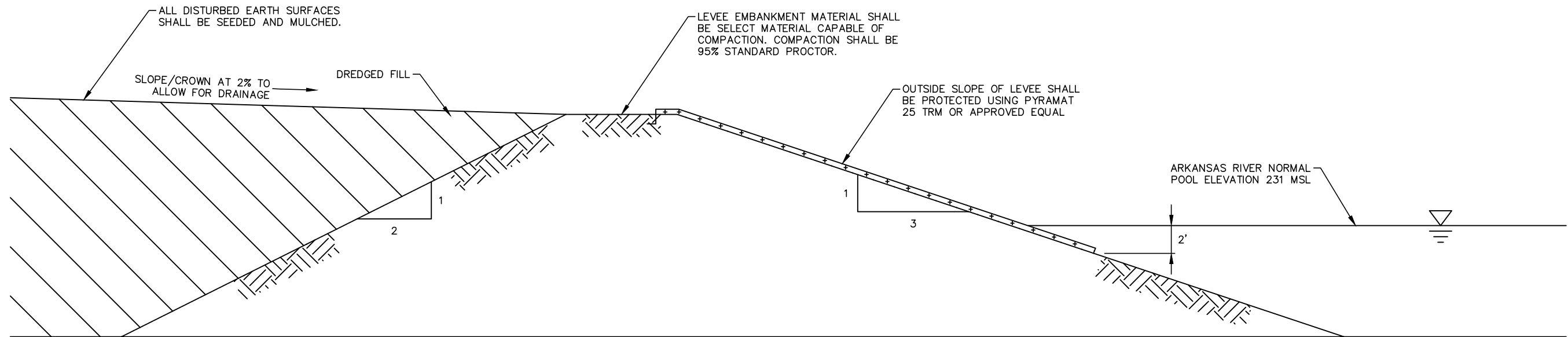

SOUTH LEVEE PROFILE 2  
8  
SCALE: NTS

PLANTATION DRIVE SEDIMENT REMOVAL  
CITY OF LITTLE ROCK

LITTLE ROCK, ARKANSAS

SHEET TITLE:		DETAILS	
NO.	DATE:	REVISIONS:	DESCRIPTION:
DESIGNED BY:	B/W	DATE:	5/8/2018
DRAWN BY:	KLL	SCALE:	AS NOTED
CHECKED BY:	WDF		
CIVIL AND ENVIRONMENTAL ENGINEERING SERVICES 5312 SOUTH SHACKERS ROAD LITTLE ROCK, AR 72206 PE: (501) 221-7122 FX: (501) 221-7775			
FILE: L:\LITTLE ROCK, CITY OF\UT-8957 PLANTATION DRIVE SEDIMENT REMOVAL\DRAWINGS\04-05 ALTERNATIVE SITE LAYOUT - SITE PLANS.DWG			
JOB NUMBER:		LITT-8957	
SHEET NO.:		8	